

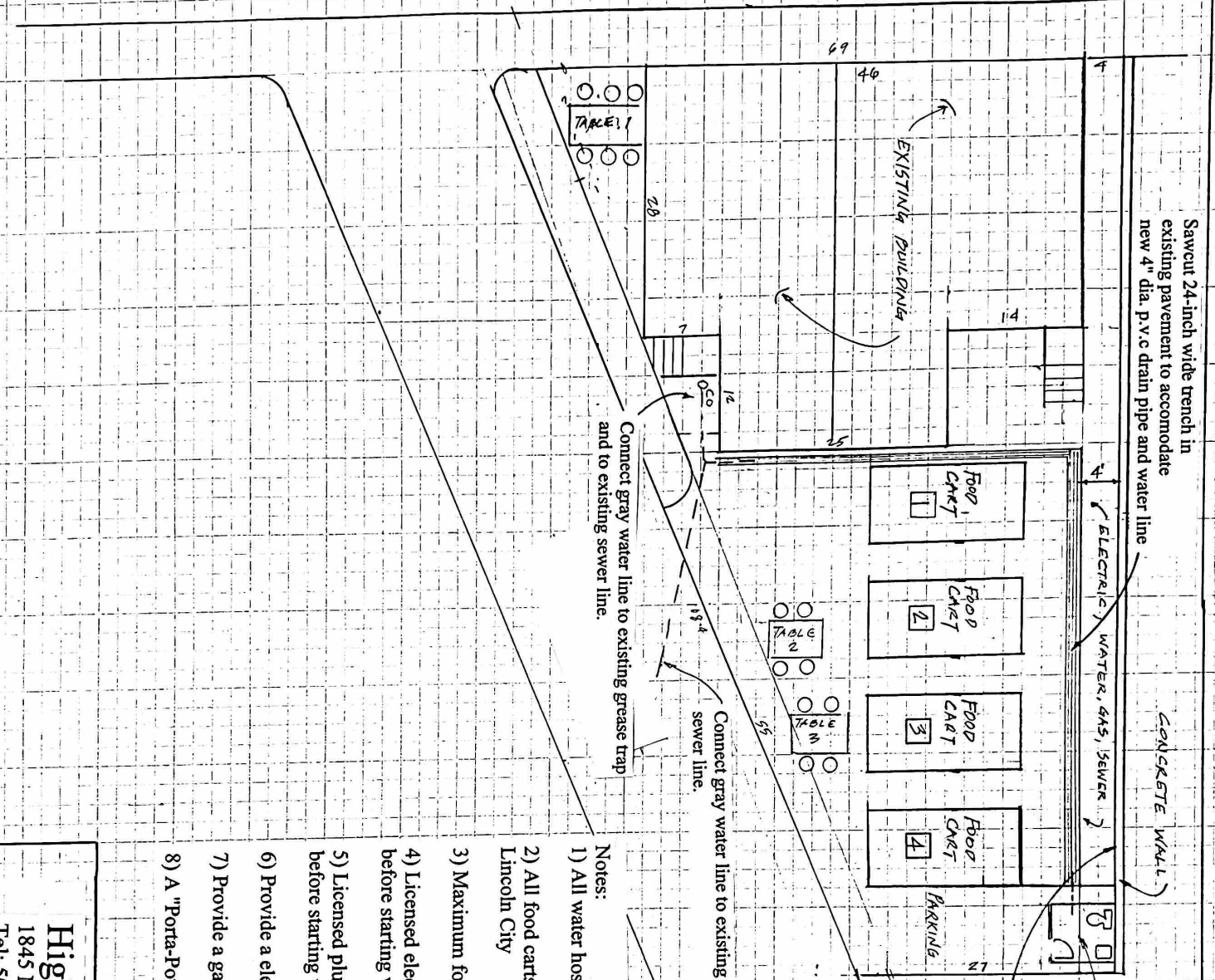

HIGHWAY 101



Sawcut 24-inch wide trench in existing pavement to accommodate new 4" dia. p.v.c drain pipe and water line

CONCRETE WALL

"PORTA-POTTY" TOILET

Fasten to concrete wall one inch diameter metal electrical conduit to provide electric power to food carts. Fasten metal natural gas line to concrete wall.

Connect gray water line to existing sewer line.

Connect gray water line to existing sewer line.

Notes:

- 1) All water hoses shall be food grade.
- 2) All food carts shall obtain licenses from the City of Lincoln City
- 3) Maximum food cart size shall be 8 feet wide x 16 ft long
- 4) Licensed electrician shall obtain a permit from the city before starting work.
- 5) Licensed plumber shall obtain a permit from the city before starting work.
- 6) Provide a electric meter for each food cart
- 7) Provide a gas meter for each food cart.
- 8) A "Porta-Potty" will be converted to connect to sewer line.

Highway 101 Food Cart Pod
 1845 NW Highway 101, Lincoln City, Oregon
 Tel: 503-381-3749