

# LINCOLN CITY SKATE PARK PARKING LOT

MARCH 2022

CITY OF LINCOLN CITY, OREGON

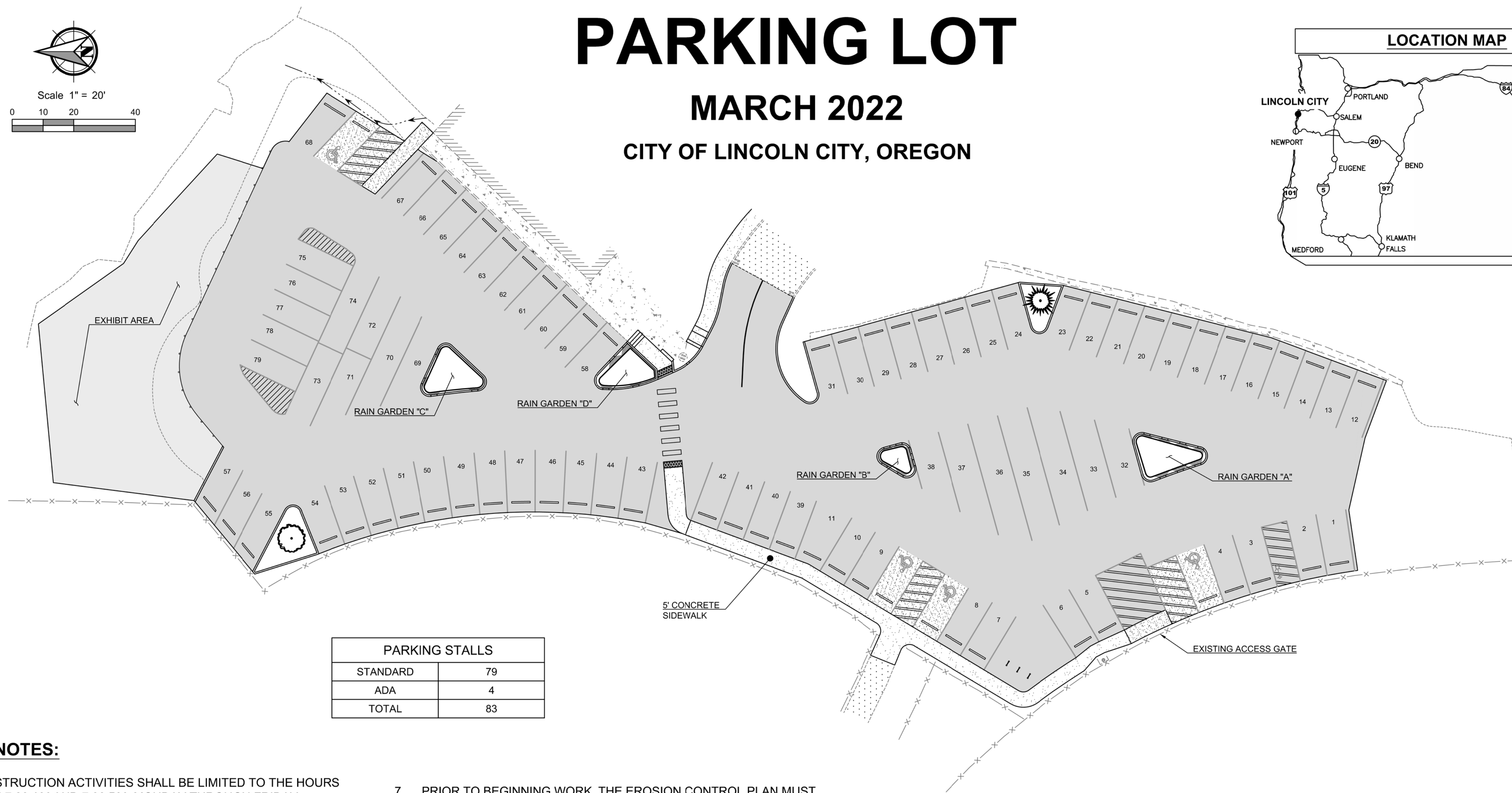
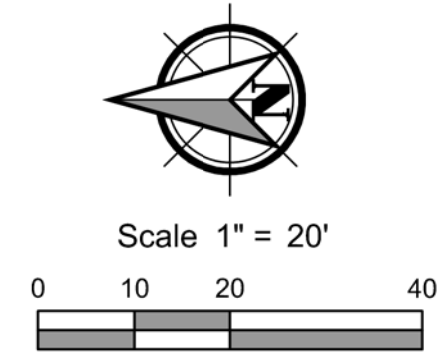

PARKING STALLS	
STANDARD	79
ADA	4
TOTAL	83

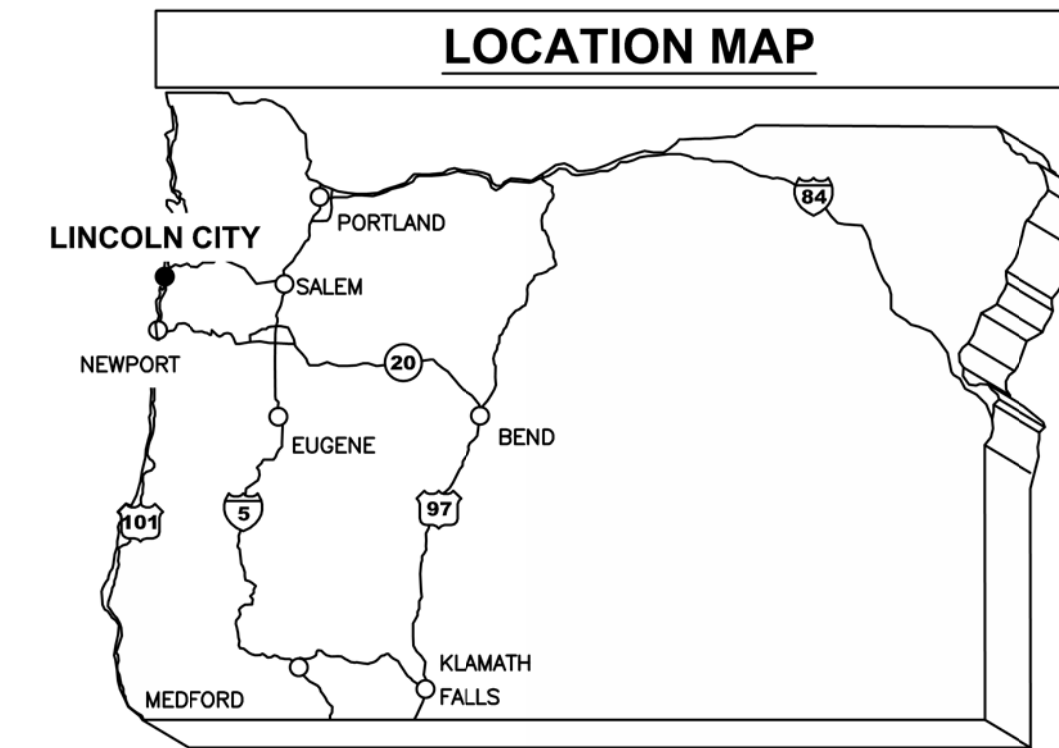

**GENERAL NOTES:**

- ALL CONSTRUCTION ACTIVITIES SHALL BE LIMITED TO THE HOURS BETWEEN 7:00 AM AND 7:00 PM, MONDAY THROUGH FRIDAY, UNLESS OTHERWISE APPROVED BY THE ENGINEER.
- CONTRACTOR SHALL PROVIDE ALL APPLICABLE PUBLIC AND PRIVATE CONSTRUCTION NOTIFICATION AS DETAILED IN THE PROJECT SPECIAL PROVISIONS.
- CONTRACTOR IS RESPONSIBLE FOR MAINTAINING A CURRENT SET OF PLANS, SPECIFICATIONS AND SPECIAL PROVISIONS ON SITE AT ALL TIMES. CONTRACTOR IS REQUIRED TO RECORD ANY CONSTRUCTION DEVIATIONS TO THESE DRAWINGS AND NOTE THE LOCATION AND ELEVATION OF ALL EXISTING UTILITIES ENCOUNTERED.
- LOCATIONS AND DESCRIPTIONS OF ALL EXISTING UTILITIES OR OTHER OBSTRUCTIONS SHOWN IN THE PROJECT PLANS ARE COMPILED FROM AVAILABLE RECORDS AN/OR FIELD SURVEYS. ACCURACY AND COMPLETENESS ARE NOT GUARANTEED; CONTRACTOR SHALL FIELD-VERIFY ALL UTILITY LOCATIONS PRIOR TO CONSTRUCTION.
- CONTRACTOR SHALL BE RESPONSIBLE FOR ANY DAMAGE THAT OCCURS TO ASPHALT PAVEMENT, CONCRETE PAVEMENT, CONCRETE STRUCTURES, BUILDINGS, VALVE AND/OR METER BOXES, SIGNS, ETC. DUE TO CONSTRUCTION ACTIVITIES.
- NO OPEN EXCAVATION TO BE LEFT DURING CONSTRUCTION OFF HOURS. ALL OPEN CUTS OF EXISTING STREETS AND DRIVEWAYS TO BE BACKFILLED TO GRADE, PATCHED WITH A HOT OR COLD AC MIX, OR COVERED WITH A STEEL PLATE.
- PRIOR TO BEGINNING WORK, THE EROSION CONTROL PLAN MUST BE APPROVED BY THE CITY. EFFECTIVE EROSION CONTROL IS REQUIRED. EROSION CONTROL DEVICES MUST BE INSTALLED AND MAINTAINED MEETING CITY AND D.E.Q. REQUIREMENTS.
- THE ADJUSTMENT OF ALL EXISTING APPURTENANCES SHALL BE CONSIDERED INCIDENTAL IF NOT LISTED IN THE BID SCHEDULE.
- RESTORATION SHALL BE COMPLETED TO ALL PROPERTIES AFFECTED BY CONSTRUCTION ACTIVITIES AND SHALL BE CONSIDERED INCIDENTAL TO THIS PROJECT.
- CONTRACTOR IS RESPONSIBLE FOR PROTECTING ALL EXISTING SURVEY MONUMENTATION. MONUMENTS DISTURBED OR DESTROYED BY CONSTRUCTION ACTIVITIES SHALL BE RESET AT NO COST TO THE CITY BY A PROFESSIONAL LAND SURVEYOR CURRENTLY REGISTERED IN THE STATE OF OREGON.
- PROJECT CONTROL POINTS ESTABLISHED WITH NAVD 88.

Sheet List Table		
Sheet Number	Sheet ID	Sheet Title
1	C-001	COVER SHEET
2	C-002	GENERAL NOTES & LEGEND
3	C-101	EXISTING CONDITIONS AND DEMOLITION PLAN
4	C-201	GRADING & EROSION CONTROL PLAN
5	C-202	GRADING & EROSION CONTROL PLAN
6	C-301	SITE PLAN
7	C-302	SITE PLAN
8	C-401	RAIN GARDEN PLAN & SECTION
9	C-402	RAIN GARDEN PLAN & SECTION
10	C-403	SIDEWALK & ADA PARKING DETAIL
11	C-404	ADA PARKING DETAIL
12	C-405	DETAILS
13	C-406	DETAILS
14	C-407	DETAILS
15	C-408	DETAILS



PROJECT SITE

VICINITY MAP

**General Notes**  
**OWNER:** LINCOLN CITY  
 CITY OF LINCOLN CITY  
 801 SW HIGHWAY 101  
 PO BOX 50  
 LINCOLN CITY, OREGON 97367  
**CONTACT:** TERRY CHAMBERLIN, P.E.  
 PHONE: 541.996.1292  
**CALL BEFORE YOU DIG!**  
 1-800-332-2344  
**ATTENTION:**  
 OREGON LAW REQUIRES YOU TO FOLLOW RULES ADOPTED BY THE OREGON UTILITY NOTIFICATION CENTER. THESE RULES ARE SET FORTH IN OAR 800.000 THROUGH OAR 800.009. YOU MAY OBTAIN COPIES OF THE RULES BY CALLING THE CENTER. NOTE: THE TELEPHONE NUMBER FOR THE OREGON UTILITY NOTIFICATION CENTER IS (503) 322-1801.



No.	Revision/Issue	Date

LINCOLN CITY PUBLIC WORKS  
 801 S.W. HWY 101  
 P.O. BOX 50  
 LINCOLN CITY, OREGON 97367  
 PHONE: (541) 996-2154  
 FAX: (541) 994-4881  
 www.lincolncity.org

Project Name and Sheet Name  
**LINCOLN CITY SKATE PARK  
 PARKING LOT**  
 COVER SHEET  
 C-001  
 DESIGNED BY: TC  
 PREPARED BY: PBS

Project No. 74252.000	Sheet No. <b>1</b> OF 15
Date 3/15/2022	Scale AS NOTED <small>IF LESS THAN FULL SIZE, NTS</small>

# 74252.000 LINCOLN CITY SKATE PARK PARKING LOT

## CONSTRUCTION NOTES

1. ASPHALT DRIVEWAY TRANSITION - CONTRACTOR SHALL GRIND THE TRANSITION WHERE THE NEW ASPHALT DRIVEWAY MEETS THE EXISTING ASPHALT.

PROPOSED LINETYPE LEGEND	
Proposed Storm Pipe	
Proposed Centerline	
Proposed Contour	
Proposed Curb & Gutter	
Proposed Easement	
Proposed End of Pavement	
Proposed Erosion Control Filter Fabric Fence	
Proposed Fence	
Proposed Flow Line	
Proposed Paint Stripe	
Proposed Sawcut Line	
Proposed Score Line	
Proposed Sidewalk	

EXISTING LINETYPE LEGEND	
Existing Storm Sewer Pipe	
Existing Building	
Existing Contour	
Existing Curb	
Existing Fence	
Existing Flow Line	
Existing Gravel Road	
Existing Wall	

HATCHING LEGEND	
Existing Pavement	
Existing Concrete	
Proposed 3" Pavement	
Proposed 2" Pavement	
Proposed 6" Concrete	
Proposed 4" Concrete	

EXISTING SYMBOL LEGEND	
Existing Catch Basin	
Existing Flow Arrow	
Existing Street Light	

PROPOSED SYMBOL LEGEND	
Proposed Catch Basin	
Proposed Area Drain	
Proposed Combination Curb Inlet	
Proposed Bollard	
Proposed Street Light	
Proposed Flow Arrow	
Proposed Inlet Protection Pillow	
Proposed Gravel Construction Entrance	
Proposed Tree - Boulevard Cypress	
Proposed Tree - Japanese Maple	

## General Notes

OWNER: LINCOLN CITY  
 CITY OF LINCOLN CITY  
 801 SW HIGHWAY 101  
 PO BOX 50  
 LINCOLN CITY, OREGON 97367  
 CONTACT: TERRY CHAMBERLIN, P.E.  
 PHONE: 541.996.1292



No.	Revision/Issue	Date

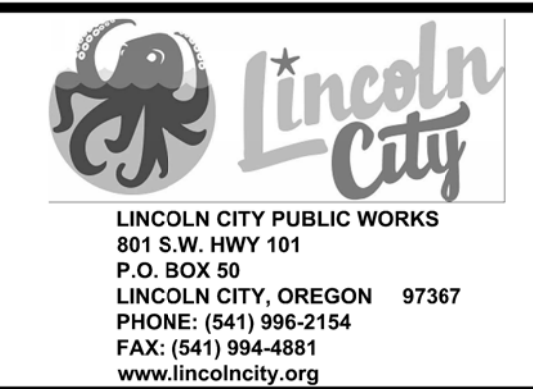

Project Name and Sheet Name  
 LINCOLN CITY SKATE PARK  
 PARKING LOT  
 GENERAL NOTES & LEGEND  
 C-002  
 DESIGNED BY: TC  
 PREPARED BY: PBS

Project No.: 74252.000	Sheet No. 2 OF 15
Date 3/1/2022	
Scale AS NOTED IF LESS THAN FULL SIZE, NTS	

# 74252.000 LINCOLN CITY SKATE PARK PARKING LOT

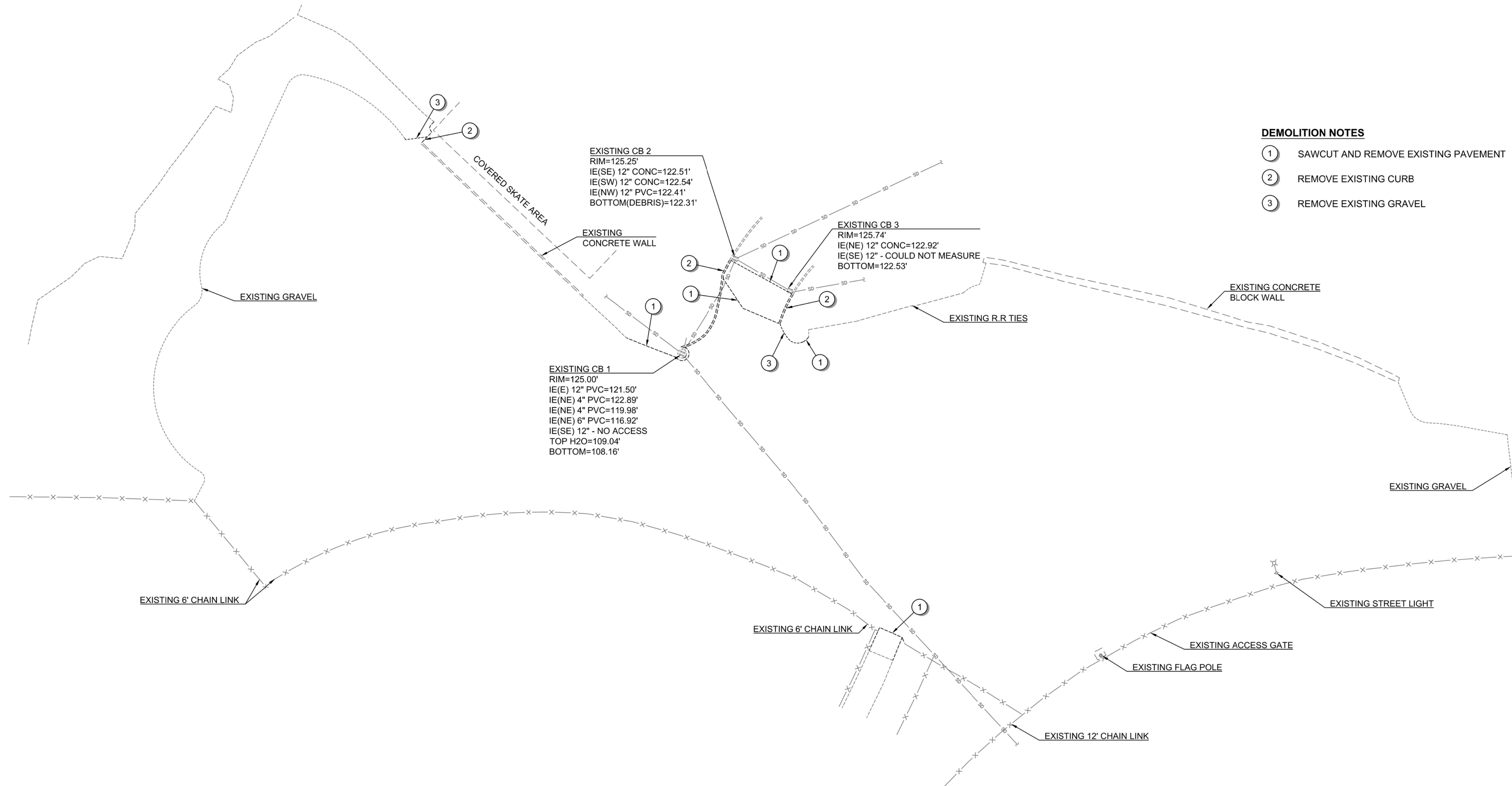
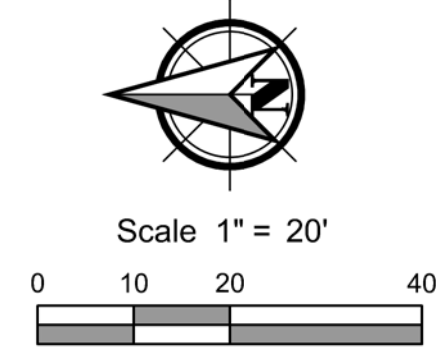

- DEMOLITION NOTES**
- ① SAWCUT AND REMOVE EXISTING PAVEMENT
  - ② REMOVE EXISTING CURB
  - ③ REMOVE EXISTING GRAVEL

EXISTING CB 2  
 RIM=125.25'  
 IE(SE) 12" CONC=122.51'  
 IE(SW) 12" CONC=122.54'  
 IE(NW) 12" PVC=122.41'  
 BOTTOM(DEBRIS)=122.31'

EXISTING CB 3  
 RIM=125.74'  
 IE(NE) 12" CONC=122.92'  
 IE(SE) 12" - COULD NOT MEASURE  
 BOTTOM=122.53'

EXISTING CB 1  
 RIM=125.00'  
 IE(E) 12" PVC=121.50'  
 IE(NE) 4" PVC=122.89'  
 IE(NE) 4" PVC=119.98'  
 IE(NE) 6" PVC=116.92'  
 IE(SE) 12" - NO ACCESS  
 TOP H2O=109.04'  
 BOTTOM=108.16'

**General Notes**

OWNER: LINCOLN CITY  
 CITY OF LINCOLN CITY  
 801 SW HIGHWAY 101  
 PO BOX 50  
 LINCOLN CITY, OREGON 97367

CONTACT: TERRY CHAMBERLIN, P.E.  
 PHONE: 541.996.1292

No.	Revision/Issue	Date

LINCOLN CITY PUBLIC WORKS  
 801 S.W. HWY 101  
 P.O. BOX 50  
 LINCOLN CITY, OREGON 97367  
 PHONE: (541) 996-2154  
 FAX: (541) 994-4881  
 www.lincolncity.org

Project Name and Sheet Name  
 LINCOLN CITY SKATE PARK  
 PARKING LOT  
 EXISTING CONDITIONS AND  
 DEMOLITION PLAN  
 C-101

DESIGNED BY: TC  
 PREPARED BY: PBS

Project No.: 74252.000	Sheet No.
Date: 3/8/2022	<b>3 OF 15</b>
Scale: AS NOTED <small>IF LESS THAN FULL SIZE, NTS</small>	

# 74252.000 LINCOLN CITY SKATE PARK PARKING LOT

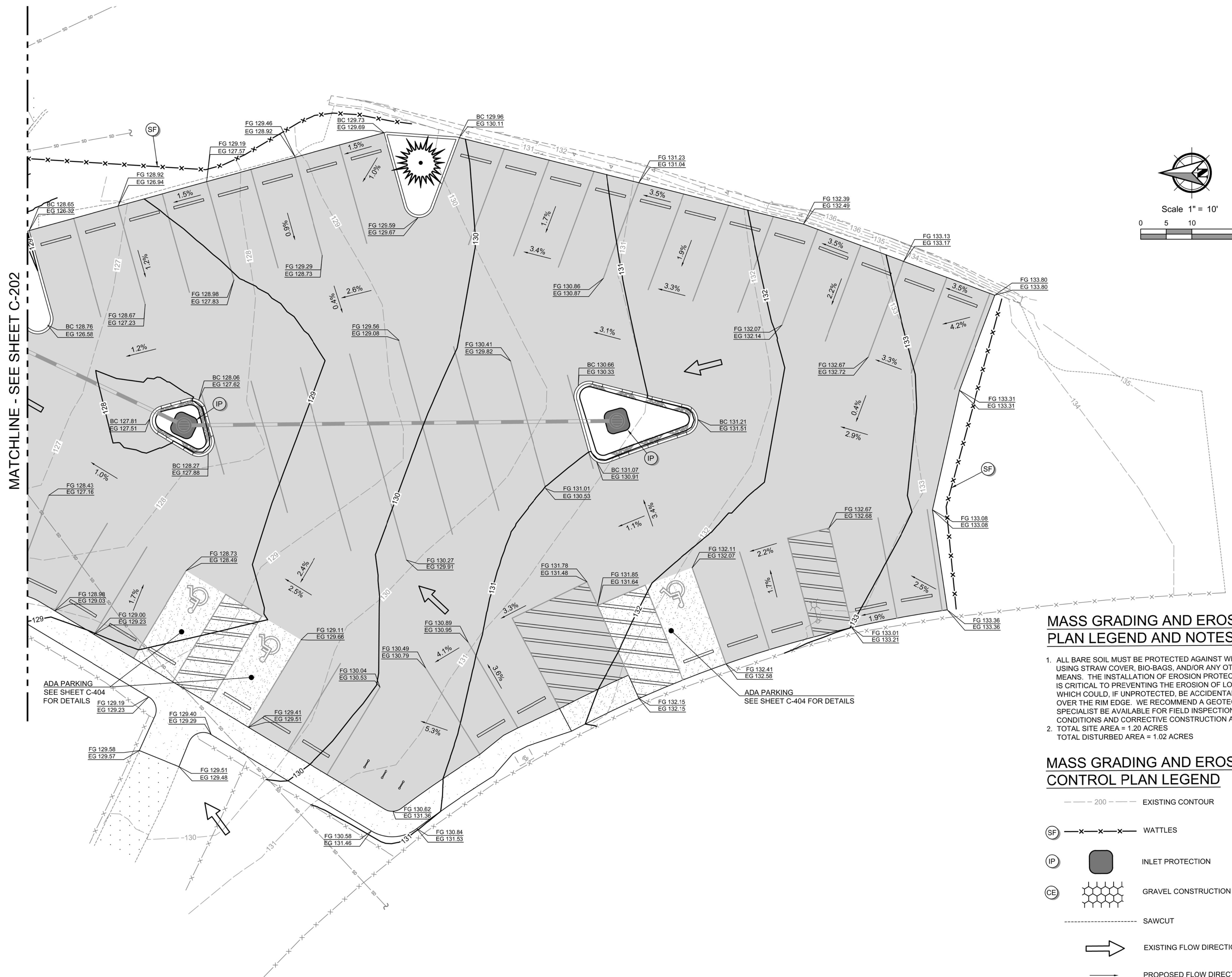

MATCHLINE - SEE SHEET C-202

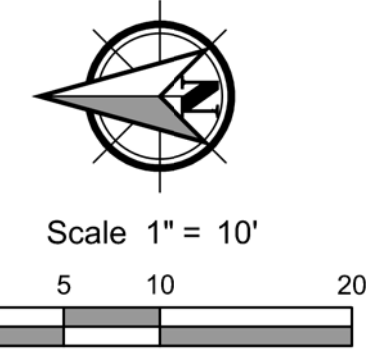

## MASS GRADING AND EROSION CONTROL PLAN LEGEND AND NOTES

- ALL BARE SOIL MUST BE PROTECTED AGAINST WET WEATHER USING STRAW COVER, BIO-BAGS, AND/OR ANY OTHER RELEVANT MEANS. THE INSTALLATION OF EROSION PROTECTION MATERIALS IS CRITICAL TO PREVENTING THE EROSION OF LOOSE SOILS, WHICH COULD, IF UNPROTECTED, BE ACCIDENTALLY WASHED OVER THE RIM EDGE. WE RECOMMEND A GEOTECHNICAL SPECIALIST BE AVAILABLE FOR FIELD INSPECTION OF SUCH CONDITIONS AND CORRECTIVE CONSTRUCTION ACTIVITIES.
- TOTAL SITE AREA = 1.20 ACRES  
TOTAL DISTURBED AREA = 1.02 ACRES

## MASS GRADING AND EROSION CONTROL PLAN LEGEND

- 200 EXISTING CONTOUR
- WATTLES
- INLET PROTECTION
- GRAVEL CONSTRUCTION ENTERANCE
- SAWCUT
- EXISTING FLOW DIRECTION ARROW
- PROPOSED FLOW DIRECTION AND SLOPE ARROW
- FG = FINISHED GRADE
- BC = BOTTOM CURB
- EG = EXISTING GRADE

**General Notes**  
 OWNER: LINCOLN CITY  
 CITY OF LINCOLN CITY  
 801 SW HIGHWAY 101  
 PO BOX 50  
 LINCOLN CITY, OREGON 97367  
 CONTACT: TERRY CHAMBERLIN, P.E.  
 PHONE: 541.996.1292

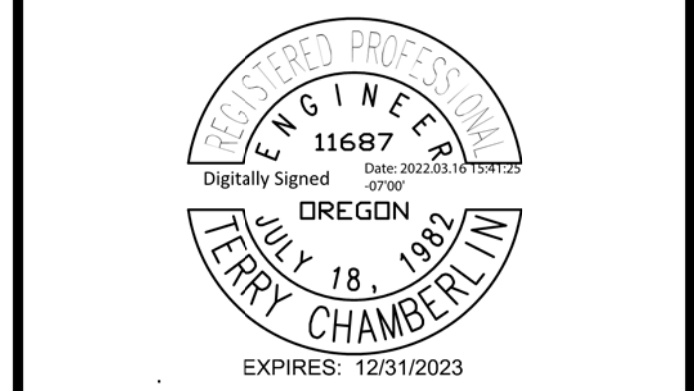

No.	Revision/Issue	Date

LINCOLN CITY PUBLIC WORKS  
 801 S.W. HWY 101  
 P.O. BOX 50  
 LINCOLN CITY, OREGON 97367  
 PHONE: (541) 996-2154  
 FAX: (541) 994-4881  
 www.lincolncity.org

Project Name and Sheet Name  
**LINCOLN CITY SKATE PARK  
 PARKING LOT  
 GRADING & EROSION  
 CONTROL PLAN  
 C-201**  
 DESIGNED BY: TC  
 PREPARED BY: PBS

Project No. 74252.000	Sheet No.
Date 3/14/2022	<b>4 OF 15</b>
Scale AS NOTED <small>IF LESS THAN FULL SIZE, NTS</small>	

# 74252.000 LINCOLN CITY SKATE PARK PARKING LOT

## MASS GRADING AND EROSION CONTROL PLAN LEGEND AND NOTES

- ALL BARE SOIL MUST BE PROTECTED AGAINST WET WEATHER USING STRAW COVER, BIO-BAGS, AND/OR ANY OTHER RELEVANT MEANS. THE INSTALLATION OF EROSION PROTECTION MATERIALS IS CRITICAL TO PREVENTING THE EROSION OF LOOSE SOILS, WHICH COULD, IF UNPROTECTED, BE ACCIDENTALLY WASHED OVER THE RIM EDGE. WE RECOMMEND A GEOTECHNICAL SPECIALIST BE AVAILABLE FOR FIELD INSPECTION OF SUCH CONDITIONS AND CORRECTIVE CONSTRUCTION ACTIVITIES.
- TOTAL SITE AREA = 1.20 ACRES  
TOTAL DISTURBED AREA = 1.02 ACRES

## MASS GRADING AND EROSION CONTROL PLAN LEGEND

- 200 --- EXISTING CONTOUR
- (SF) --- WATTLES
- (IP) --- INLET PROTECTION
- (CE) --- GRAVEL CONSTRUCTION ENTRANCE
- SAWCUT
- EXISTING FLOW DIRECTION ARROW
- PROPOSED FLOW DIRECTION AND SLOPE ARROW
- FG = FINISHED GRADE
- BC = BOTTOM CURB
- EG = EXISTING GRADE

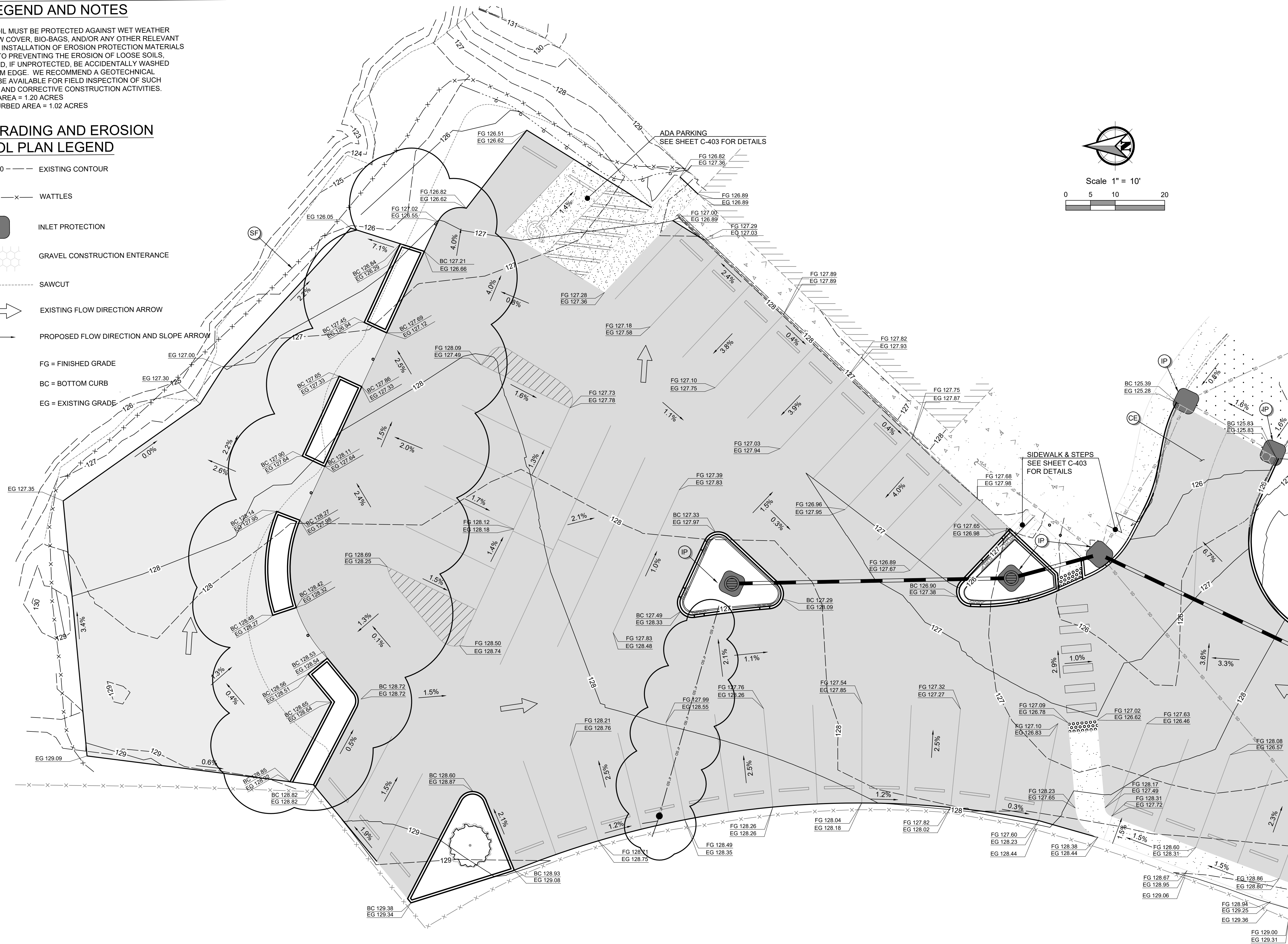

MATCHLINE - SEE SHEET C-201

**General Notes**  
 OWNER: LINCOLN CITY  
 CITY OF LINCOLN CITY  
 801 SW HIGHWAY 101  
 P.O. BOX 50  
 LINCOLN CITY, OREGON 97367  
 CONTACT: TERRY CHAMBERLIN, P.E.  
 PHONE: 541.996.1292

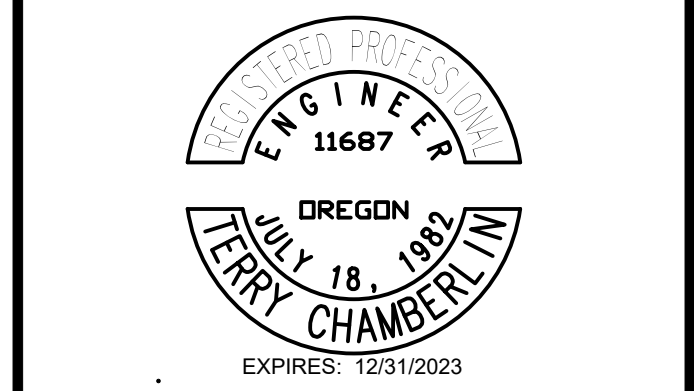

No.	Revision/Issue	Date

LINCOLN CITY PUBLIC WORKS  
 801 S.W. HWY 101  
 P.O. BOX 50  
 LINCOLN CITY, OREGON 97367  
 PHONE: (541) 996-2154  
 FAX: (541) 994-4881  
 www.lincolncity.org

Project Name and Sheet Name  
**LINCOLN CITY SKATE PARK  
 PARKING LOT  
 GRADING & EROSION  
 CONTROL PLAN  
 C-202**  
 DESIGNED BY: TC  
 PREPARED BY: PBS

Project No.: <b>74252.000</b>	Sheet No.:
Date: <b>5/20/2022</b>	<b>5</b> OF <b>15</b>
Scale: <b>AS NOTED</b> <small>IF LESS THAN FULL SIZE, NTS</small>	

# 74252.000 LINCOLN CITY SKATE PARK PARKING LOT

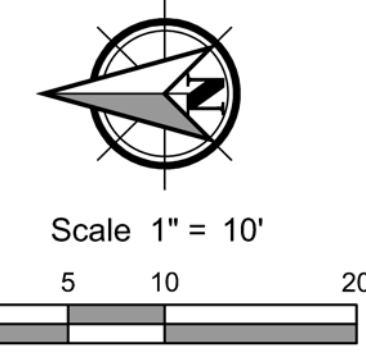
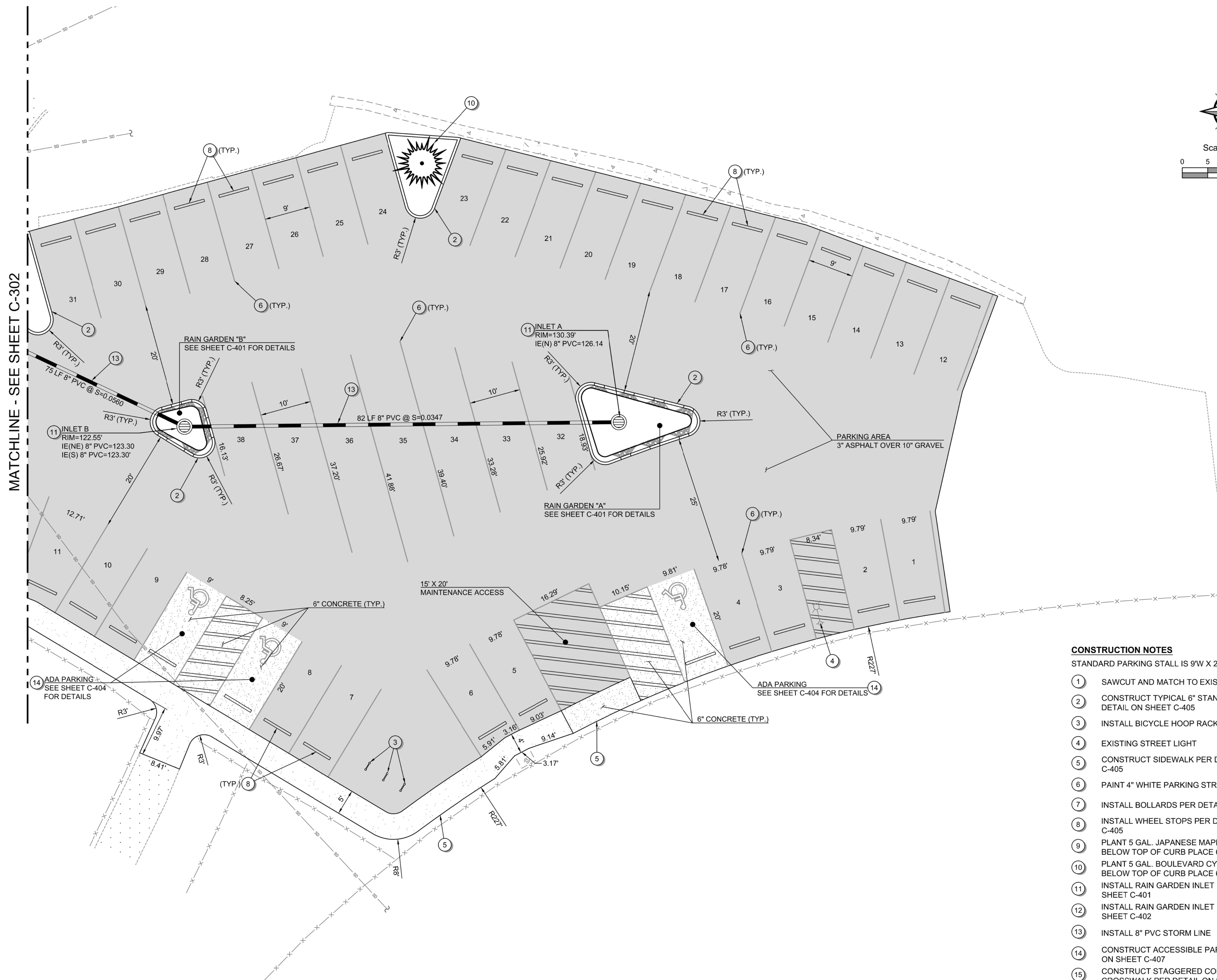

MATCHLINE - SEE SHEET C-302

- CONSTRUCTION NOTES**
- STANDARD PARKING STALL IS 9'W X 20'L UNLESS NOTED.
- 1 SAWCUT AND MATCH TO EXISTING PAVEMENT
  - 2 CONSTRUCT TYPICAL 6" STANDARD CURB PER DETAIL ON SHEET C-405
  - 3 INSTALL BICYCLE HOOP RACK
  - 4 EXISTING STREET LIGHT
  - 5 CONSTRUCT SIDEWALK PER DETAIL ON SHEET C-405
  - 6 PAINT 4" WHITE PARKING STRIPING
  - 7 INSTALL BOLLARDS PER DETAIL ON SHEET C-405
  - 8 INSTALL WHEEL STOPS PER DETAIL ON SHEET C-405
  - 9 PLANT 5 GAL. JAPANESE MAPLE TREE EXCAVATE 2' BELOW TOP OF CURB PLACE 6" RIVER ROCK
  - 10 PLANT 5 GAL. BOULEVARD CYPRESS EXCAVATE 2' BELOW TOP OF CURB PLACE 6" RIVER ROCK
  - 11 INSTALL RAIN GARDEN INLET PER DETAIL ON SHEET C-401
  - 12 INSTALL RAIN GARDEN INLET PER DETAIL ON SHEET C-402
  - 13 INSTALL 8" PVC STORM LINE
  - 14 CONSTRUCT ACCESSIBLE PARKING PER DETAIL ON SHEET C-407
  - 15 CONSTRUCT STAGGERED CONTINENTAL CROSSWALK PER DETAIL ON SHEET C-406
  - 16 CONSTRUCT ADA RAMP WITH DETECTABLE WARNING PER DETAIL ON SHEET C-406
  - 17 EXISTING GRATE TO REMAIN AND BE PROTECTED
  - 18 FIELD DESIGN SIDEWALK AND CONNECT TO EXISTING SIDEWALK

**General Notes**

OWNER: LINCOLN CITY  
 CITY OF LINCOLN CITY  
 801 SW HIGHWAY 101  
 PO BOX 50  
 LINCOLN CITY, OREGON 97367

CONTACT: TERRY CHAMBERLIN, P.E.  
 PHONE: 541.996.1292

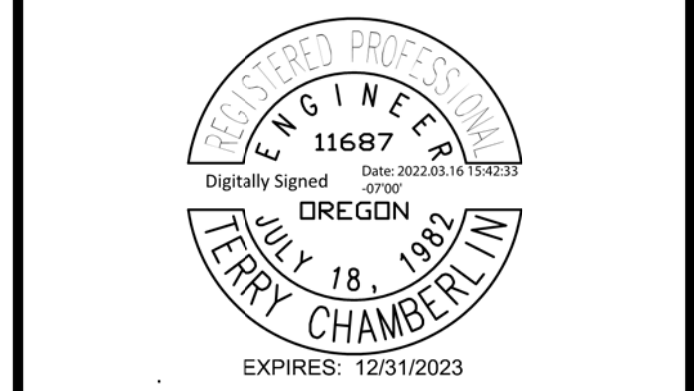

No.	Revision/Issue	Date

LINCOLN CITY PUBLIC WORKS  
 801 S.W. HWY 101  
 P.O. BOX 50  
 LINCOLN CITY, OREGON 97367  
 PHONE: (541) 996-2154  
 FAX: (541) 994-4881  
 www.lincolncity.org

Project Name and Sheet Name  
**LINCOLN CITY SKATE PARK  
 PARKING LOT**

SITE PLAN  
 C-301

DESIGNED BY: TC  
 PREPARED BY: PBS

Project No.: 74252.000	Sheet No.:
Date: 3/14/2022	6 OF 15
Scale: AS NOTED <small>IF LESS THAN FULL SIZE, NTS</small>	

# 74252.000 LINCOLN CITY SKATE PARK PARKING LOT

## CONSTRUCTION NOTES

STANDARD PARKING STALL IS 9'W X 20'L UNLESS NOTED.

- 1 SAWCUT AND MATCH TO EXISTING PAVEMENT
- 2 CONSTRUCT TYPICAL 6" STANDARD CURB PER DETAIL ON SHEET C-405
- 3 INSTALL BICYCLE HOOP RACK
- 4 EXISTING STREET LIGHT
- 5 CONSTRUCT SIDEWALK PER DETAIL ON SHEET C-405
- 6 PAINT 4" WHITE PARKING STRIPING
- 7 INSTALL BOLLARDS PER DETAIL ON SHEET C-405
- 8 INSTALL WHEEL STOPS PER DETAIL ON SHEET C-405
- 9 PLANT 5 GAL. JAPANESE MAPLE TREE EXCAVATE 2' BELOW TOP OF CURB PLACE 6" RIVER ROCK
- 10 PLANT 5 GAL. BOULEVARD CYPRESS EXCAVATE 2' BELOW TOP OF CURB PLACE 6" RIVER ROCK
- 11 INSTALL RAIN GARDEN INLET PER DETAIL ON SHEET C-401
- 12 INSTALL RAIN GARDEN INLET PER DETAIL ON SHEET C-402
- 13 INSTALL 8" PVC STORM LINE
- 14 CONSTRUCT ACCESSIBLE PARKING PER DETAIL ON SHEET C-407
- 15 CONSTRUCT STAGGERED CONTINENTAL CROSSWALK PER DETAIL ON SHEET C-406
- 16 CONSTRUCT ADA RAMP WITH DETECTABLE WARNING PER DETAIL ON SHEET C-406
- 17 EXISTING GRATE TO REMAIN AND BE PROTECTED
- 18 FIELD DESIGN SIDEWALK AND CONNECT TO EXISTING SIDEWALK
- 19 INSTALL NEW 4" SOLID WALL DRAIN PIPE FROM EXISTING FIELD 2 & 3 DRAINAGE TO RAIN GARDEN. CONNECT INTO TWO (2) 4" CORRUGATED PIPES WITH TEE. INSTALL CLEANOUT & CAST IRON LID.

EXHIBIT AREA  
2" ASPHALT OVER 6" GRAVEL

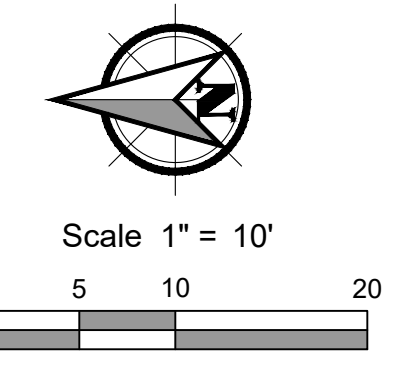
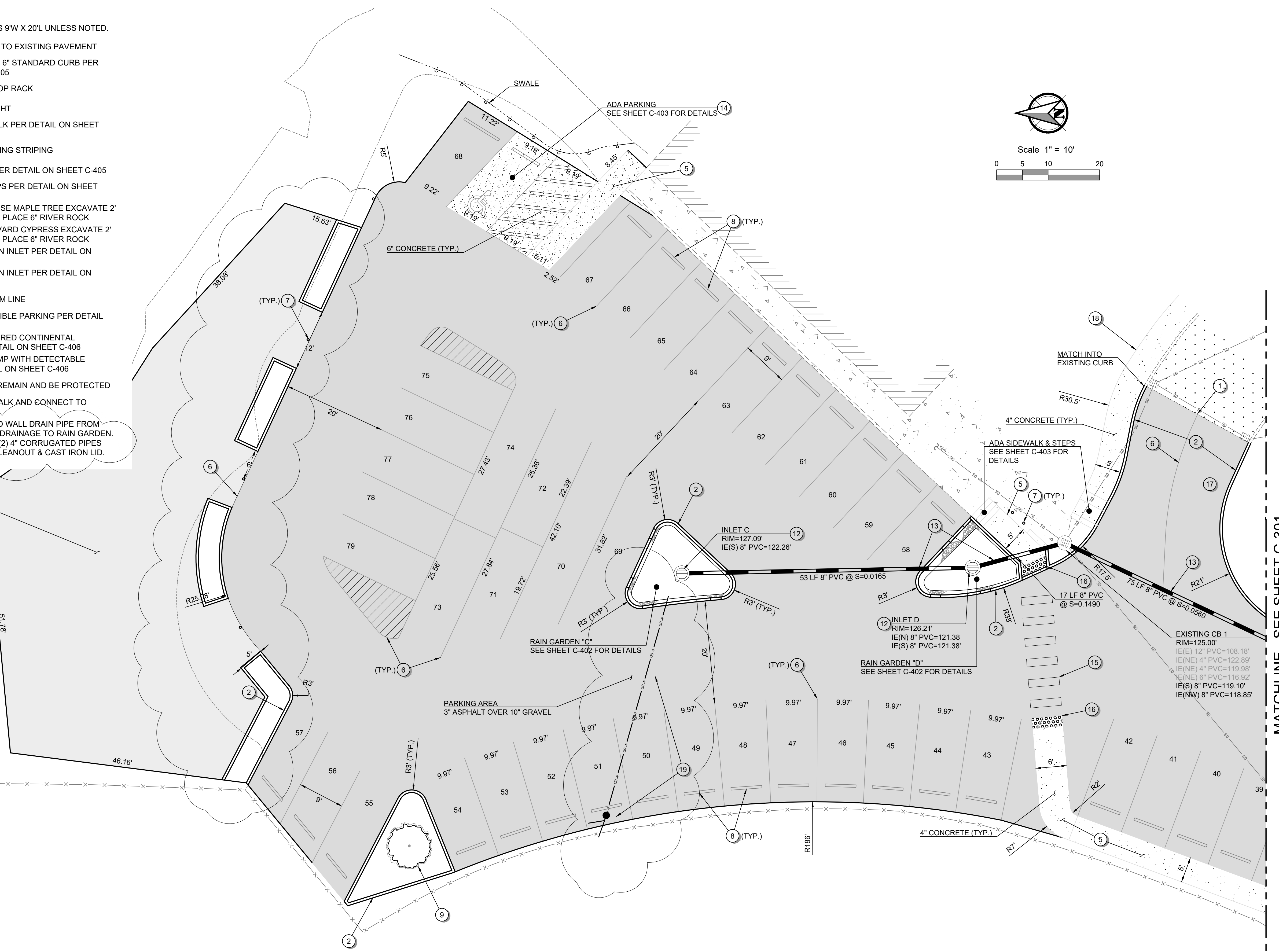

**General Notes**  
 OWNER: LINCOLN CITY  
 CITY OF LINCOLN CITY  
 801 SW HIGHWAY 101  
 PO BOX 50  
 LINCOLN CITY, OREGON 97367  
 CONTACT: TERRY CHAMBERLIN, P.E.  
 PHONE: 541.996.1292

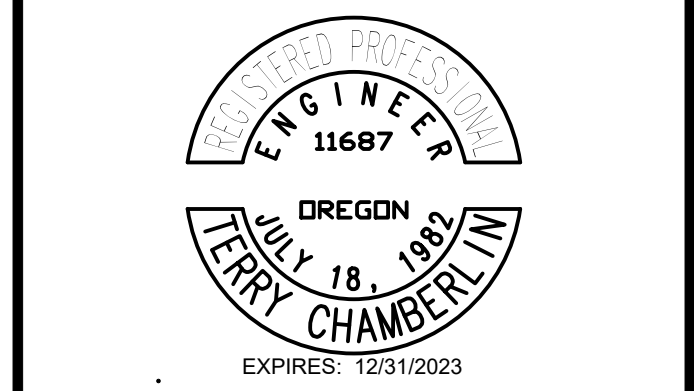

No.	Revision/Issue	Date

LINCOLN CITY PUBLIC WORKS  
 801 S.W. HWY 101  
 P.O. BOX 50  
 LINCOLN CITY, OREGON 97367  
 PHONE: (541) 996-2154  
 FAX: (541) 994-4881  
 www.lincolncity.org

Project Name and Sheet Name  
**LINCOLN CITY SKATE PARK  
 PARKING LOT**  
 SITE PLAN  
 C-302  
 DESIGNED BY: TC  
 PREPARED BY: PBS

Project No. <b>74252.000</b>	Sheet No. <b>7 OF 15</b>
Date <b>5/20/2022</b>	
Scale <b>AS NOTED</b> <small>IF LESS THAN FULL SIZE, NTS</small>	

# 74252.000 LINCOLN CITY SKATE PARK PARKING LOT

## RAIN GARDEN "A"

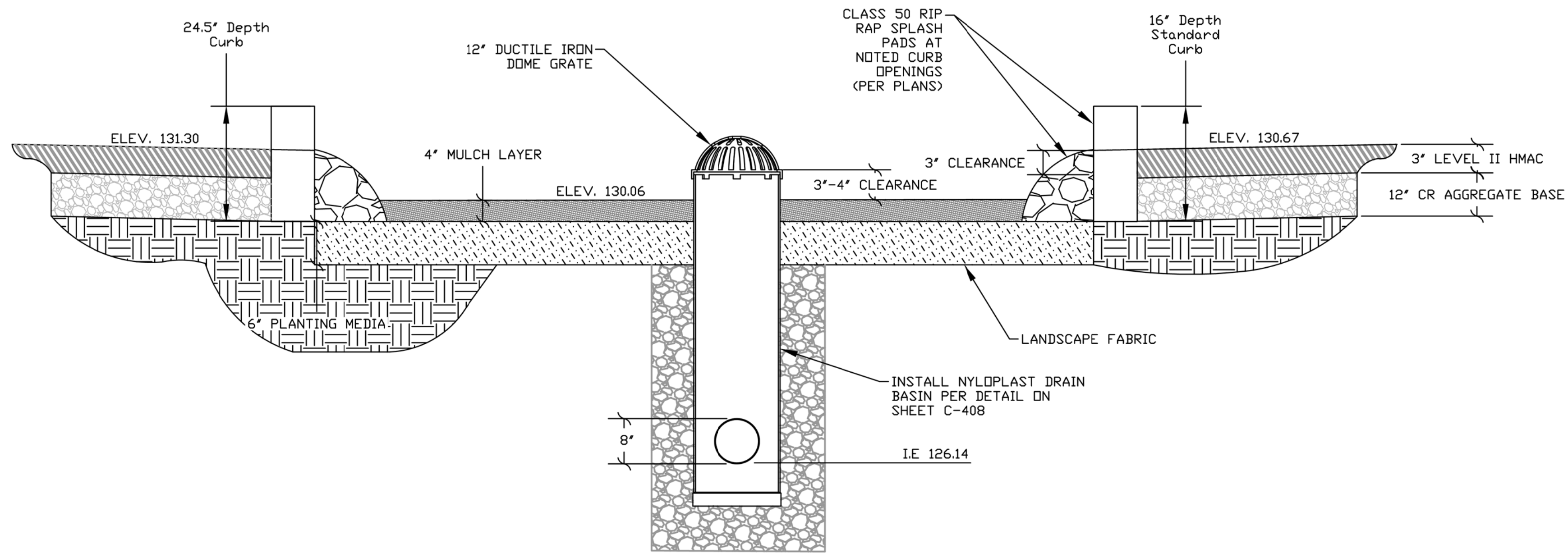

SECTION A-A  
NTS

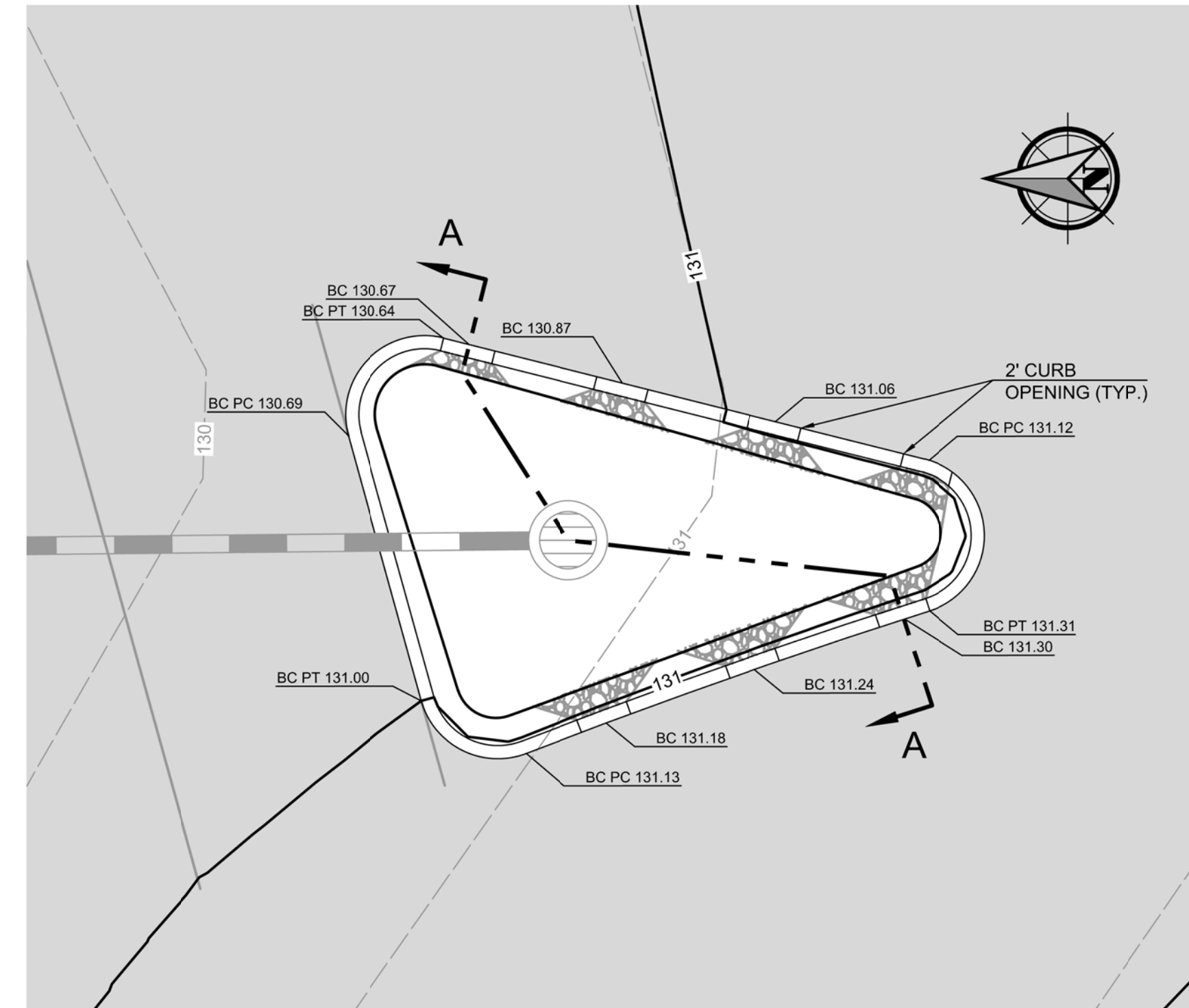

PLAN VIEW  
1" = 5'

## RAIN GARDEN "B"

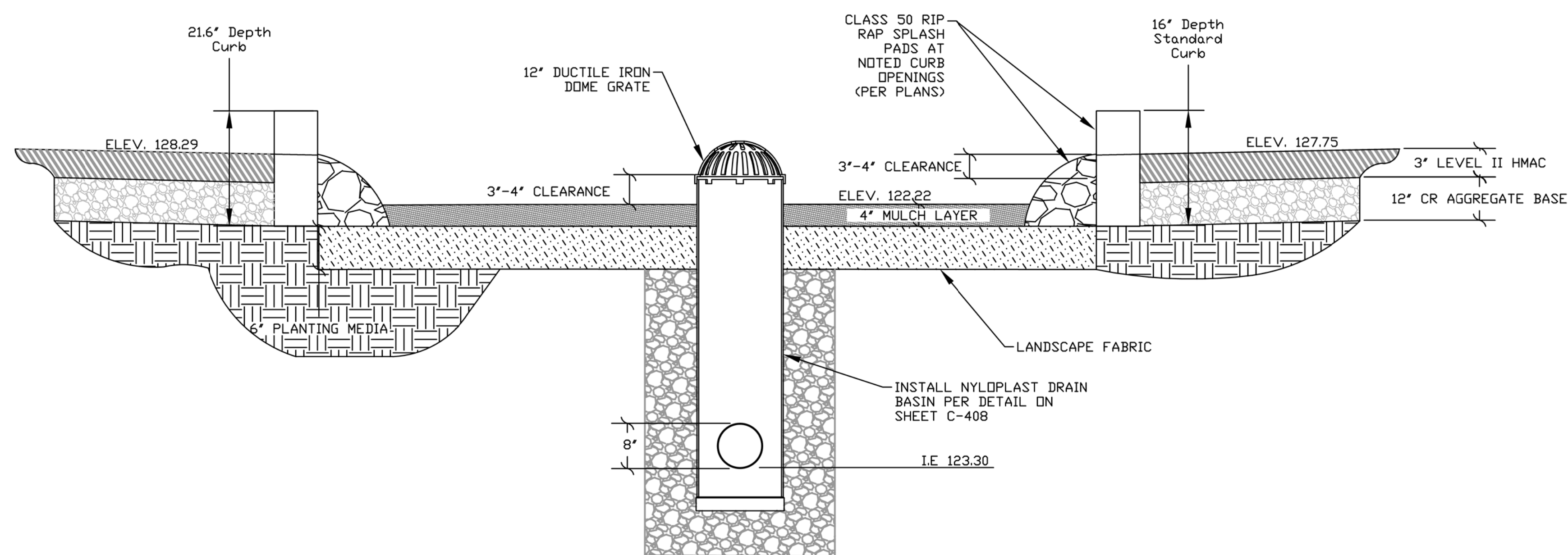

SECTION B-B  
NTS



PLAN VIEW  
1" = 5'

**General Notes**  
OWNER: LINCOLN CITY  
CITY OF LINCOLN CITY  
801 SW HIGHWAY 101  
PO BOX 50  
LINCOLN CITY, OREGON 97367  
CONTACT: TERRY CHAMBERLIN, P.E.  
PHONE: 541.996.1292

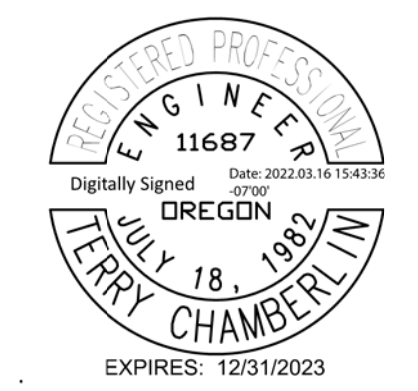

No.	Revision/Issue	Date

**Lincoln City**  
LINCOLN CITY PUBLIC WORKS  
801 S.W. HWY 101  
P.O. BOX 50  
LINCOLN CITY, OREGON 97367  
PHONE: (541) 996-2154  
FAX: (541) 994-4881  
www.lincolncity.org

Project Name and Sheet Name  
LINCOLN CITY SKATE PARK  
PARKING LOT  
RAIN GARDEN PLAN & SECTION  
C-401  
DESIGNED BY: TC  
PREPARED BY: PBS

Project No.: 74252.000	Sheet No. 8 OF 15
Date: 3/7/2022	
Scale: AS NOTED IF LESS THAN FULL SIZE, NTS	







# 74252.000 LINCOLN CITY SKATE PARK PARKING LOT

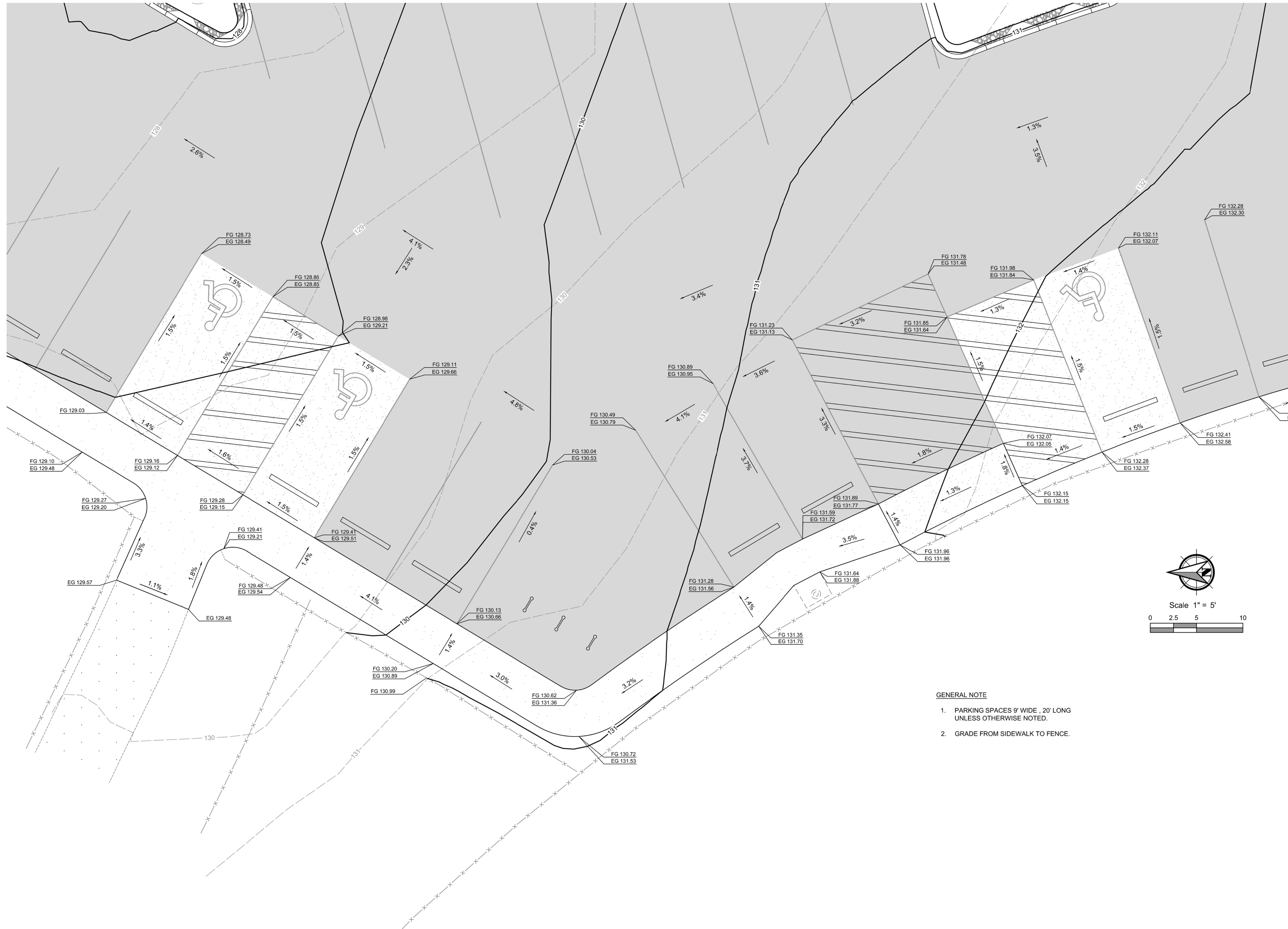

**GENERAL NOTE**

1. PARKING SPACES 9' WIDE, 20' LONG UNLESS OTHERWISE NOTED.
2. GRADE FROM SIDEWALK TO FENCE.

**General Notes**

OWNER: LINCOLN CITY  
 CITY OF LINCOLN CITY  
 801 SW HIGHWAY 101  
 PO BOX 50  
 LINCOLN CITY, OREGON 97367  
 CONTACT: TERRY CHAMBERLIN, P.E.  
 PHONE: 541.996.1292



No.	Revision/Issue	Date

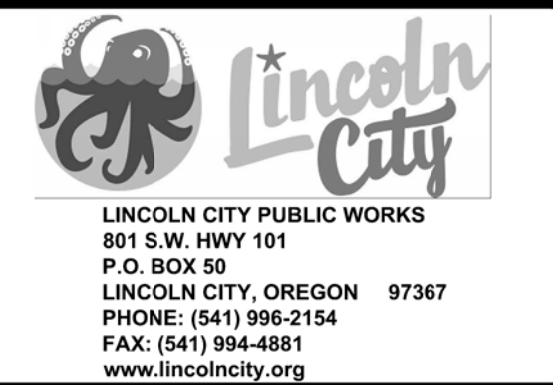

Project Name and Sheet Name  
**LINCOLN CITY SKATE PARK  
 PARKING LOT**  
 ADA PARKING DETAIL  
 C-404  
 DESIGNED BY: TC  
 PREPARED BY: PBS

Project No. 74252.000	Sheet No. <b>11 of 15</b>
Date 3/15/2022	
Scale AS NOTED <small>IF LESS THAN FULL SIZE, NTS</small>	

# 74252.000 LINCOLN CITY SKATE PARK PARKING LOT

- NOTES:**
- WHEN RAINFALL AND RUNOFF OCCURS, A KNOWLEDGEABLE AND EXPERIENCED PERSON IN THE PRINCIPLES, PRACTICES, INSTALLATION, AND MAINTENANCE OF EROSION AND SEDIMENT CONTROLS WHO WORKS FOR THE GENERAL CONTRACTOR MUST PROVIDE DAILY INSPECTIONS OF THE EROSION AND SEDIMENT CONTROLS AND DISCHARGE OUTFALLS.
  - OWNER OR DESIGNATED PERSON SHALL BE RESPONSIBLE FOR PROPER INSTALLATION AND MAINTENANCE OF ALL EROSION AND SEDIMENT CONTROL MEASURES, IN ACCORDANCE WITH CURRENT LINCOLN CITY AND STATE, AND FEDERAL REGULATIONS.
  - CONSTRUCTION ACTIVITIES MUST AVOID OR MINIMIZE EXCAVATION AND CREATION OF BARE GROUND FROM OCTOBER 1 THROUGH MAY 31ST EACH YEAR.
  - DURING WET WEATHER PERIOD, TEMPORARY STABILIZATION OF THE SITE MUST OCCUR AT THE END OF EACH WORK DAY.
  - ALL EXPOSED SOILS MUST BE COVERED DURING WET WEATHER PERIOD. (SEE DETAIL LCPW E&S 150, 165) FOR FILL PILE. PRIOR TO ANY LAND DISTURBING ACTIVITIES, THE BOUNDARIES OF THE CLEARING LIMITS, VEGETATED BUFFERS, AND ANY SENSITIVE AREAS SHOWN ON THIS PLAN SHALL BE CLEARLY DELINEATED IN THE FIELD. UNLESS OTHERWISE APPROVED, NO DISTURBANCE IS PERMITTED BEYOND THE CLEARING LIMITS. THE OWNER/PERMITEE MUST MAINTAIN THE DELINEATION FOR THE DURATION OF THE PROJECT. NOTE: VEGETATED CORRIDORS TO BE DELINEATED WITH ORANGE CONSTRUCTION FENCE OR APPROVED EQUAL.
  - PRIOR TO ANY LAND DISTURBING ACTIVITIES, THE BMPs THAT MUST BE INSTALLED ARE GRAVEL CONSTRUCTION ENTRANCE, PERIMETER SEDIMENT CONTROL, AND INLET PROTECTION. THESE BMPs MUST BE MAINTAINED FOR THE DURATION OF THE PROJECT. (SEE DETAIL LCPW E&S 110, 115, 120, 130, 135, 140, 145) SEDIMENT CONTROLS SUCH AS CHECK DAMS, MATS, WATTLES, SED FENCES MUST BE INSTALLED AND MAINTAINED ON ALL DOWN GRADIENT SIDES OF THE CONSTRUCTION SITE AT ALL TIMES DURING CONSTRUCTION. THEY MUST REMAIN IN PLACE UNTIL PERMANENT VEGETATION OR OTHER PERMANENT COVERING OF EXPOSED SOIL IS ESTABLISHED. (SEE LCPW DET - 115, 125, 150, 155, 160, 170)
  - ALL ACTIVE INLETS MUST HAVE SEDIMENT CONTROLS INSTALLED AND MAINTAINED AT ALL TIMES DURING CONSTRUCTION. UNLESS OTHERWISE APPROVED, A SURFACE MOUNTED AND ATTACHABLE, U-SHAPED FILTER BAG IS REQUIRED FOR ALL CURB INLET CATCH BASINS. (SEE DETAIL LCPW E&S - 135, 140, 145)
  - SIGNIFICANT AMOUNTS OF SEDIMENT THAT LEAVES THE SITE MUST BE CLEANED UP WITHIN 24 HOURS AND PLACED BACK ON THE SITE AND STABILIZED OR PROPERLY DISPOSED. THE CAUSE OF THE SEDIMENT RELEASE MUST BE FOUND AND PREVENTED FROM CAUSING A RECURRING OF THE DISCHARGE WITHIN THE SAME 24 HOURS. ANY IN-STREAM CLEAN UP OF SEDIMENT SHALL BE PERFORMED ACCORDING TO THE OREGON DEPARTMENT OF STATE LANDS REQUIRED TIME FRAME.
  - SEDIMENT MUST NOT BE INTENTIONALLY WASHED INTO STORM SEWERS, DRAINAGEWAYS, OR WATER BODIES.
  - SEDIMENT MUST BE REMOVED FROM BEHIND ALL SEDIMENT CONTROL MEASURES WHEN IT HAS REACHED A HEIGHT OF 1/3-RD THE BARRIER HEIGHT AND PRIOR TO THE CONTROL MEASURES REMOVAL.
  - CLEANING OF ALL STRUCTURES WITH SUMPS MUST OCCUR WHEN THE SEDIMENT RETENTION CAPACITY HAS BEEN REDUCED BY 50% AND AT COMPLETION OF PROJECT.
  - ANY USE OF TOXIC OR OTHER HAZARDOUS MATERIALS MUST INCLUDE PROPER STORAGE, APPLICATION, AND DISPOSAL.
  - THE PERMITEE MUST PROPERLY MANAGE HAZARDOUS WASTES, USED OILS, CONTAMINATED SOILS, CONCRETE WASTE, SANITARY WASTE, LIQUID WASTE, OR OTHER TOXIC SUBSTANCES DISCOVERED OR GENERATED DURING CONSTRUCTION.
  - THE APPLICATION RATE OF FERTILIZERS USED TO REESTABLISH VEGETATION MUST FOLLOW MANUFACTURER'S RECOMMENDATIONS. NUTRIENT RELEASES FROM FERTILIZERS TO SURFACE WATERS MUST BE MINIMIZED. TIME RELEASE FERTILIZERS SHOULD BE USED AND CARE SHOULD BE MADE IN APPLICATION OF FERTILIZERS WITHIN ANY WATER WAY RIPARIAN ZONE.
  - IF VEGETATIVE SEED MIXES ARE SPECIFIED, SEEDING MUST TAKE PLACE NO LATER THAN SEPTEMBER 1ST; THE TYPE AND PERCENTAGES OF SEED IN THE MIX ARE AS IDENTIFIED ON THE PLANS OR AS SPECIFIED BY THE DESIGN ENGINEER.
  - WATERTIGHT TRUCKS MUST BE USED TO TRANSPORT SATURATED SOILS FROM THE CONSTRUCTION SITE. AN APPROVED EQUIVALENT IS TO DRAIN THE SOIL ON SITE AT A DESIGNATED LOCATION USING APPROPRIATE BMPs; SOIL MUST BE DRAINED SUFFICIENTLY FOR MINIMAL SPILLAGE.
  - ALL PUMPING OF SEDIMENT LADEN WATER MUST BE DISCHARGED OVER AN UNDISTURBED, PREFERABLY VEGETATED AREA, AND THROUGH A SEDIMENT CONTROL BMP (I.E. FILTER BAG).
  - THE ESC PLAN MUST BE KEPT ON SITE. ALL MEASURES SHOWN ON THE PLAN MUST BE INSTALLED PROPERLY TO ENSURE THAT SEDIMENT LADEN WATER DOES NOT ENTER A SURFACE WATER SYSTEM, ROADWAY, OR OTHER PROPERTIES.
  - THE ESC MEASURES SHOWN ON THIS PLAN ARE THE MINIMUM REQUIREMENTS FOR ANTICIPATED SITE CONDITIONS. DURING THE CONSTRUCTION PERIOD, THESE MEASURES SHALL BE UPGRADED AS NEEDED TO MAINTAIN COMPLIANCE WITH ALL REGULATIONS.
  - WRITTEN ESC LOGS ARE SUGGESTED TO BE MAINTAINED ON SITE AND AVAILABLE TO DISTRICT INSPECTORS UPON REQUEST.
  - IN AREAS SUBJECT TO WIND EROSION, APPROPRIATE BMPs MUST BE USED WHICH MAY INCLUDE THE APPLICATION OF FINE WATER SPRAYING, PLASTIC SHEETING, MULCHING, OR OTHER APPROVED MEASURES.

**STANDARD EROSION CONTROL NOTES FOR CONSTRUCTION SITES LESS THAN 1 ACRE**  
 DETAIL: 100 - LCPW E&S Standard Notes  
 REVISED: APRIL 2019

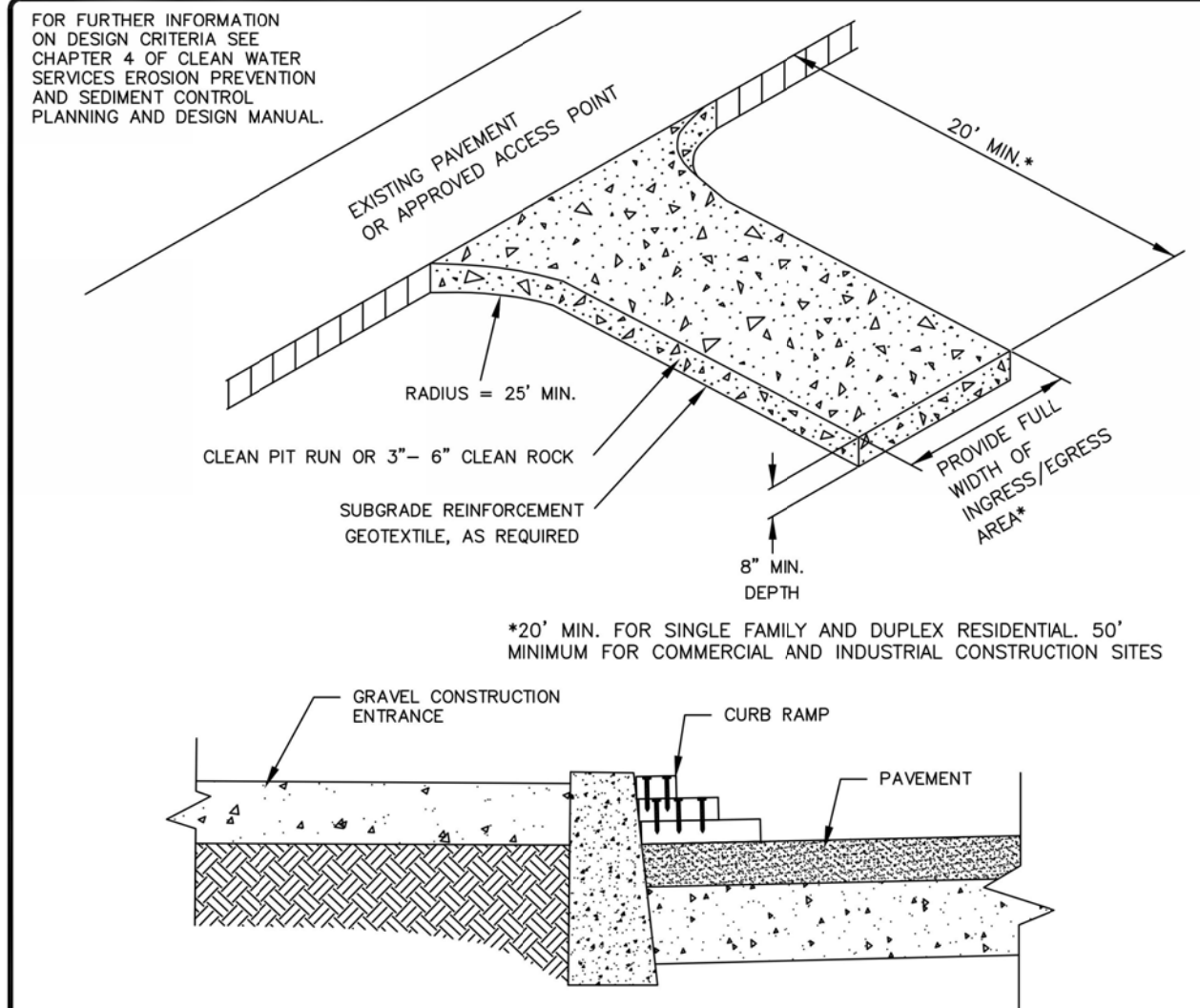

- NOTES:**
- THE ENTRANCE SHALL BE MAINTAINED IN A CONDITION THAT WILL PREVENT TRACKING OR FLOWING OF SEDIMENT ONTO PUBLIC RIGHT-OF-WAYS. THIS MAY REQUIRE TOP DRESSING, REPAIR AND/OR CLEAN OUT OF ANY MEASURES USED TO TRAP SEDIMENT.
  - WHEN NECESSARY, WHEELS SHALL BE CLEANED PRIOR TO ENTRANCE ONTO PUBLIC RIGHT-OF-WAY. WHEN WASHING IS REQUIRED, IT SHALL BE DONE ON AN AREA STABILIZED WITH CRUSHED STONE THAT DRAINS INTO AN APPROVED SEDIMENT TRAP OR SEDIMENT BASIN.
  - WHERE RUNOFF CONTAINING SEDIMENT LADEN WATER IS LEAVING THE SITE VIA THE CONSTRUCTION ENTRANCE, OTHER MEASURES SHALL BE IMPLEMENTED TO DIVERT RUNOFF THROUGH AN APPROVED FILTERING SYSTEM.
  - DIMENSIONS**  
 SINGLE FAMILY  
 20' LONG BY 20" WIDE 8" DEEP OF 3/4" MINUS CLEAN ROCK.  
 COMMERCIAL  
 50' LONG BY 20" WIDE 3-6" CLEAN ROCK. GOVERNING AUTHORITY MAY REQUIRE GEOTEXTILE FABRIC TO PREVENT SUB-SOIL PUMPING.

**CONSTRUCTION ENTRANCE GRAVEL**  
 DETAIL-110 LCPW E&S  
 REVISED: APRIL 2019

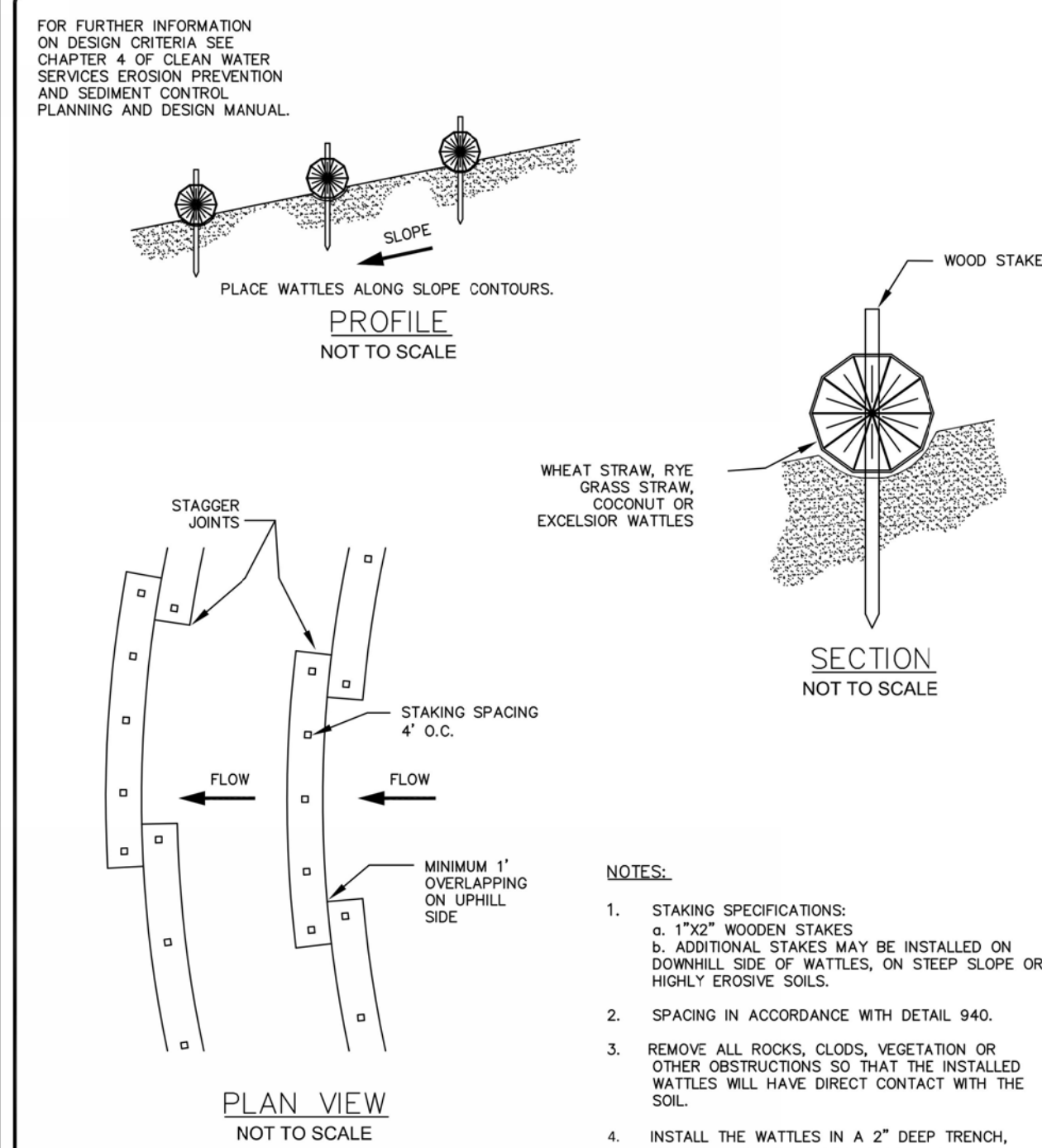

- NOTES:**
- STAKING SPECIFICATIONS:  
 a. 1"X2" WOODEN STAKES  
 b. ADDITIONAL STAKES MAY BE INSTALLED ON DOWNHILL SIDE OF WATTLES, ON STEEP SLOPE OR HIGHLY ERODIBLE SOILS.
  - SPACING IN ACCORDANCE WITH DETAIL 940.
  - REMOVE ALL ROCKS, CLODS, VEGETATION OR OTHER OBSTRUCTIONS SO THAT THE INSTALLED WATTLES WILL HAVE DIRECT CONTACT WITH THE SOIL.
  - INSTALL THE WATTLES IN A 2" DEEP TRENCH, INSURING THAT NO GAPS EXIST BETWEEN THE SOIL AND THE BOTTOM OF THE WATTLE. THE ENDS OF ADJACENT WATTLES SHALL BE OVERLAPPED 1 FT. MINIMUM TO PREVENT SEDIMENT PASSING THROUGH THE FIELD JOINT.

**WATTLE INSTALLATION DETAIL**  
 DETAIL: 125 LCPW E&S - WATTLE INSTALLATION  
 REVISED: APRIL 2019

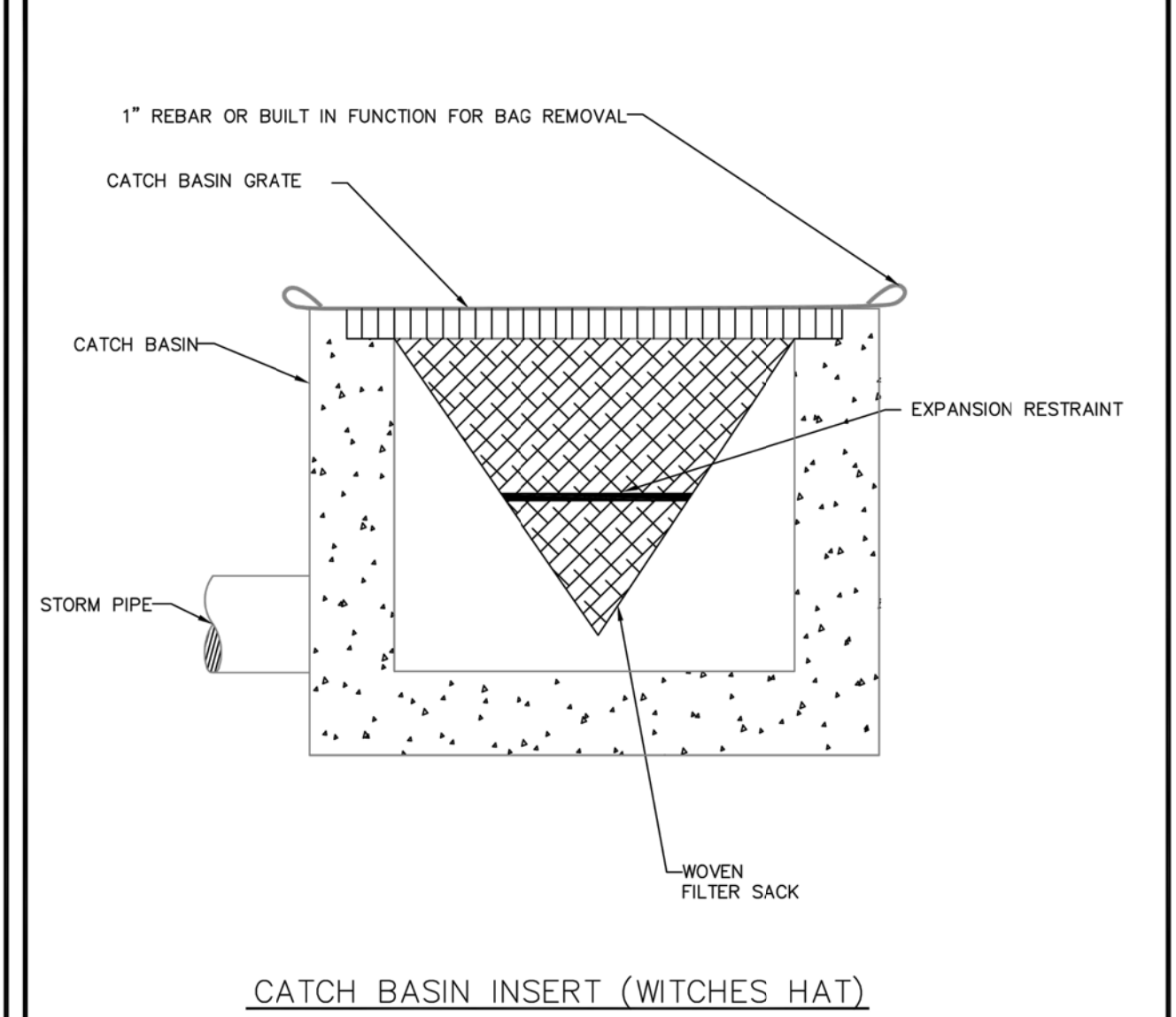

- NOTE:**
- RECESSED CURB INLET CATCH BASINS MUST BE BLOCKED WHEN USING FILTER FABRIC INLET SACKS. SIZE OF FILTER FABRIC INLET SACKS TO BE DETERMINED BY MANUFACTURER.
- FOR FURTHER INFORMATION ON DESIGN CRITERIA SEE CHAPTER 4 OF CLEAN WATER SERVICES EROSION PREVENTION AND SEDIMENT CONTROL PLANNING AND DESIGN MANUAL.

**CATCH BASIN PROTECTION (WITCHES HAT)**  
 DETAIL: 145 LCPW E&S - CATCH BASIN PROTECTION  
 REVISED: APRIL 2019

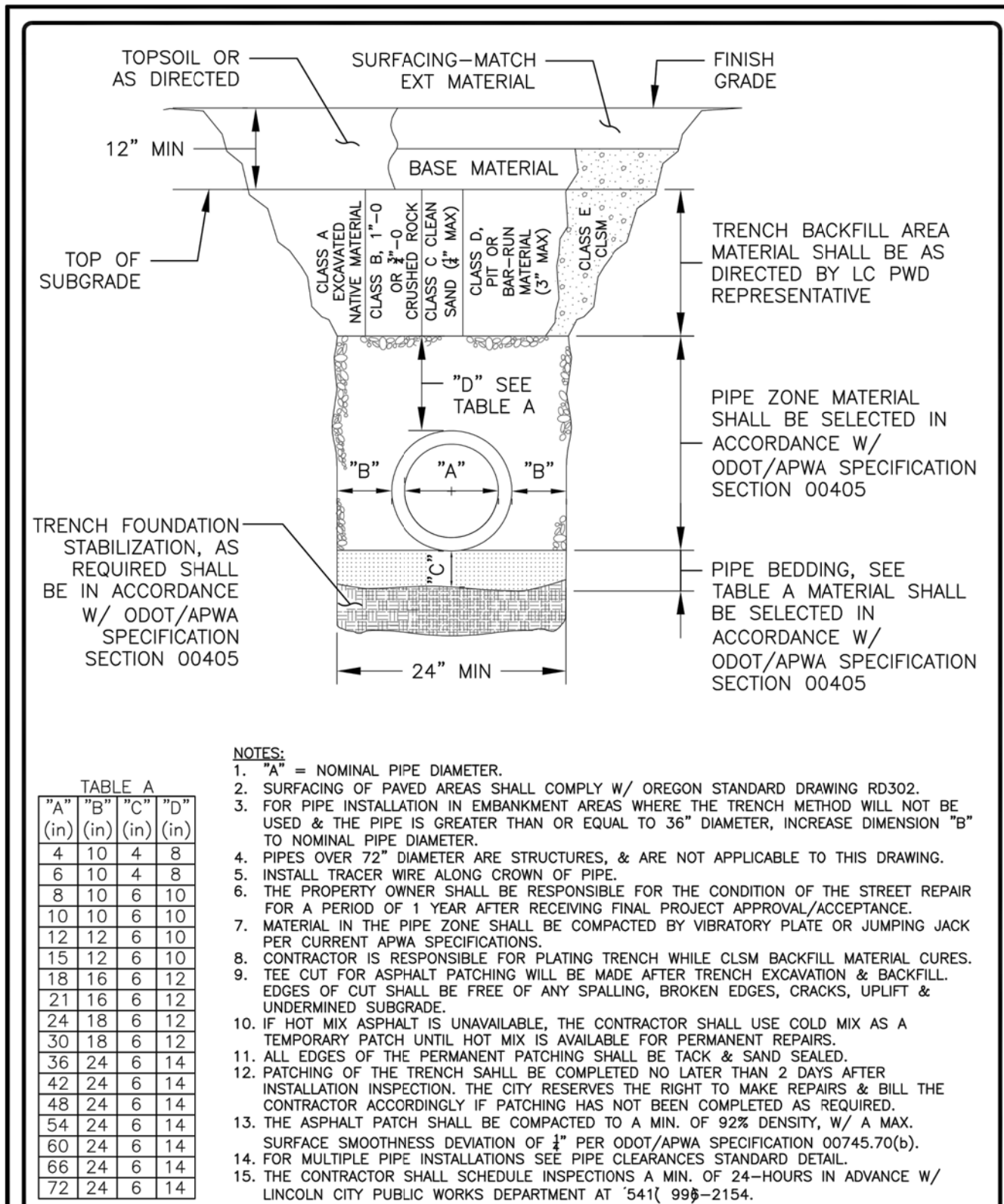

**400-LCPW STREETS-Trench Cut**  
 DETAIL: 400 LCPW STREETS-Trench Cut  
 REVISED: MAY, 2020

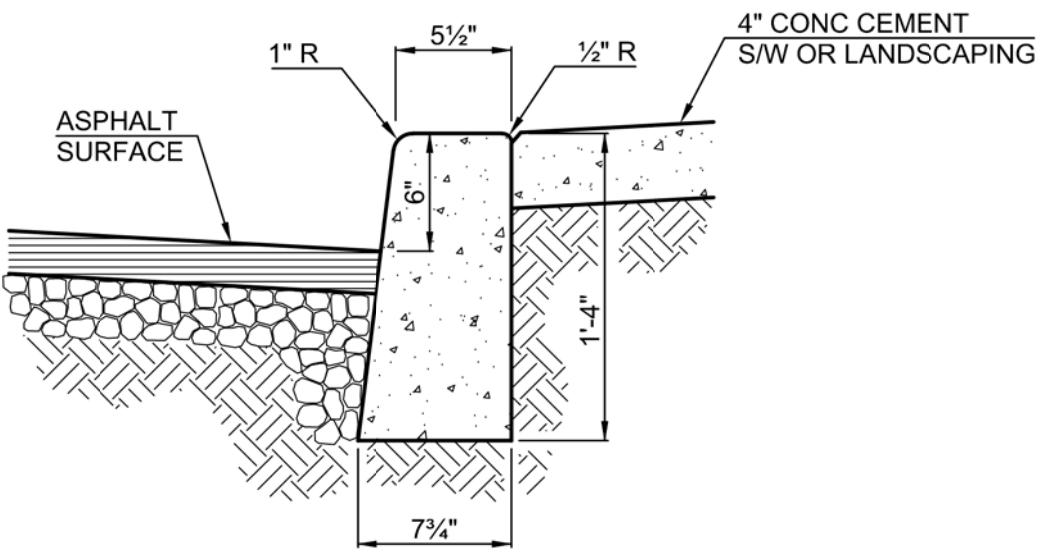

- Notes:**
- Concrete shall be class 3000.
  - Curbs adjacent to pavement or sidewalk have expansion and/or contraction joints to match existing patterns.
  - 3/8" expansion joints shall be placed at 45' maximum spacing, on both sides of catch basins, at tops of driveways, and all changes in direction. 1 1/2" cut joints to be placed at 15' maximum spacing.
  - Compact subgrade and aggregated to 95% of max. Dry density.
  - Curb to be brush finished.

**6" Standard Curb**  
 NTS

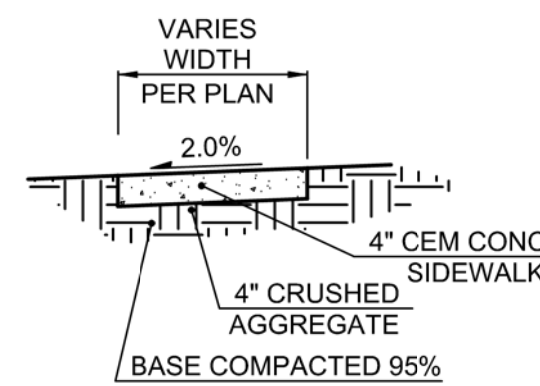

- Notes:**
- Install expansion joint every 200' max.
  - Install contraction joint every 15' max.

**Sidewalk Section**  
 NTS

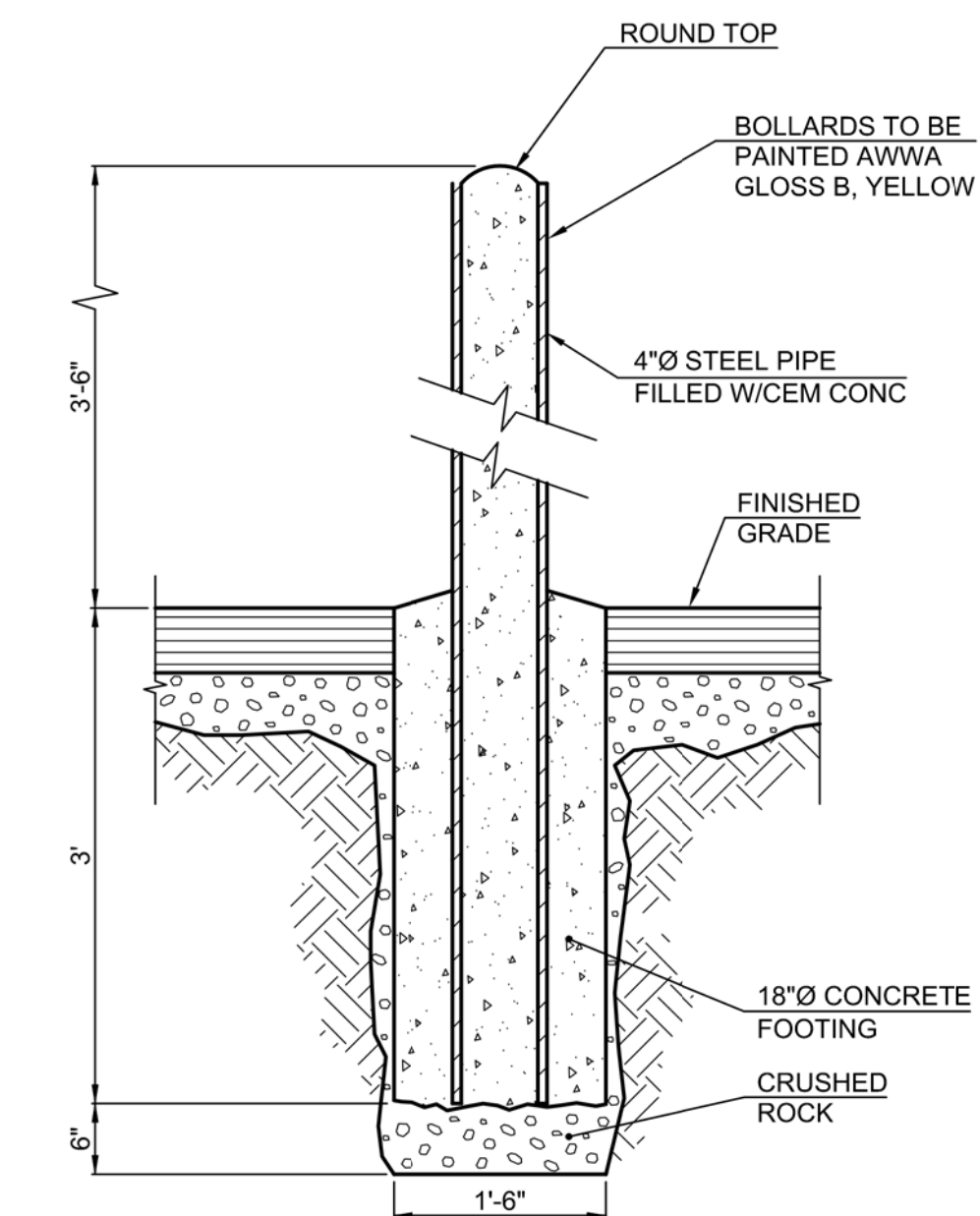

**Typical Bollard Section**  
 NTS

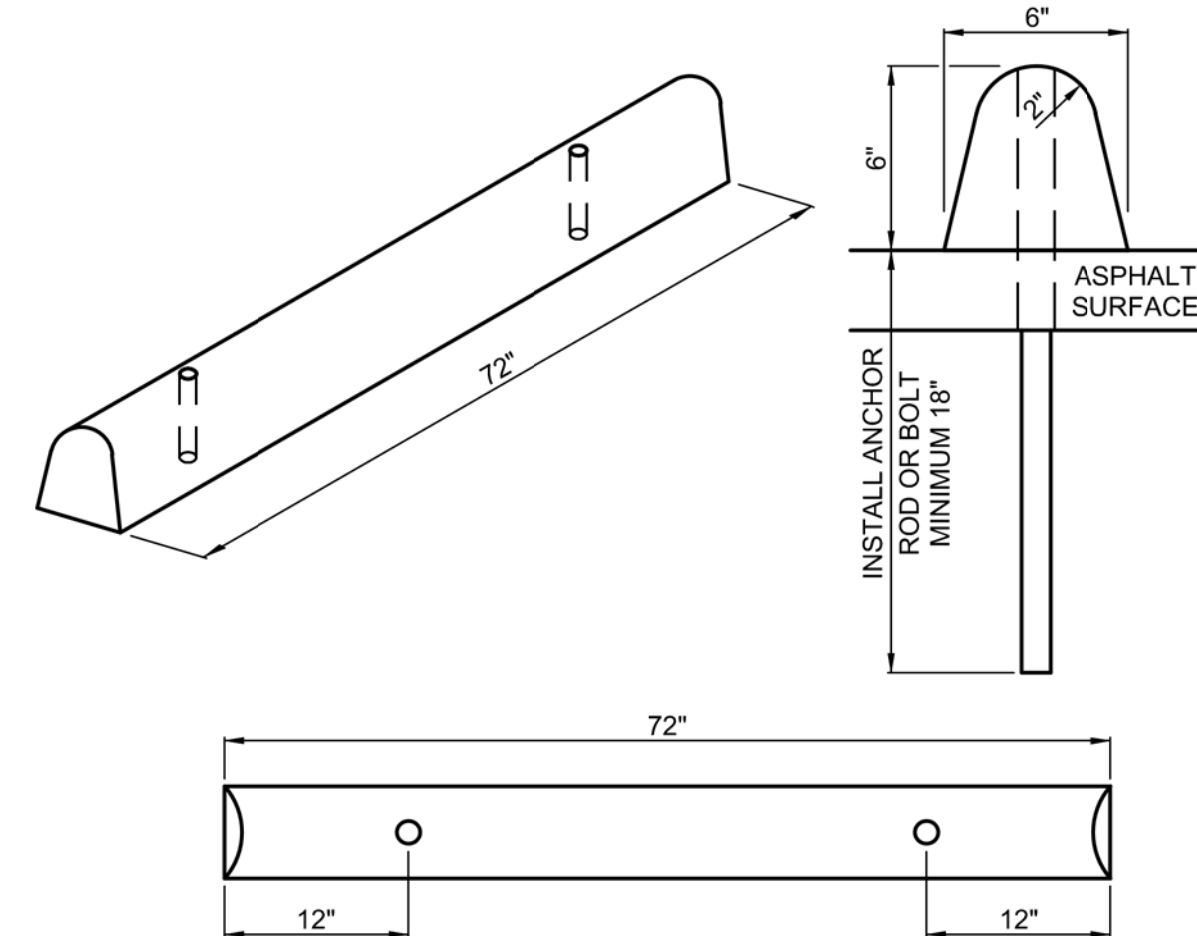

**Plastic Wheel Stop**  
 NTS

**General Notes**  
 OWNER: LINCOLN CITY  
 CITY OF LINCOLN CITY  
 801 SW HIGHWAY 101  
 PO BOX 50  
 LINCOLN CITY, OREGON 97367  
 CONTACT: TERRY CHAMBERLIN, P.E.  
 PHONE: 541.996.1292



No.	Revision/Issue	Date

**Lincoln City**  
 LINCOLN CITY PUBLIC WORKS  
 801 S.W. HWY 101  
 P.O. BOX 50  
 LINCOLN CITY, OREGON 97367  
 PHONE: (541) 996-2154  
 FAX: (541) 994-4881  
 www.lincolncity.org

Project Name and Sheet Name  
**LINCOLN CITY SKATE PARK PARKING LOT**  
 DETAILS  
 C-405  
 DESIGNED BY: TC  
 PREPARED BY: PBS

Project No.: 74252.000	Sheet No. 12 OF 15
Date 3/7/2022	
Scale AS NOTED IF LESS THAN FULL SIZE, NTS	

# 74252.000 LINCOLN CITY SKATE PARK PARKING LOT

<b>4" WHITE LINE</b>	<b>8" WHITE LINE</b>	<b>4" YELLOW LINE</b>	<b>CHEVRON BARS</b> 1" WHITE BARS AT 20' SPACING	<b>TRANSVERSE MEDIAN BARS</b> 1" YELLOW BARS AT 20' SPACING
<b>4" WHITE BROKEN LINE</b>	<b>4" YELLOW BROKEN LINE</b>	<b>4" WHITE DOTTED LINE</b> For lane extensions	<b>8" WHITE DOTTED LINE</b> For lane extensions and bike lane extensions	<b>4" YELLOW DOTTED LINE</b> For lane extensions
<b>4" WHITE DOTTED LANE LINE</b> For lane lines in acceleration/deceleration lanes	<b>8" WHITE DOTTED LANE LINE</b> For lane lines in drop lanes	<b>NO-PASS RIGHT</b> 4" YELLOW LINES	<b>NO-PASS LEFT</b> 4" YELLOW LINES	<b>TWO-WAY LEFT TURN</b> 4" YELLOW LINES
<b>TRANSVERSE MEDIAN BARS</b> 1" YELLOW BARS AT 40' SPACING For use at painted medians where distance between left turn refuges exceeds 200'	<b>DOUBLE NO-PASS</b> TWO 4" YELLOW LINES	<b>NARROW DOUBLE NO-PASS</b> TWO 4" YELLOW LINES	<b>NARROW DOUBLE NO-LANE CHANGE</b> TWO 4" WHITE LINES	<b>TRANSVERSE SHOULDER BARS</b> 1" WHITE BARS AT 20' SPACING
			<p>Effective Date: December 01, 2021 - May 31, 2022</p> <p>TM500</p>	
<b>DISABLED PARKING DETAIL (white)</b>	<b>YIELD LINE (white)</b>	<b>BICYCLE YIELD LINE (white)</b>	<p>Calc. Book No. N/A</p> <p>SOR DATE 07/01/2020</p> <p>NOTE: All material and workmanship shall be in accordance with the current Oregon Standard Specifications.</p> <p><b>OREGON STANDARD DRAWINGS</b></p> <p><b>PAVEMENT MARKING STANDARD DETAIL BLOCKS</b></p> <p>2021</p> <p>DATE 07/20/2020 REVISION DESCRIPTION Changed Min. widths for CH, TM, TM-40, and TS</p>	

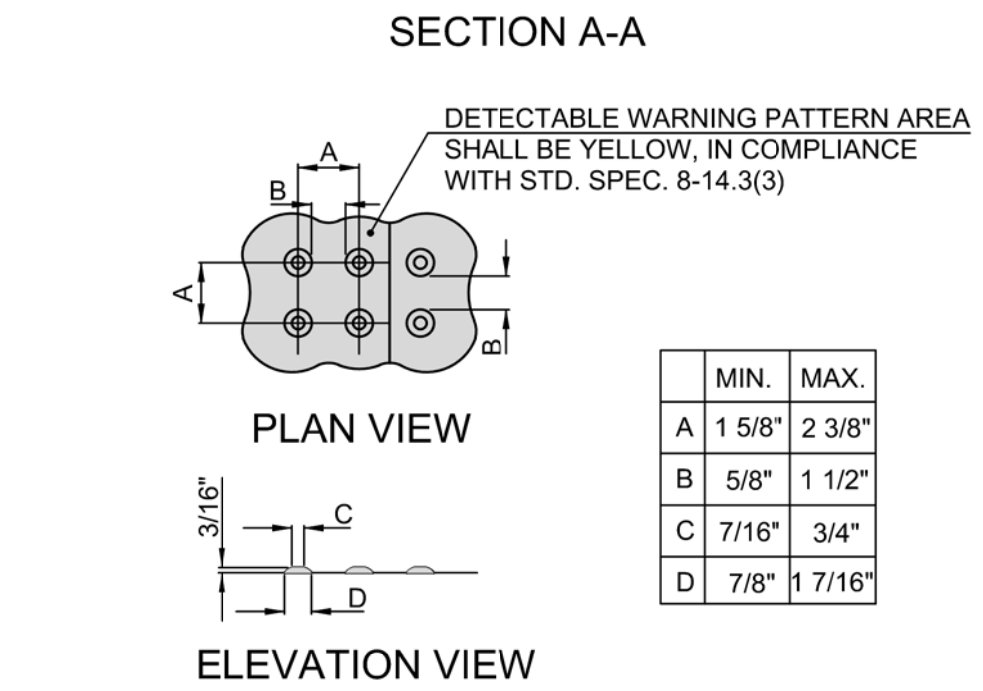
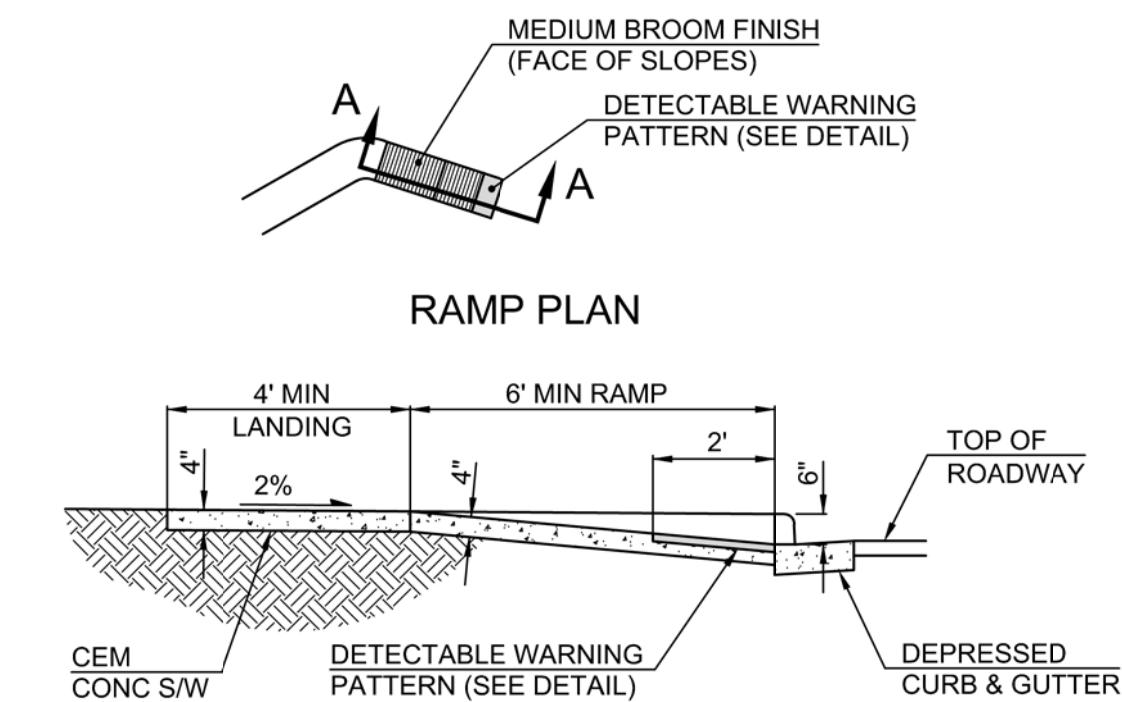

- Notes:
- Do not place drainage structures, junction boxes or other obstructions in front of ramp access areas.
  - Detectable warning patterns may be created by any odot approved method that will achieve the truncated dome dimensions and spacing shown.
  - Changes in level up to 1/4" may be vertical and without edge treatment. Changes in level between 1/4" and 1/2" shall be beveled with a slope no greater than 1:2.
  - Detectable warning surfaces shall extend 24 inches minimum in the direction of travel and the full width of the curb ramp, landing or blended transition.
  - The detectable warning surface shall be located so that the edge nearest the face of curb is 6 inches minimum and 8 inches maximum from the face of curb.
  - Concrete per materials list, 3,000 psi minimum.
  - Location of ramps to be approved by the city engineer.

## ADA Ramp With Detectable Warning

<b>STANDARD CROSSWALK</b> TWO 1" WHITE BARS Install per Standard Drawing TM530	<b>STAGGERED CONTINENTAL CROSSWALK</b> 2" WHITE BARS Install per Standard Drawing TM530	<b>STOP BAR</b> 1" WHITE BAR Install per Standard Drawing TM530	<b>STOP BAR - LARGE</b> 2" WHITE BARS Install per Standard Drawing TM530	<b>RAMP METER STOP BAR</b> 1" & 8" WHITE BARS For multi-lane ramp meter applications
<b>BIKE RIGHT TURN STENCIL (white)</b> Center marking within lane width For proportion details, see current version of Standard Highway Signs	<b>BIKE LANE STANDARD STENCIL (white)</b> Center marking within lane width For proportion details, see current version of Standard Highway Signs	<b>BIKE LEFT TURN STENCIL (white)</b> Center marking within lane width For proportion details, see current version of Standard Highway Signs	<b>BIKE RIGHT TURN STRAIGHT STENCIL (white)</b> Center marking within lane width For proportion details, see current version of Standard Highway Signs	<b>BIKE LEFT TURN STRAIGHT STENCIL (white)</b> Center marking within lane width For proportion details, see current version of Standard Highway Signs
<b>SHARED LANE MARKING (white)</b> Center marking within lane width or as shown For proportion details, see current version of Standard Highway Signs	<b>BIKE STENCIL (white)</b> Used for Intersection Bicycle Box applications Place marking within bicycle box, centered with motor vehicle lane width	<b>BICYCLE DETECTOR MARKING (white)</b> Place Bicycle Detector Pavement Marking in optimum location where bicycle actuates the traffic signal	<b>GREEN SUPPLEMENTAL BICYCLE LANE SOLID LINE (green)</b>	<b>GREEN SUPPLEMENTAL BICYCLE LANE DOTTED LINE EXTENSION (green)</b>
<b>BUS (white)</b> Center marking within lane width For letter proportion details, see current version of Standard Highway Signs	<b>ONLY (white)</b> Center marking within lane width For letter proportion details, see current version of Standard Highway Signs	<b>SCHOOL (white)</b> Center marking within lane width For letter proportion details, see current version of Standard Highway Signs	<b>SCHOOL - LARGE (white)</b> Center marking within width of two lanes For letter proportion details, see current version of Standard Highway Signs	<b>CROSSING - LARGE (white)</b> Center marking within width of two lanes For letter proportion details, see current version of Standard Highway Signs
		<p>General Note: 1. Arrow, letter, and bike symbol dimensions nominal.</p> <p>The selection and use of this Standard Drawing, while designed in accordance with generally accepted engineering principles and practices, is the sole responsibility of the user and should not be used without consulting a Registered Professional Engineer.</p>		
<b>X-ING (white)</b> Center marking within lane width For letter proportion details, see current version of Standard Highway Signs	<b>ON-STREET PARKING DETAIL (white)</b>	<p>Effective Date: December 01, 2021 - May 31, 2022</p> <p>TM503</p>		

**General Notes**

OWNER: LINCOLN CITY  
CITY OF LINCOLN CITY  
801 SW HIGHWAY 101  
PO BOX 50  
LINCOLN CITY, OREGON 97367

CONTACT: TERRY CHAMBERLIN, P.E.  
PHONE: 541.996.1292



No.	Revision/Issue	Date

**Lincoln City**

LINCOLN CITY PUBLIC WORKS  
801 S.W. HWY 101  
P.O. BOX 50  
LINCOLN CITY, OREGON 97367  
PHONE: (541) 996-2154  
FAX: (541) 994-4881  
www.lincolncity.org

Project Name and Sheet Name  
LINCOLN CITY SKATE PARK  
PARKING LOT

DETAILS  
C-406

DESIGNED BY: TC  
PREPARED BY: PBS

Project No.: 74252.000	Sheet No. 13 of 15
Date: 3/7/2022	
Scale: AS NOTED	
IF LESS THAN FULL SIZE, NTS	

# 74252.000 LINCOLN CITY SKATE PARK PARKING LOT

OREGON TRANSPORTATION COMMISSION  
Standards for Accessible Parking Places  
August 2018

## MINIMUM STANDARD SINGLE-ACCESSIBLE PARKING SPACE (VAN-ACCESSIBLE DESIGNATION REQUIRED)

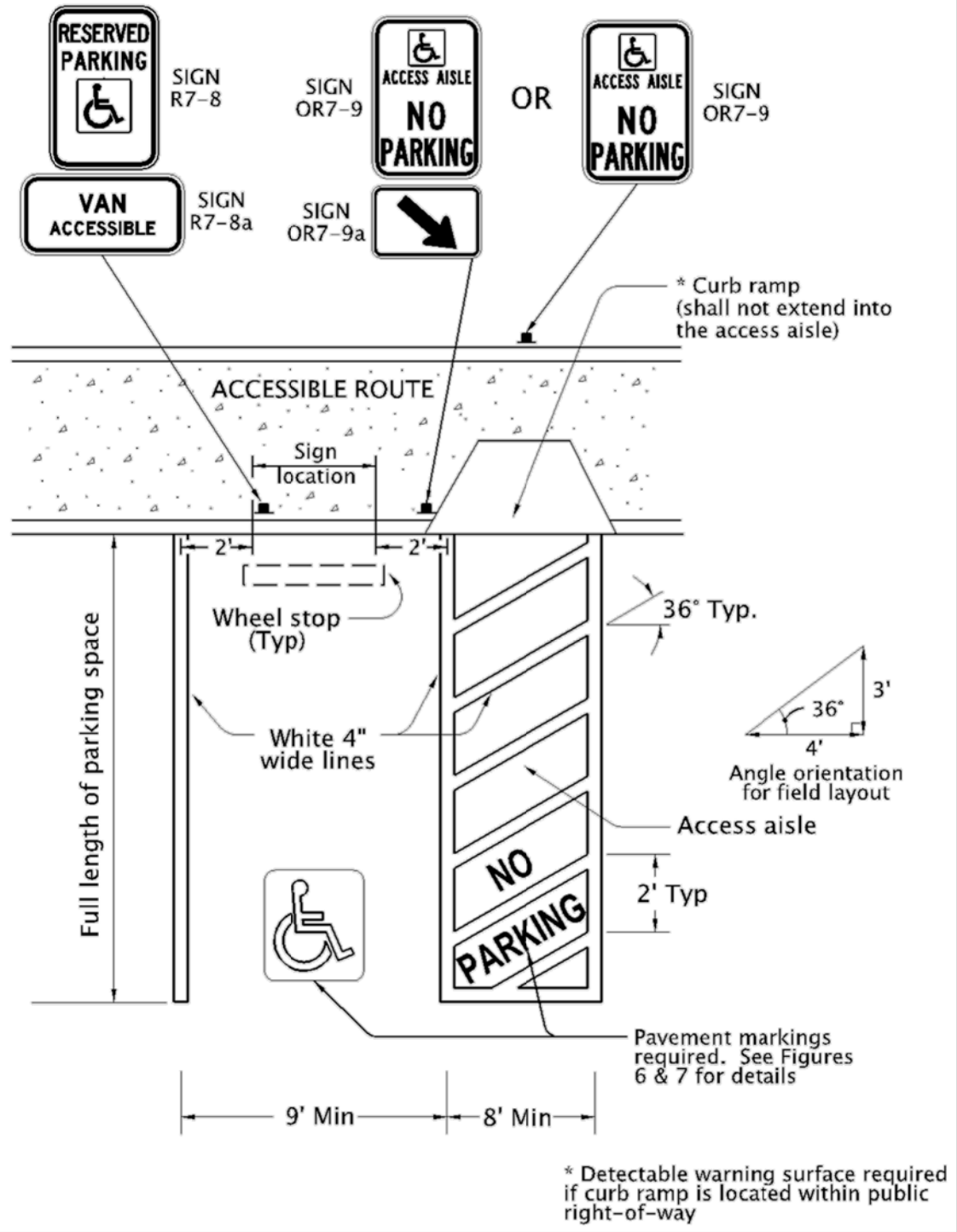

Figure 1

OREGON TRANSPORTATION COMMISSION  
Standards for Accessible Parking Places  
August 2018

## MINIMUM STANDARD DOUBLE-ACCESSIBLE PARKING SPACE (ONE VAN-ACCESSIBLE DESIGNATION REQUIRED)

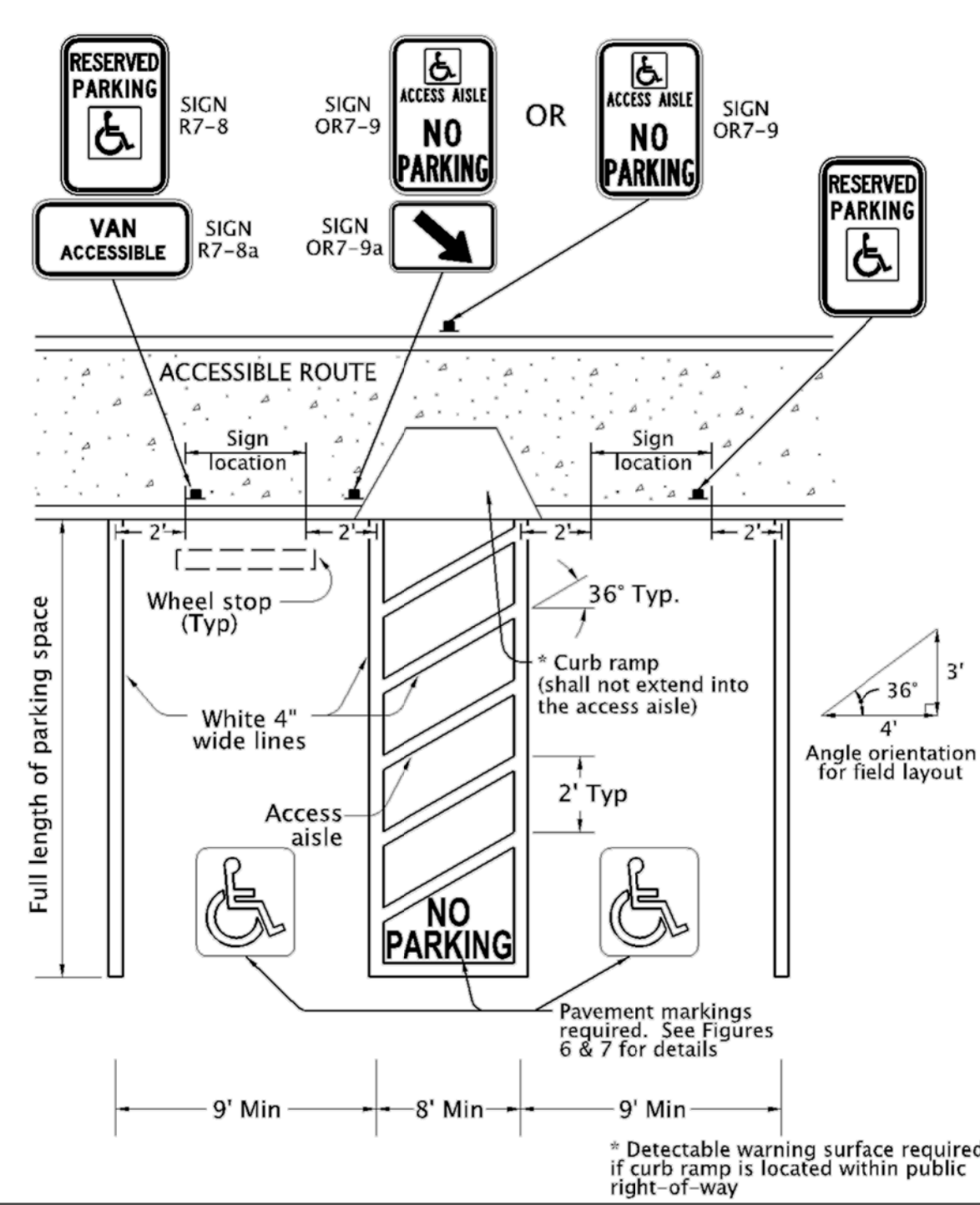
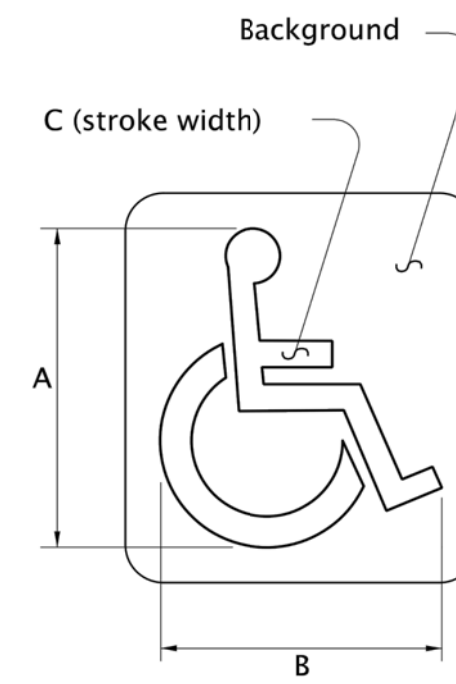

Figure 2

OREGON TRANSPORTATION COMMISSION  
Standards for Accessible Parking Places  
August 2018

## PAVEMENT MARKING STENCIL



Pavement Marking Background: Optional: Blue, Retroreflective  
Pavement Marking Stencil: White, Retroreflective

LEGEND	DIMENSIONS (INCHES)						
	A	B	C	D	E	F	G
MINIMUM	28	24	3				
STANDARD	41	36	4				

The pavement marking stencil shall be used to designate an accessible parking area reserved for vehicles with DMV permits.

Figure 6

OREGON TRANSPORTATION COMMISSION  
Standards for Accessible Parking Places  
August 2018

## PAVEMENT MARKING LEGEND

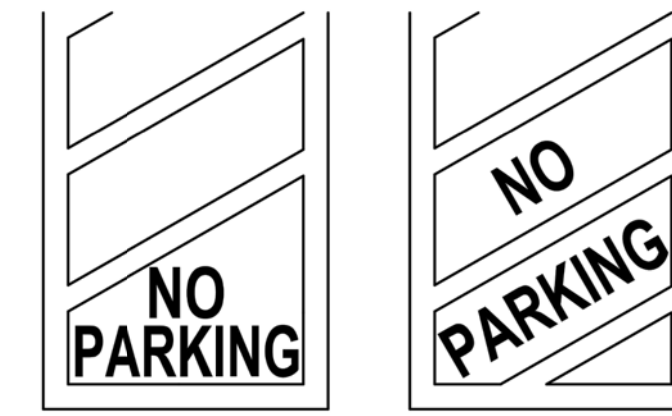

Pavement Marking Legend: White or Yellow, Retroreflective

The "No Parking" pavement marking is used to designate an access aisle reserved for persons use parking with a DMV permit. This marking shall be required for all access aisles next to accessible parking spaces. Engineering judgement should be used for placement location to give best visual location to prevent illegal use of access aisle. Yellow may be used instead of white to increase contrast between access aisle white lines and the "No Parking" legend.

Figure 7

OREGON TRANSPORTATION COMMISSION  
Standards for Accessible Parking Places  
August 2018

## SIGN DESIGN SIGN NO. R7-8



Sign Background: White, Retroreflective sheeting  
Sign Legend: Green, Retroreflective sheeting  
Sign Symbol: White on Blue, Retroreflective sheeting

Refer to Standard Highway Signs book for details.

The Disabled Person parking sign is used to designate a parking area reserved for vehicles with DMV permit as stated.

Figure 8

OREGON TRANSPORTATION COMMISSION  
Standards for Accessible Parking Places  
August 2018

## SIGN DESIGN SIGN NO. R7-8P

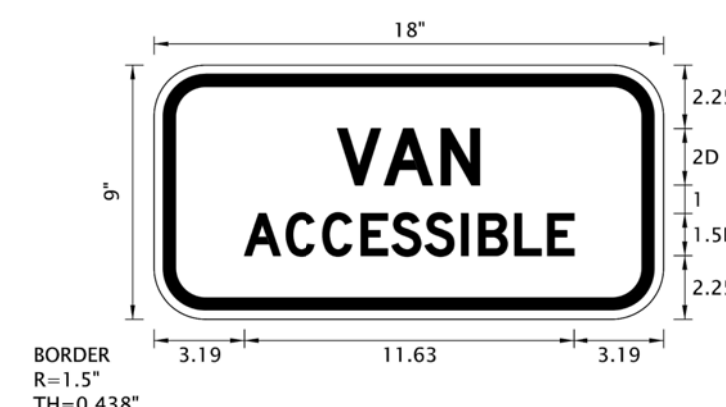

Sign Background: White, Retroreflective sheeting  
Sign Legend: Green, Retroreflective sheeting

Refer to Standard Highway Signs book for details and dimensions.

The VAN-ACCESSIBLE sign shall only be used with sign R7-8 to designate the parking spaces that have an access aisle 8 ft or wider

Figure 9

OREGON TRANSPORTATION COMMISSION  
Standards for Accessible Parking Places  
August 2018

## SIGN DESIGN

### SIGN NO. OR7-9



### SIGN NO. OR7-9a

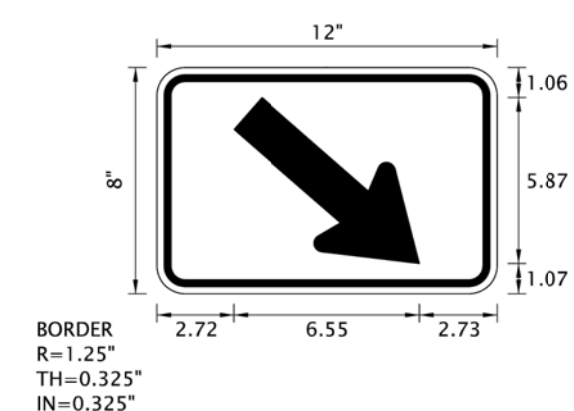

Sign Background: White, Retroreflective sheeting

Sign Legend: Red, Retroreflective sheeting  
Sign Symbol: White on Blue, Retroreflective sheeting

Sign OR7-9a: Use when back of walk directly behind access aisle is not available for sign placement and sign must be placed to one side of pedestrian access ramp.

The No Parking in Access Aisle sign is used to designate an access aisle reserved for persons use parking with DMV permit. Install sign in locations where "No Parking" pavement marking may not be visible regularly from snow or sand. Place sign to have direct view from end of access aisle when possible outside of accessible route.

Figure 11

General Notes

OWNER: LINCOLN CITY  
CITY OF LINCOLN CITY  
801 SW HIGHWAY 101  
PO BOX 50  
LINCOLN CITY, OREGON 97367

CONTACT: TERRY CHAMBERLIN, P.E.  
PHONE: 541.996.1292

No.	Revision/Issue	Date

LINCOLN CITY PUBLIC WORKS  
801 S.W. HWY 101  
P.O. BOX 50  
LINCOLN CITY, OREGON 97367  
PHONE: (541) 996-2154  
FAX: (541) 994-4881  
www.lincolncity.org

Project Name and Sheet Name  
LINCOLN CITY SKATE PARK  
PARKING LOT

DETAILS  
C-407

DESIGNED BY: TC  
PREPARED BY: PBS

Project No.: 74252.000	Sheet No.:
Date: 3/7/2022	14 of 15
Scale: AS NOTED IF LESS THAN FULL SIZE, NTS	

# 74252.000 LINCOLN CITY SKATE PARK PARKING LOT

## Section 2721

### Engineered Surface Drainage Products

#### GENERAL

PVC surface drainage inlets shall include the drain basin type as indicated on the contract drawing and referenced within the contract specifications. The ductile iron grates for each of these fittings are to be considered an integral part of the surface drainage inlet and shall be furnished by the same manufacturer. The surface drainage inlets shall be as manufactured by Nyloplast a division of Advanced Drainage Systems, Inc., or prior approved equal.

#### MATERIALS

The drain basins required for this contract shall be manufactured from PVC pipe stock, utilizing a thermo-molding process to reform the pipe stock to the specified configuration. The drainage pipe connection stubs shall be manufactured from PVC pipe stock and formed to provide a watertight connection with the specified pipe system. This joint tightness shall conform to ASTM D3212 for joints for drain and sewer plastic pipe using flexible elastomeric seals. The flexible elastomeric seals shall conform to ASTM F477. The pipe bell spigot shall be joined to the main body of the drain basin or catch basin. The raw material used to manufacture the pipe stock that is used to manufacture the main body and pipe stubs of the surface drainage inlets shall conform to ASTM D1784 cell class 12454.

The grates and frames furnished for all surface drainage inlets shall be ductile iron for sizes 8", 10", 12", 15", 18", 24" and 30" and shall be made specifically for each basin so as to provide a round bottom flange that closely matches the diameter of the surface drainage inlet. Grates for drain basins shall be capable of supporting H-20 wheel loading for traffic areas or H-10 loading for pedestrian areas. 12" and 15" square grates will be hinged to the frame using pins. Metal used in the manufacture of the castings shall conform to ASTM A536 grade 70-50-05 for ductile iron. Grates shall be provided painted black.

#### INSTALLATION

The specified PVC surface drainage inlet shall be installed using conventional flexible pipe backfill materials and procedures. The backfill material shall be crushed stone or other granular material meeting the requirements of class 2 material as defined in ASTM D2321. Bedding and backfill for surface drainage inlets shall be placed and compacted uniformly in accordance with ASTM D2321. The drain basin body will be cut at the time of the final grade. No brick, stone or concrete block will be required to set the grate to the final grade height. For H-20 load rated installations, a concrete ring will be poured under and around the grate and frame. The concrete slab must be designed taking into consideration local soil conditions, traffic loading, and other applicable design factors. For other installation considerations such as migration of fines, ground water, and soft foundations refer to ASTM D2321 guidelines.

THIS PRINT DISCLOSES SUBJECT MATTER IN WHICH NYLOPLAST HAS PROPRIETARY RIGHTS. THE RECEIPT OR POSSESSION OF THIS PRINT DOES NOT CONFER, TRANSFER, OR LICENSE THE USE OF THE DESIGN OR TECHNICAL INFORMATION SHOWN HEREIN. REPRODUCTION OF THIS PRINT OR ANY INFORMATION CONTAINED HEREIN, OR MANUFACTURE OF ANY ARTICLE HEREFROM, FOR THE DISCLOSURE TO OTHERS IS FORBIDDEN, EXCEPT BY SPECIFIC WRITTEN PERMISSION FROM NYLOPLAST.

DRAWN BY	CJA	MATERIAL
DATE	3-10-00	
REVISED BY	EBC	PROJECT NO./NAME
DATE	2-8-10	
DWG SIZE	A	SCALE 1:1 SHEET 1 OF 1

**Nyloplast**  
3130 VERONA AVE  
BUFORD, GA 30518  
PHN (770) 932-2443  
FAX (770) 932-2490  
www.nyloplast-us.com

TITLE  
8 IN - 30 IN DRAIN BASIN SPECIFICATIONS  
DWG NO. 7001-110-011 REV F

## NON TRAFFIC INSTALLATION

### DRAIN BASIN

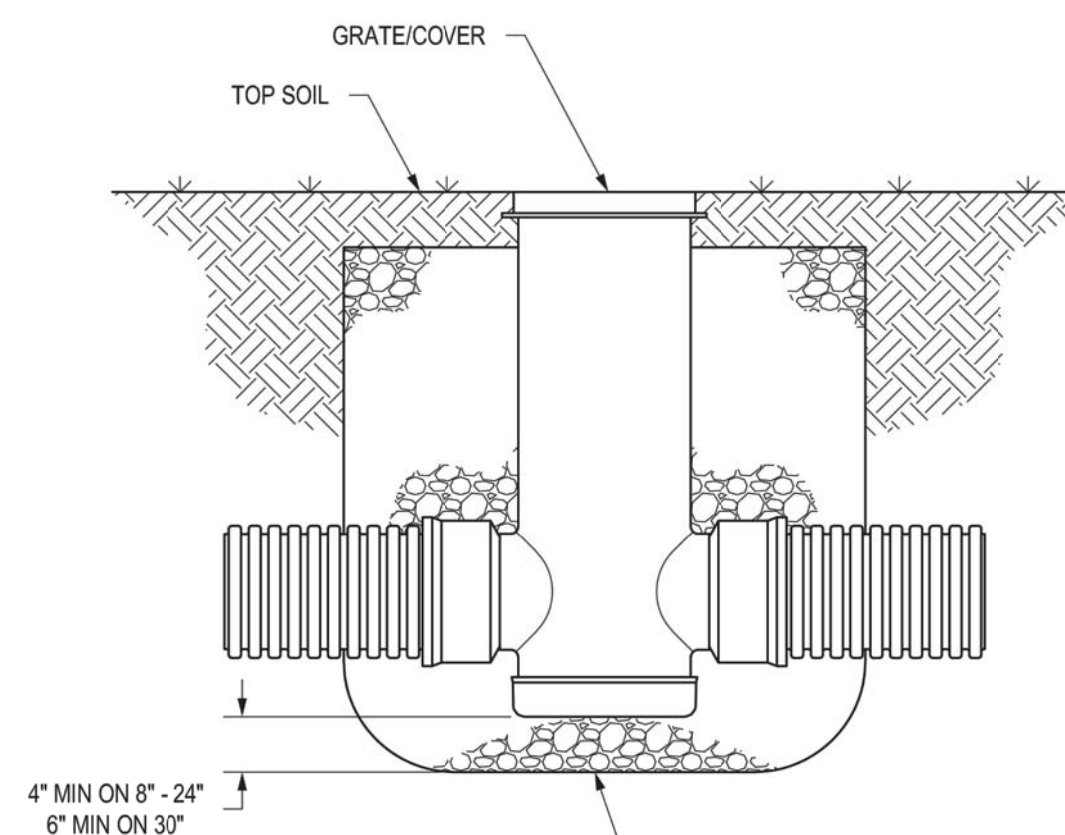

THE BACKFILL MATERIAL SHALL BE CRUSHED STONE OR OTHER GRANULAR MATERIAL MEETING THE REQUIREMENTS OF CLASS II MATERIAL AS DEFINED IN ASTM D2321, OR AS DETERMINED BY LOCAL STANDARDS & SITE ENGINEER. BEDDING & BACKFILL FOR SURFACE DRAINAGE INLETS SHALL BE PLACED & COMPACTED UNIFORMLY IN ACCORDANCE WITH ASTM D2321.

### INLINE DRAIN

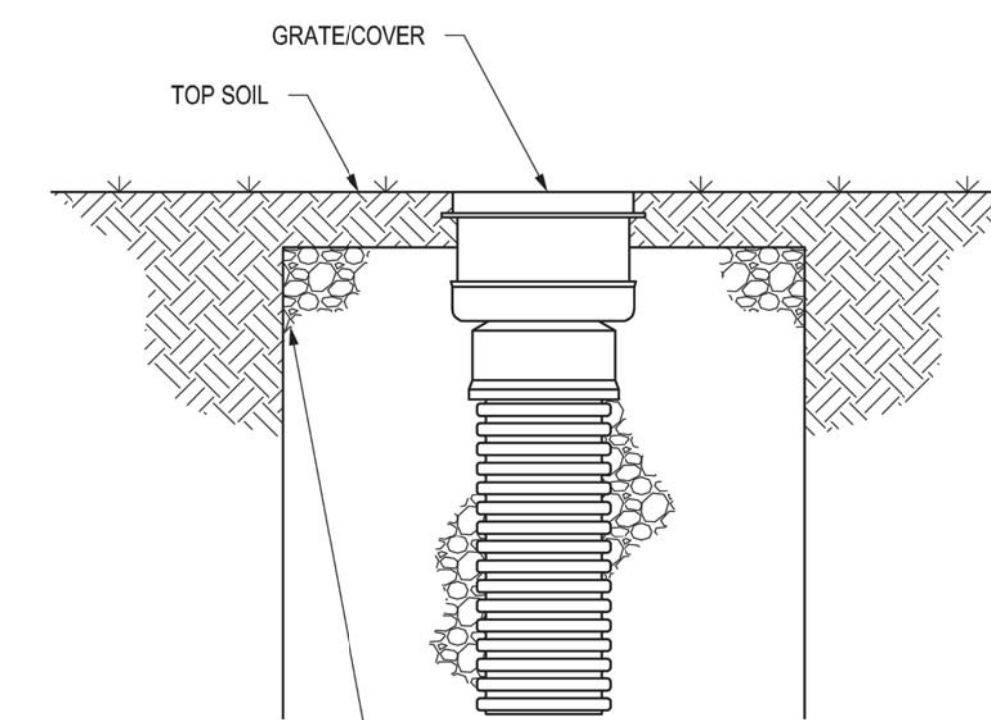

THE BACKFILL MATERIAL SHALL BE CRUSHED STONE OR OTHER GRANULAR MATERIAL MEETING THE REQUIREMENTS OF CLASS II MATERIAL AS DEFINED IN ASTM D2321, OR AS DETERMINED BY LOCAL STANDARDS & SITE ENGINEER. BEDDING & BACKFILL FOR SURFACE DRAINAGE INLETS SHALL BE PLACED & COMPACTED UNIFORMLY IN ACCORDANCE WITH ASTM D2321.

THIS PRINT DISCLOSES SUBJECT MATTER IN WHICH NYLOPLAST HAS PROPRIETARY RIGHTS. THE RECEIPT OR POSSESSION OF THIS PRINT DOES NOT CONFER, TRANSFER, OR LICENSE THE USE OF THE DESIGN OR TECHNICAL INFORMATION SHOWN HEREIN. REPRODUCTION OF THIS PRINT OR ANY INFORMATION CONTAINED HEREIN, OR MANUFACTURE OF ANY ARTICLE HEREFROM, FOR THE DISCLOSURE TO OTHERS IS FORBIDDEN, EXCEPT BY SPECIFIC WRITTEN PERMISSION FROM NYLOPLAST.

DRAWN BY	CJA	MATERIAL
DATE	9-30-99	
REVISED BY	EBC	PROJECT NO./NAME
DATE	2-24-10	
DWG SIZE	A	SCALE 1:25 SHEET 1 OF 1

**Nyloplast**  
3130 VERONA AVE  
BUFORD, GA 30518  
PHN (770) 932-2443  
FAX (770) 932-2490  
www.nyloplast-us.com

TITLE  
DRAIN BASIN & INLINE DRAIN  
NON TRAFFIC INSTALLATION  
DWG NO. 7001-110-111 REV D

## NYLOPLAST DRAIN BASIN WITH DOME GRATE

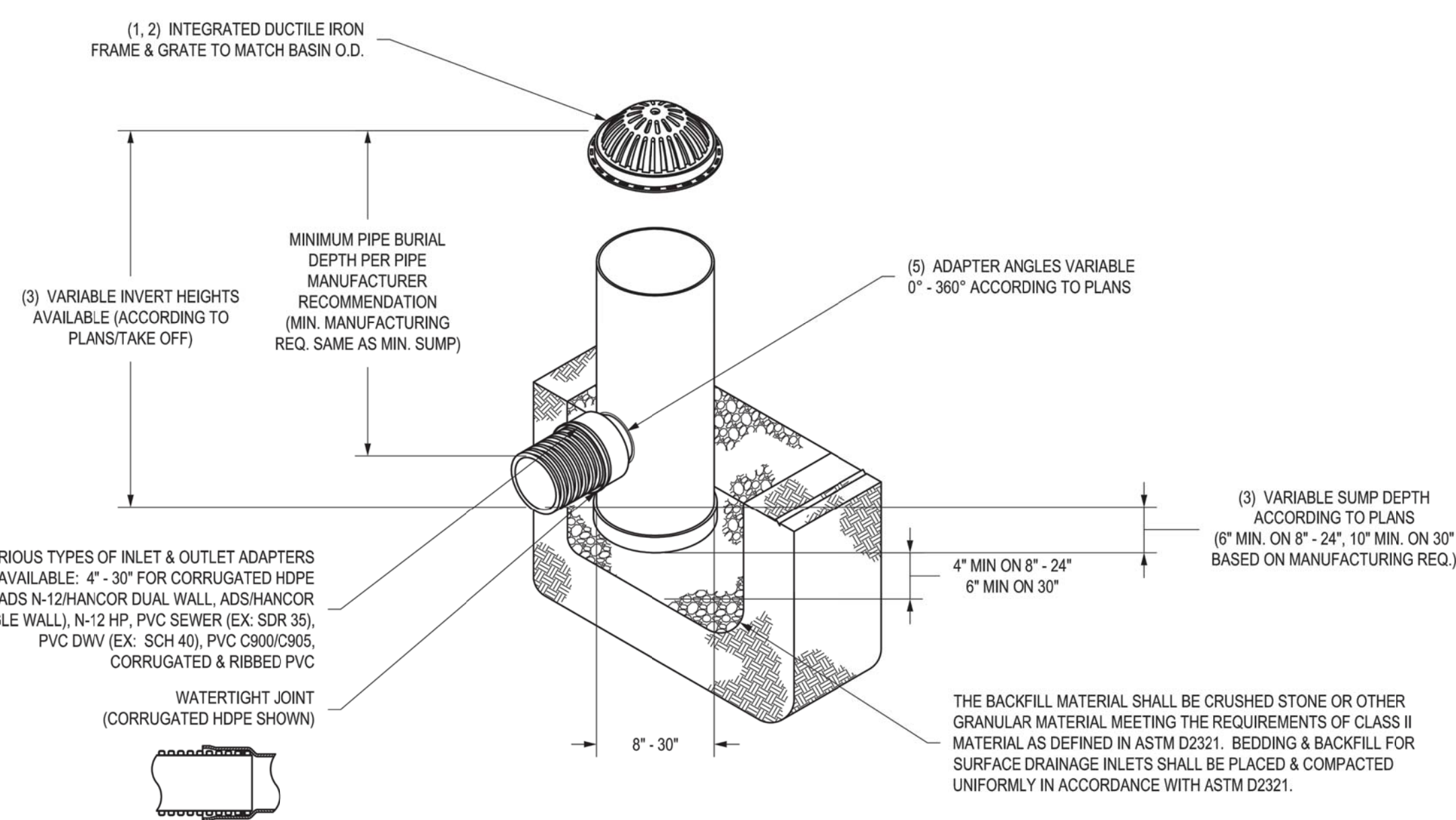

- 8" - 30" DOME GRATES SHALL BE DUCTILE IRON PER ASTM A536 GRADE 70-50-05.
- 12" - 30" FRAMES SHALL BE DUCTILE IRON PER ASTM A536 GRADE 70-50-05.
- 8" & 10" DOME GRATES FIT DIRECTLY ONTO DRAIN BASINS WITH THE USE OF A PVC BODY TOP. SEE DRAWING NO. 7001-110-045.
- DRAIN BASIN TO BE CUSTOM MANUFACTURED ACCORDING TO PLAN DETAILS. RISERS ARE NEEDED FOR BASINS OVER 84" DUE TO SHIPPING RESTRICTIONS. SEE DRAWING NO. 7001-110-046.
- DRAINAGE CONNECTION STUB JOINT TIGHTNESS SHALL CONFORM TO ASTM D3212 FOR CORRUGATED HDPE (ADS N-12 HANCOR DUAL WALL), N-12 HP, & PVC SEWER (4" - 24").
- ADAPTERS CAN BE MOUNTED ON ANY ANGLE 0° TO 360°. TO DETERMINE MINIMUM ANGLE BETWEEN ADAPTERS SEE DRAWING NO. 7001-110-012.
- 8" - 30" DOME GRATES HAVE NO LOAD RATING.

THIS PRINT DISCLOSES SUBJECT MATTER IN WHICH NYLOPLAST HAS PROPRIETARY RIGHTS. THE RECEIPT OR POSSESSION OF THIS PRINT DOES NOT CONFER, TRANSFER, OR LICENSE THE USE OF THE DESIGN OR TECHNICAL INFORMATION SHOWN HEREIN. REPRODUCTION OF THIS PRINT OR ANY INFORMATION CONTAINED HEREIN, OR MANUFACTURE OF ANY ARTICLE HEREFROM, FOR THE DISCLOSURE TO OTHERS IS FORBIDDEN, EXCEPT BY SPECIFIC WRITTEN PERMISSION FROM NYLOPLAST.

DRAWN BY	EBC	MATERIAL
DATE	3-25-10	
APP'D BY	EBC	PROJECT NO./NAME
DATE	3-25-10	
DWG SIZE	A	SCALE 1:40 SHEET 1 OF 1

**Nyloplast**  
3130 VERONA AVE  
BUFORD, GA 30518  
PHN (770) 932-2443  
FAX (770) 932-2490  
www.nyloplast-us.com

TITLE  
DRAIN BASIN WITH DOME GRATE  
QUICK SPEC INSTALLATION DETAIL  
DWG NO. 7001-110-397 REV A

#### General Notes

OWNER: LINCOLN CITY  
CITY OF LINCOLN CITY  
801 SW HIGHWAY 101  
PO BOX 50  
LINCOLN CITY, OREGON 97367

CONTACT: TERRY CHAMBERLIN, P.E.  
PHONE: 541.996.1292



No.	Revision/Issue	Date

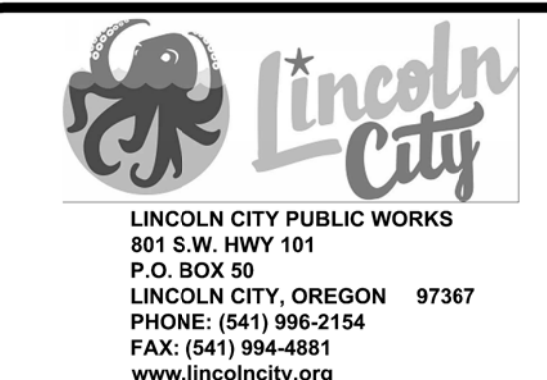

Project Name and Sheet Name  
LINCOLN CITY SKATE PARK  
PARKING LOT  
DETAILS  
C-408  
DESIGNED BY: TC  
PREPARED BY: PBS

Project No.:	74252.000	Sheet No.	15 OF 15
Date:	3/7/2022		
Scale:	AS NOTED IF LESS THAN FULL SIZE, NTS		