

## SITE PLAN OVERVIEW

A PARTITION OF THAT PROPERTY DESCRIBED IN LCDR 2022-09799, BEING TAX LOT 101 OF TAX ASSESSOR'S MAP 07-11-27BD LOCATED IN THE NORTHWEST 1/4 OF SECTION 27, TOWNSHIP 7 SOUTH, RANGE 11 WEST OF THE WILLAMETTE MERIDIAN, LINCOLN COUNTY, OREGON.

FOR: KR CINEMAS LLC  
3755 SE HIGH SCHOOL DRIVE

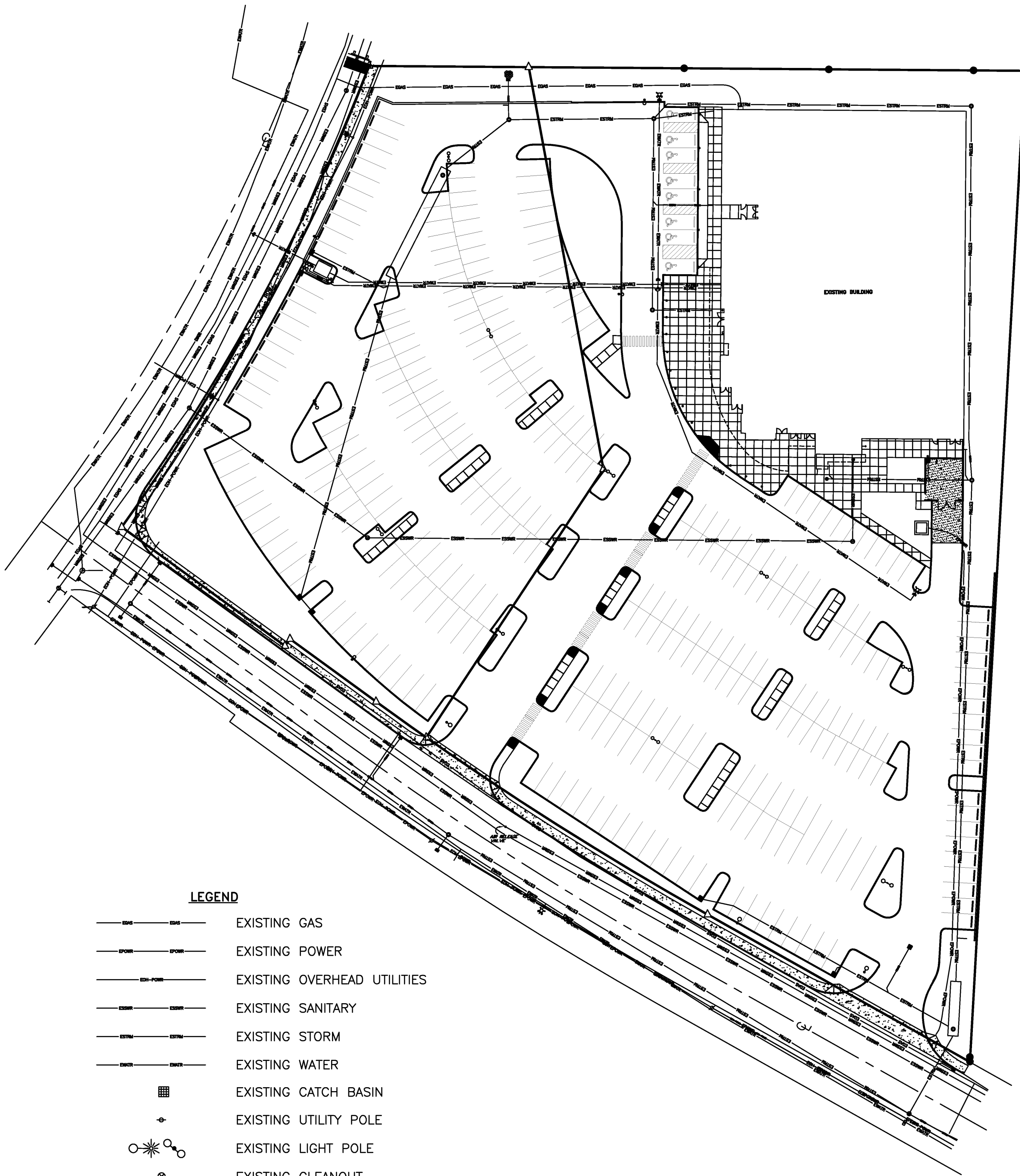

### LEGEND

	EXISTING GAS
	EXISTING POWER
	EXISTING OVERHEAD UTILITIES
	EXISTING SANITARY
	EXISTING STORM
	EXISTING WATER
	EXISTING CATCH BASIN
	EXISTING UTILITY POLE
	EXISTING LIGHT POLE
	EXISTING CLEANOUT
	EXISTING SANITARY MANHOLE
	EXISTING STORM MANHOLE
	EXISTING WATER METER
	EXISTING WATER VALVE
	EXISTING FIRE HYDRANT
	EXISTING GAS VALVE

**NOTE:**  
A TOPOGRAPHIC SURVEY WAS NOT PERFORMED ON THIS SITE. THE IMPROVEMENTS AND UTILITIES SHOWN ARE BASED STRICTLY OFF THE CONSTRUCTION DRAWINGS USED FOR DEVELOPING THE SITE.

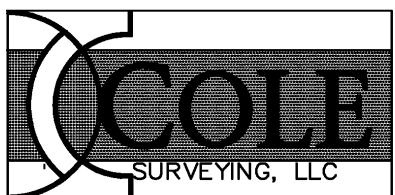
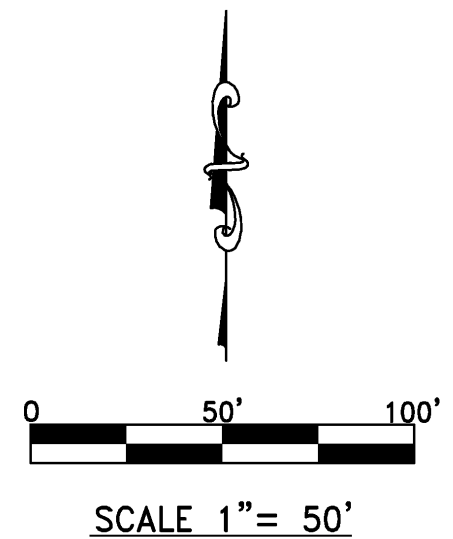

PREPARED BY  
COLE SURVEYING, LLC  
2595 NE BELVUE STREET  
P.O. BOX 1211  
CORVALLIS, OREGON 97339  
(541) 257-1019