

SE 19th Street Hwy 101 to Lee St. Overlay and Curb Ramps

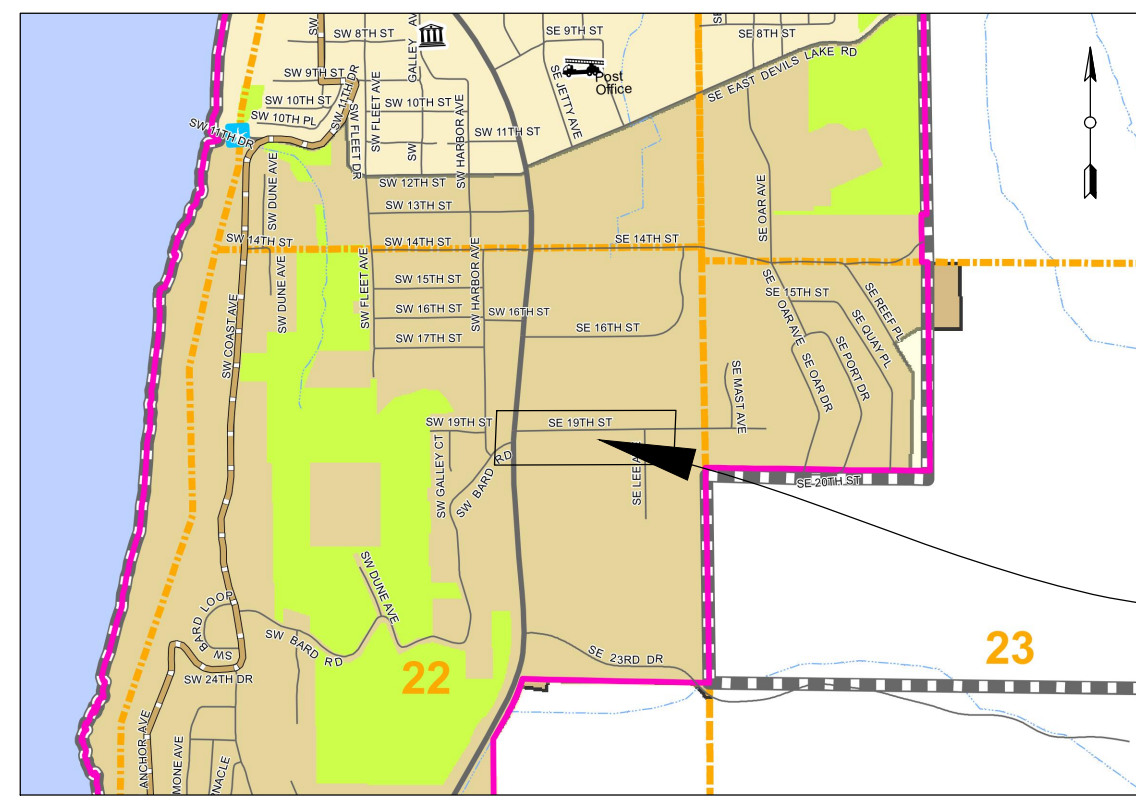

LINCOLN CITY VICINITY MAP

Project Site

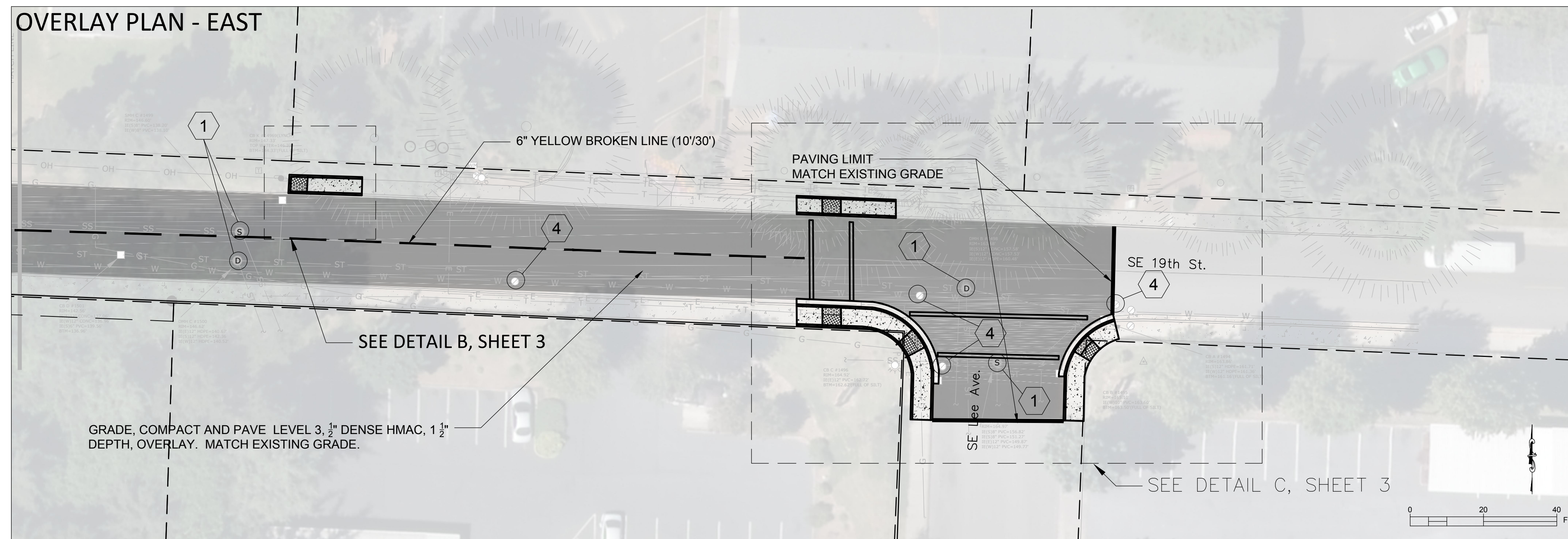
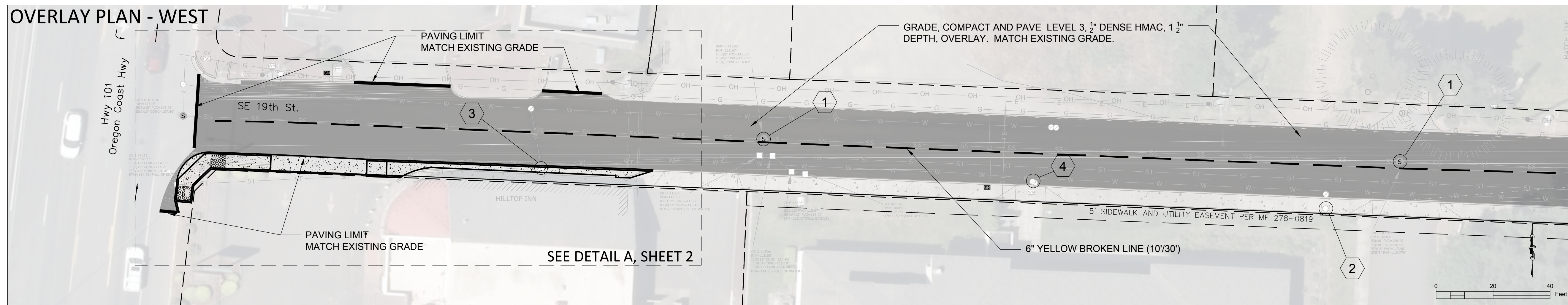

LEGEND - EXISTING FEATURES

- - FOUND SURVEY MONUMENT
 - ▲ - SURVEY CONTROL POINT
 - - CATCH BASIN
 - - WATER VALVE
 - ⊞ - WATER METER
 - ⊞ - SANITARY SEWER MANHOLE
 - ⊞ - STORM DRAIN MANHOLE
 - ⊞ - CLEAN OUT
 - ⊞ - IRRIGATION CONTROL VALVE
 - ⊞ - GAS VALVE
 - ⊞ - GAS METER
 - ⊞ - MAIL BOX
 - ⊞ - LUMINAIRE
 - ⊞ - TV RISER
 - ⊞ - TELEPHONE RISER
 - ⊞ - SIGNAL JUNCTION BOX
 - ⊞ - ELECTRIC METER
 - ⊞ - ELECTRIC JUNCTION BOX
 - ⊞ - UTILITY POLE
 - ⊞ - GUY ANCHOR
 - ⊞ - FIRE HYDRANT
 - ⊞ - SIGN
 - - LINE CONTINUES TO UNKNOWN LOCATION
 - E - UNDERGROUND ELECTRIC LINE
 - ST - UNDERGROUND STORM DRAIN LINE
 - SS - UNDERGROUND SANITARY SEWER LINE
 - T - UNDERGROUND TELEPHONE LINE
 - TV - UNDERGROUND CABLE TV LINE
 - W - UNDERGROUND WATER LINE
 - G - UNDERGROUND NATURAL GAS LINE
 - OH - OVERHEAD UTILITY LINE
 - F - FENCE LINE
 - SMH - SANITARY SEWER MANHOLE
 - DMH - STORM DRAIN MANHOLE
 - CB - CATCH BASIN
 - FI - FIELD INLET
 - - CONCRETE
 - - ASPHALT
 - - DECIDUOUS TREE (DTR)
 - - EVERGREEN TREE (ETR)
- EXAMPLE
DIAMETER ↑ TYPE ↑ NO. OF TREES FROM ONE BASE

CONSTRUCTION NOTES

- 1 ADJUST EXISTING MANHOLE.
- 2 MOVE HYDRANT SOUTH OF WALK. RESTORE CONCRETE SURFACE OF WALK.
- 3 ADJUST EXISTING WATER METER.
- 4 ADJUST EXISTING VALVE.

General Notes

OWNER:

CITY OF LINCOLN CITY
801 SW HIGHWAY 101
PO BOX 50
LINCOLN CITY, OREGON
97337
CONTACT: TERRY
CHAMBERLIN, PE
541 996-1292

All utilities shall be potholed as necessary. See note 12, sheet 4 potholed utilities incidental to various bid items

UTILITY LOCATE:

(48 HOUR NOTICE PRIOR TO EXCAVATION)
OREGON LAW REQUIRES YOU TO FOLLOW THE RULES ADOPTED BY THE OREGON UTILITY NOTIFICATION CENTER. THOSE RULES ARE SET FORTH IN OAR 952-001-0010 THROUGH 757.562 AND ORS 757.993. YOU MAY OBTAIN COPIES OF THE RULES FROM THE CENTER BY CALLING (503) 246-1987. ONE CALL SYSTEM NUMBER 1-800-332-2344.

REGISTERED PROFESSIONAL ENGINEER
11687
OREGON
JULY 18, 1982
TERRY CHAMBERLIN
EXPIRES: 12/31/2017

No.	Revision/Issue	Date

City of Lincoln City
LINCOLN CITY PUBLIC WORKS
801 S.W. HWY 101
P.O. BOX 50
LINCOLN CITY, OREGON 97367
PHONE: (541) 996-2154
FAX: (541) 994-4881
www.lincolncity.org

Project Name and Address
SE 19th Street
Hwy 101 to Lee St.
Overlay and Curb Ramps
Designed: NLS
Checked: TPC
IF LESS THAN FULL SIZE,
NTS

Project	16005	Sheet	1 of 4
Date	4/7/17		
Scale	1" = 20'		

10000 SL 1501 DESIGN.DWG 01/27/17

DETAIL B - DEMOLITION

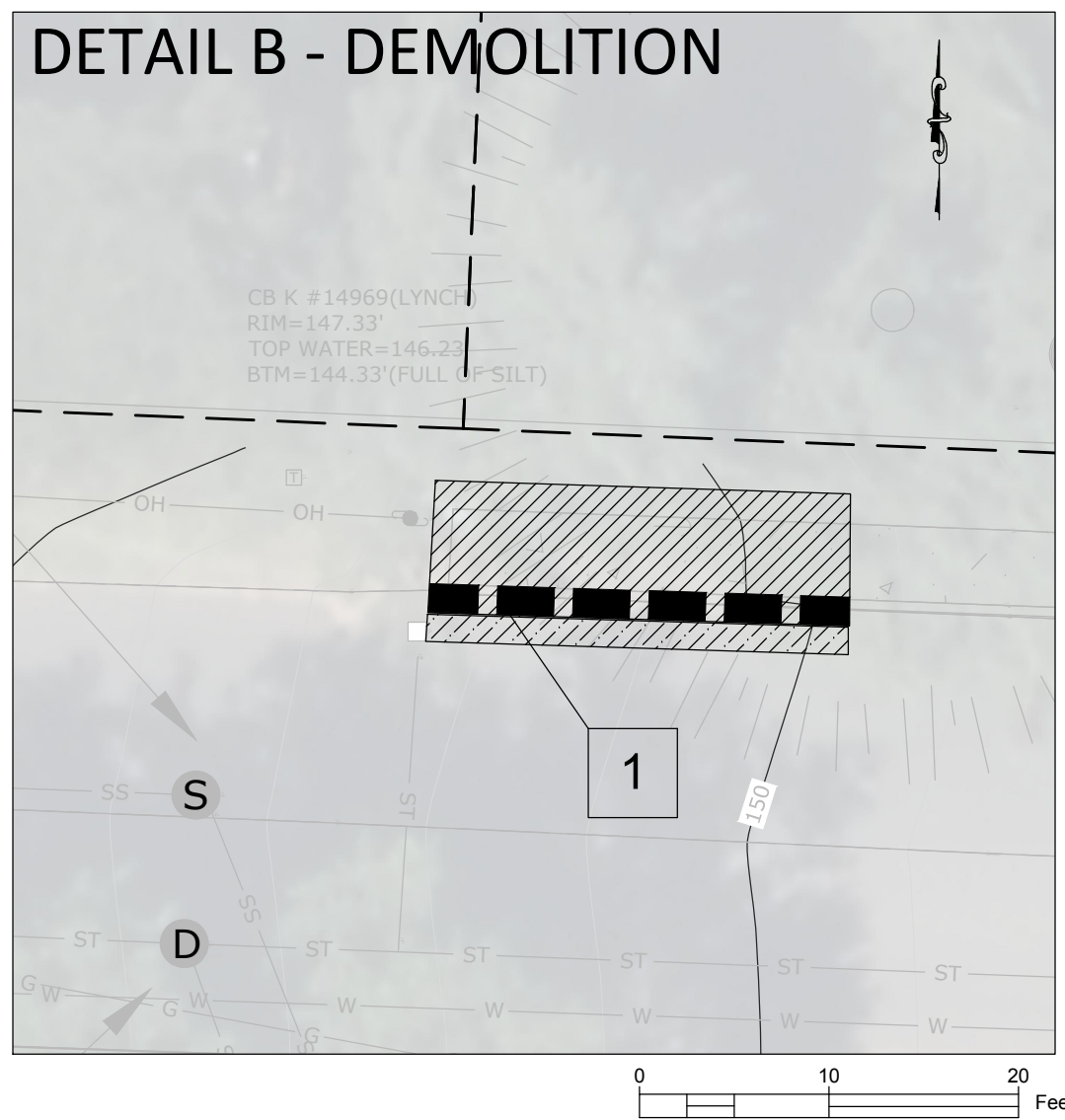

DETAIL B - PLAN

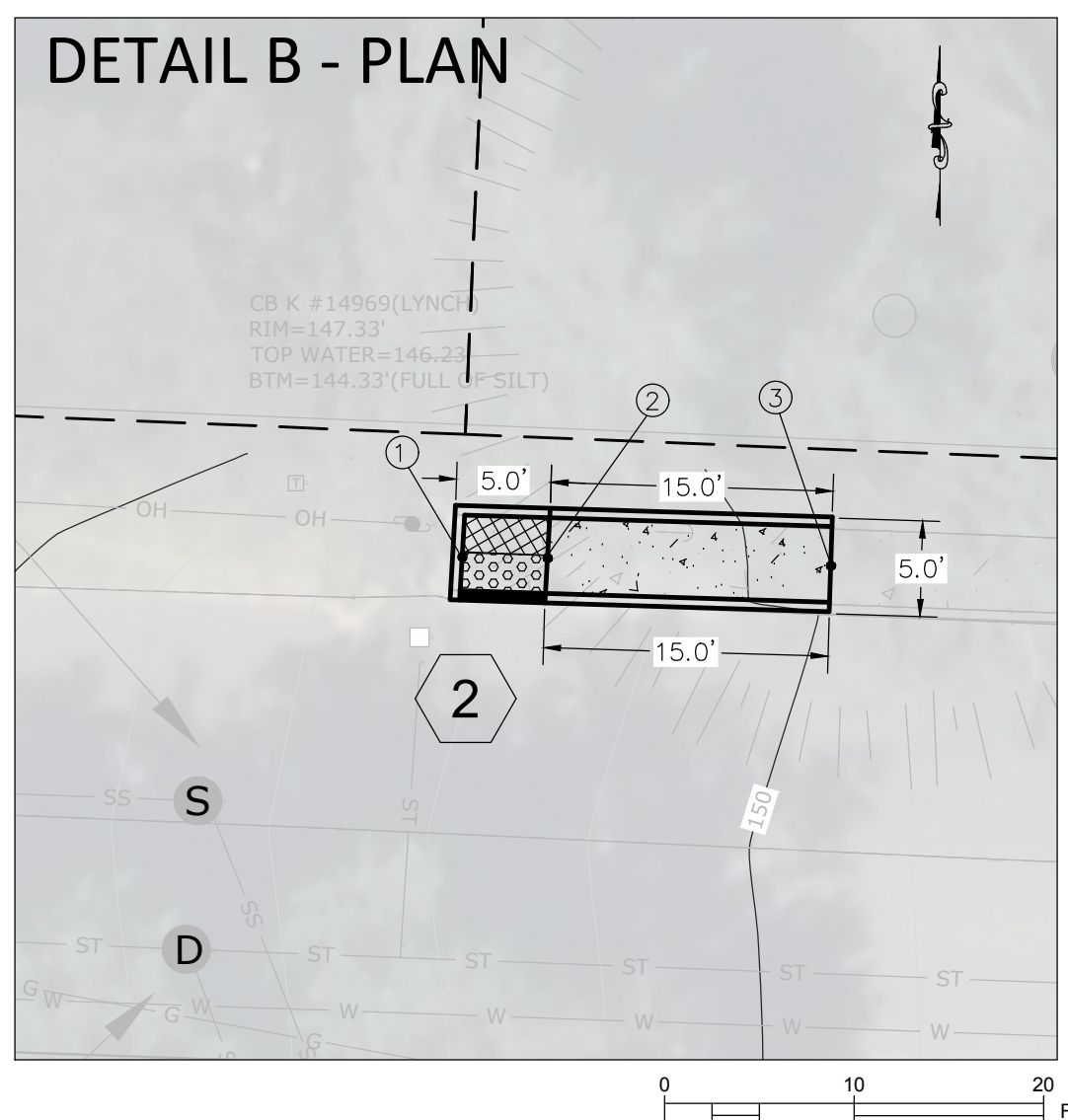

DEMOLITION NOTES

- 1 REMOVE/DISPOSE OF EXISTING CURB AND WALK TO ACCOMMODATE NEW CURB RAMP AND WALK.
- 2 TRIM EXISTING VEGETATION TO ACCOMMODATE NEW CURB AND WALK.
- 3 PRESERVE EXISTING BLOCK WALL

CONSTRUCTION NOTES

- 1 INSTALL 24" STANDARD CURB AND GUTTER. SEE ODOT STD. DRG RD700.
- 2 INSTALL SIDEWALK RAMP AND TURNING SPACE PER ODOT STD DRG RD752, OPTION F. POSITIVE FLOWLINE DRAINAGE SHALL BE MAINTAINED IN THE PEDESTRIAN ACCESS ROUTE AT A 2% MAXIMUM SLOPE. NO PONDING SHALL BE PRESENT IN THE PEDESTRIAN ACCESS ROUTE. ANY VERTICAL LIP AT THE FLOWLINE SHALL NOT BE GREATER THAN 1/4 INCH.
- 3 INSTALL PARALLEL SIDEWALK RAMP PER ODOT STD DRG RD755
- 4 EXPOSED STANDARD CURB, MAXIMUM REVEAL 6"; TAPER FRONT CURB 6' TO RAMPS. SEE SHEET 4, DETAIL A
- 5 INSTALL 6" STANDARD CURB SOUTH OF EXISTING INLETS. SEE ODOT STD. DRG RD700.

ELEVATION TABLE

#	EXISTING FL	FL	TBC	BACK OF WALK
1	147.77	148.01		148.08
2	148.31	148.08		148.15
3	150.06	MEET EXISTING ELEVATIONS		
4	161.03	MEET EXISTING ELEVATIONS		
5	161.54	161.8		161.87
6	161.87	161.87		161.94
7	162.41	MEET EXISTING ELEVATIONS		
8	161.22	MEET EXISTING ELEVATIONS		
9	161.65	161.88		161.95
10	162.02	161.95		162.02
13	163.38	163.64		163.71
14	163.98	163.71		163.78
15	166.06	MEET EXISTING ELEVATIONS		
16	166.58	MEET EXISTING ELEVATIONS		
17	164.63	164.33		164.4
18	164.17	164.4		164.47
19	163.92	MEET EXISTING ELEVATIONS		

** SEE SHEET 1 FOR OVERLAY AND STRIPING DETAILS.

DETAIL C - DEMOLITION

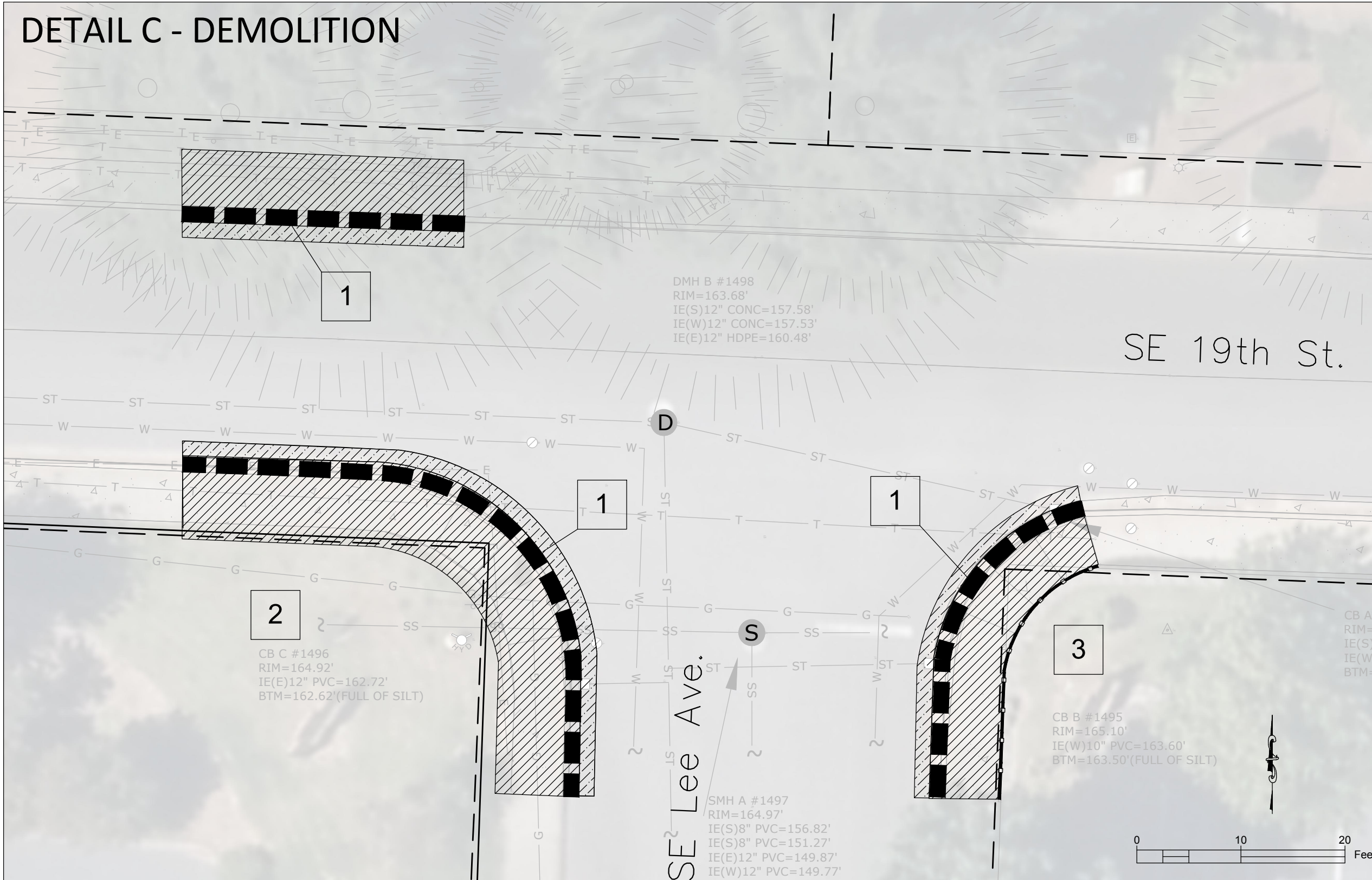

DETAIL C - PLAN

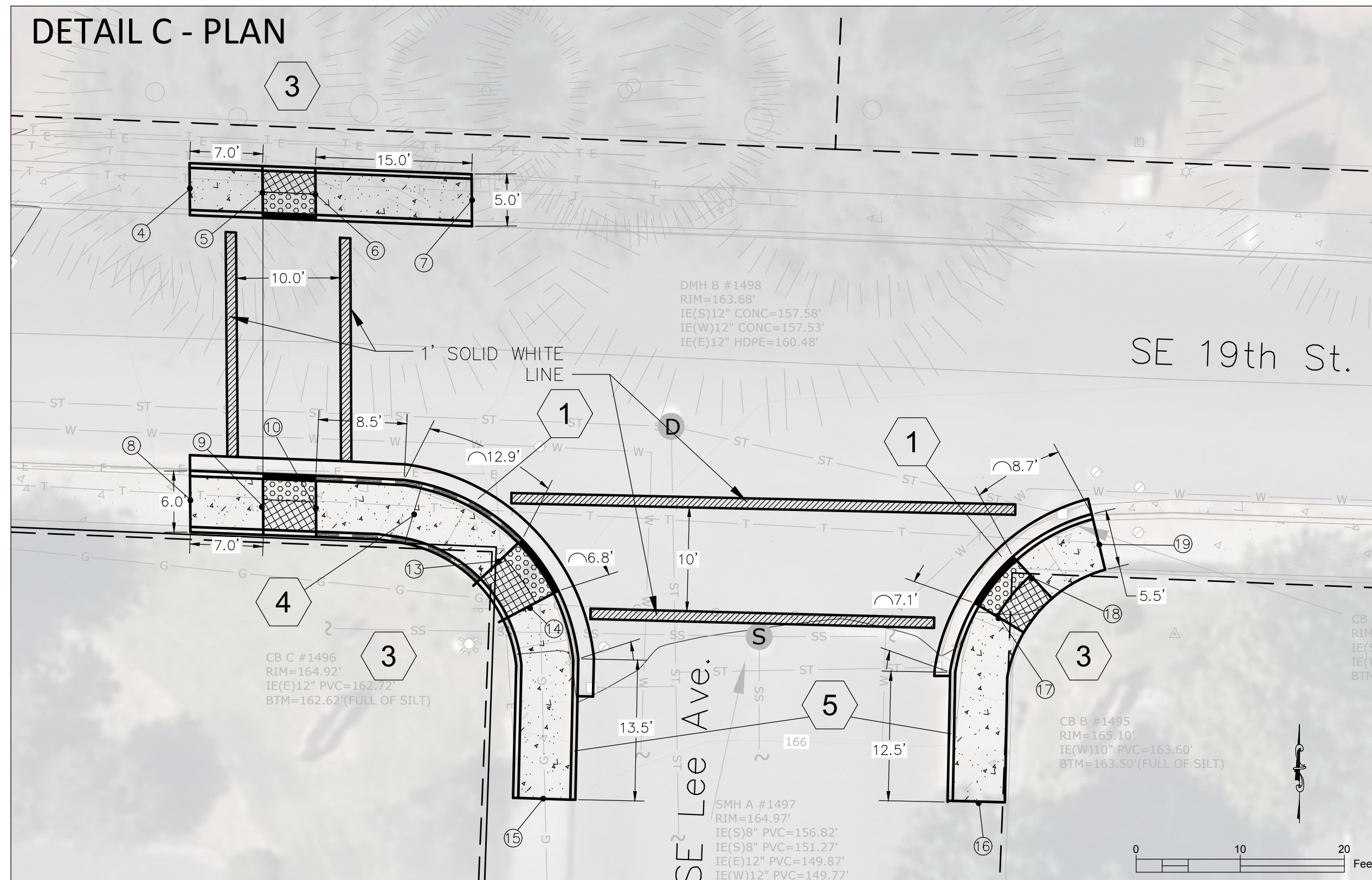

- CONSTRUCT TURNING SPACE WITH MINIMUM LEVEL AREA 4'X4'. MAXIMUM 2.0% FINISHED SURFACE SLOPE.
- INSTALL TRUNCATED DOME DETECTABLE WARNING SURFACE PER ODOT STD. DRG. RD759
- GRADE, COMPACT AND PAVE LEVEL 3, 1/2" DENSE HMAC, 1 1/2" DEPTH OVERLAY, MATCH EXISTING GRADE.
- REMOVE/DISPOSE OF EXISTING CONCRETE CURB AND WALK AS SHOWN.
- SAWCUT AND REMOVE/DISPOSE EXISTING AC AS SHOWN AND PAVE BACK AS NEEDED FOR CONCRETE WORK.

General Notes

OWNER:

CITY OF LINCOLN CITY
801 SW HIGHWAY 101
PO BOX 50
LINCOLN CITY, OREGON
97367
CONTACT: TERRY
CHAMBERLIN, PE
541 996-1292

All utilities shall be potholed as necessary. See note 12, sheet 4 potholed utilities incidental to various bid items

UTILITY LOCATE:

(48 HOUR NOTICE PRIOR TO EXCAVATION)
OREGON LAW REQUIRES YOU TO FOLLOW THE RULES ADOPTED BY THE OREGON UTILITY NOTIFICATION CENTER. THOSE RULES ARE SET FORTH IN OAR 952-001-0010 THROUGH 757.562 AND ORS 757.993. YOU MAY OBTAIN COPIES OF THE RULES FROM THE CENTER BY CALLING (503) 246-1987. ONE CALL SYSTEM NUMBER 1-800-332-2344.

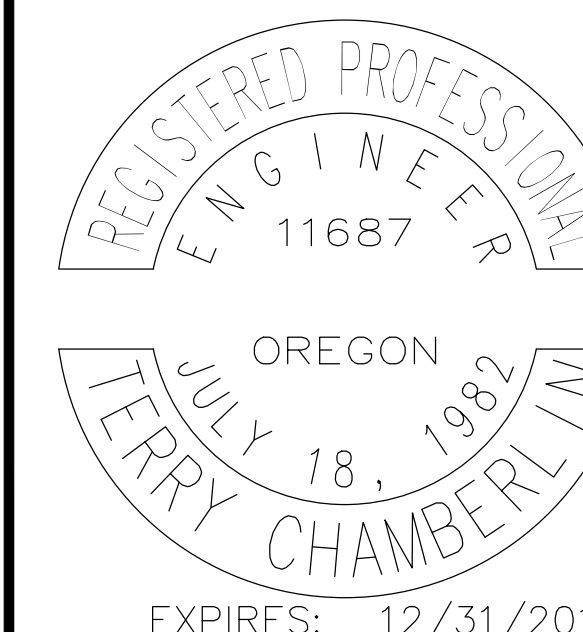

No.	Revision/Issue	Date

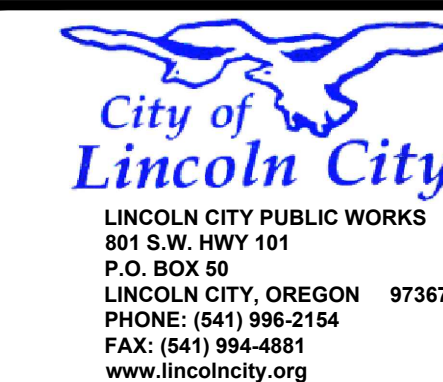

Project Name and Address
SE 19th Street
Hwy 101 to Lee St.
Overlay and Curb Ramps
Designed: NLS
Checked: TPC
IF LESS THAN FULL SIZE,
NTS

Project	16005	Sheet	3 of 4
Date	4/7/17		
Scale	1" = 10'		

10000 SL 1201 Design.dwg 01/27/17

GENERAL NOTES

- Contractor shall procure and conform to all construction permits required by the City of Lincoln City.
- Contractor shall provide all bonds and insurance required by the City.
- Unless otherwise approved by the Public Works Director, construction of all public facilities shall be done between 7:00 a.m. and 7:00 p.m., Monday through Friday.
- The Contractor shall perform all work necessary to complete the project in accordance with the approved construction drawings including such incidentals as may be necessary to meet applicable agency requirements and provide a completed project.
- Contractor to notify City, County, and all utility companies a minimum of 48 business hours (2 business days) prior to start of construction, and comply with all other requirements of ORS 757.541 to 757.571.
- Any inspection by the City, County or other agencies shall not, in any way, relieve the Contractor from any obligation to perform the work in strict compliance with the applicable codes and agency requirements.
- Contractor shall erect and maintain barricades, warning signs, traffic cones per City and County requirements in accordance with the MUTCD (including Oregon amendments). Access to driveways shall be maintained at all times. All traffic control measures shall be approved and in place prior to any construction activity.
- Record Drawings. The Contractor shall maintain one complete set of approved drawings on the construction site at all times whereon he will record any approved deviations in construction from the approved drawings, as well as the station locations and depths of all existing utilities encountered. These field record drawing shall be kept up to date at all times and shall be available for inspection by the City upon request.
- Upon completion of construction of public facilities, Contractor shall submit a clean set of field record drawings containing all as-built information to the City.
- Contractor shall perform work in compliance with the City of Lincoln City Public Works Department Design Standards and 2015 ODOT/APWA Oregon Standard Specifications for Construction.

EXISTING UTILITIES + FACILITIES

- ATTENTION: Oregon law requires you to follow rules adopted by the Oregon Utility Notification Center. Those rules are set forth in OAR 952-001-0010 through OAR 952-001-0090. You may obtain copies of the rules by calling the center. (Note: the telephone number for the Oregon Utility Notification Center is (503) 232-1987).
- The location and descriptions of existing utilities shown on the drawings are compiled from available records and/or field surveys. The engineer or utility companies do not guarantee the accuracy or the completeness of such records. Contractor shall field verify sizes and locations of all existing utilities prior to construction.
- The Contractor shall locate and mark all existing property and street monuments prior to construction. Any monuments disturbed during construction of the project shall be replaced by the Registered Land Surveyor at the Contractors expense. The monuments shall be replaced within a maximum of 90 days, and the County Surveyor shall be notified in writing as required by ORS 209.150.
- All existing facilities shall be maintained in-place by the Contractor unless otherwise shown or directed. Contractor shall take all precautions necessary to support, maintain, or otherwise protect existing utilities and other facilities at all times during construction. Contractor to leave existing facilities in an equal or better-than-original condition and to the satisfaction of the City Engineer.
- Utilities, or interfering portions of utilities, that are abandoned in place shall be removed by the Contractor to the extent necessary to accomplish the work. The Contractor shall plug the remaining exposed ends of abandoned utilities.
- Contractor shall remove all existing signs, mailboxes, fences, landscaping, etc., As required to avoid damage during construction and replace them to existing or better condition.

GRADING, PAVING, + DRAINAGE NOTES

- There is no soils report available for this project.
- The Contractor shall be responsible for managing construction activities to insure that public streets and right-of-ways are kept clean of mud, dust or debris. Dust abatement shall be maintained by adequate watering of the site by the Contractor.
- Unless otherwise noted, all grading, rocking and paving to conform to ODOT/APWA specifications, current edition.
- Crushed rock shall conform to the requirements of ODOT/APWA 02630.10 (Dense Graded base aggregate) Compact to 95% of the maximum dry density per AASHTO T-180 test method (Modified Proctor).
- All pavement cuts will require restoration following :1.00 Special Provisions (T-Cut Restoration Requirements) CDF (Controlled Density Fill) or backfill material shall be sand blend trench fill with 3/4" rock compacted to a minimum of 95% of the maximum density of the material placed in 6" lifts. Joints in the travel lane are to at the curb & gutter, center of the travel lane, and/or at the nearest longitudinal joint. 1.03 All cuts in pavement shall be full depth saw cuts. A minimum compacted thickness of 4" or the thickness of the removed pavement, whichever is greater. Pavement to be compacted in 2" lifts. 1.04 Cut areas shall be cold patched at the end of the workday and patch maintained. Cold patched areas shall be hot patched within 10 days. All cold patch material to be excavated prior to hot patch restoration. 1.05 Pavement grinding shall conform to Standard Specifications for Highway Construction, Cold Plane Pavement Removal. Pavement surface shall be uniformly milled using equipment that is capable of accurately establishing profile grades within a tolerance of 1/4" (or 6mm) by reference from either the existing pavement or independent grade control. 1.06 Asphalt emulsion tack coat shall be used to seal the asphalt to the edges of the existing asphalt. All cut areas shall be sealed with an ODOT approved polymer asphalt sealant. 1.07 All existing pavement markings and legends are to be restored with like kind. 1.08 Applicant shall accept responsibility for pavement stress or settlement of the "T"-Cut restoration section for a period of 2 years.

TRAFFIC MANAGEMENT NOTES

When construction activities block or interfere with normal pedestrian routing, provide safe passage for pedestrians either through the construction, or rerouted around the construction, utilizing ODOT standard drawing TM844 and the requirements of the 2015 Oregon standard specifications for construction (brown book), page 141, subsection 00220.02, 8th bulleted item with reference to the subsequent bulleted items.

When construction activities block or interfere with normal open state highway shoulder conditions, and these impacts last longer than 72 hours, follow the temporary signing and delineation requirements of ODOT standard drawings TM800, TM843 (right lane closure - omit taper "1" for shoulder closure) and TM851 (shoulder closure) configuration.

Any abrupt edge greater than 2 inches in depth, closer than 4 feet from an active traffic lane, and having a duration longer than 72 hours, shall be required to follow the "Typical Abrupt Edges Signing Detail" on ODOT standard drawing TM800.

When construction activities block or interfere with shoulders or bike lanes, install a 48 inch "Bicycles on Roadway" sign in advance of each shoulder or bike lane closure at sign spacing "a" from the "TCD spacing table" shown on ODOT standard drawing TM800.

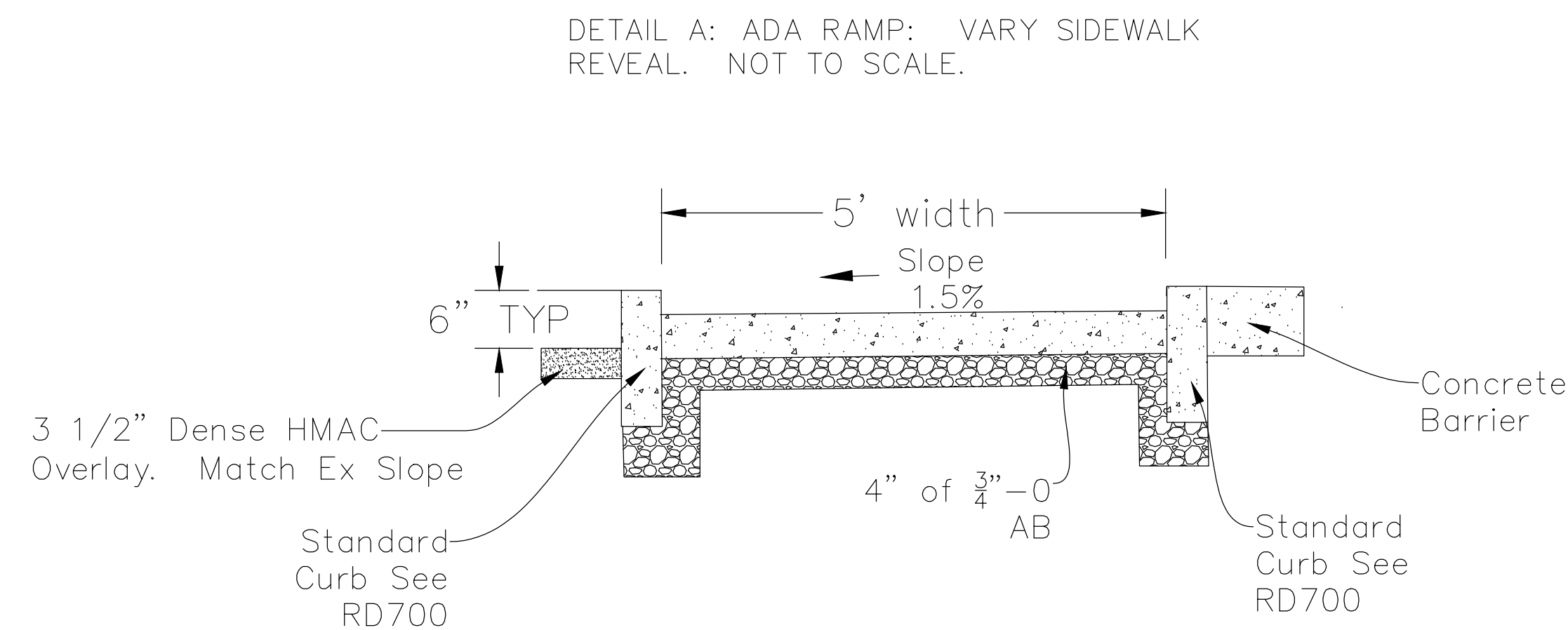

General Notes

OWNER:

CITY OF LINCOLN CITY
801 SW HIGHWAY 101
PO BOX 50
LINCOLN CITY, OREGON
97367
CONTACT: TERRY
CHAMBERLIN, PE
541 996-1292

UTILITY LOCATE:

(48 HOUR NOTICE PRIOR TO EXCAVATION)

OREGON LAW REQUIRES YOU TO FOLLOW THE RULES ADOPTED BY THE OREGON UTILITY NOTIFICATION CENTER. THOSE RULES ARE SET FORTH IN OAR 952-001-0010 THROUGH 757.562 AND ORS 757.993. YOU MAY OBTAIN COPIES OF THE RULES FROM THE CENTER BY CALLING (503) 246-1987. ONE CALL SYSTEM NUMBER 1-800-332-2344.



No.	Revision/Issue	Date



Project Name and Address
SE 19th Street
Hwy 101 to Lee St.
Overlay and Curb Ramps
Designed: NLS
Checked: TPC
IF LESS THAN FULL SIZE,
NTS

Project	16005	Sheet	4 of 4
Date	4/7/17		
Scale	NO SCALE		

10000 SL 121111 DESIGN.DWG 01/27/16/11