

1
2
3 **RESOLUTION NO. 2023-05**

4 **A RESOLUTION OF THE CITY OF LINCOLN CITY ESTABLISHING TRAFFIC CONTROL**
5 **MEASURES FOR A PORTION OF SW 3rd STREET AT SW EBB AVENUE**

6 **RECITALS**

7
8 Pursuant to LCMC 10.08.010, the City Council may exercise Traffic Control authority by
9 Resolution of the Council or the City Manager may exercise such authority by written order.

10
11 The establishment of traffic controls, including but not limited to limitations on right and left
12 turns is expressly listed as within the authority of the City Council.

13
14 In July 2022, the City Council reviewed and approved a public improvement contract for the
15 construction of the SW 3rd and Highway 101 Beacon Project. The Agenda item summarized
16 this +/- \$480,000.00 project as follows:

17
18 *The project will improve the sidewalk ramps at [SW] 3rd and Hwy 101 to meet ADA*
19 *requirements. A pedestrian flashing beacon crossing will be added on Hwy 101. SW 3rd Ave*
20 *will be closed from Hwy 101 to SW Ebb Ave and a concrete plaza will be added from Hwy*
21 *101 to the ocean bluff with a raised concrete pedestrian crossing of SW Ebb Ave.*

22
23 Council closed SW 3rd Street during the construction period for the above contract; and

24
25 Staff is proposing a change order to the project to substitute a share street plan for the
26 pedestrian plaza, such that access to and from SW Ebb Avenue will be prohibited; the street
27 will instead accommodate only local traffic from Highway 101. Accordingly, the City
28 Engineer recommends an exercise in parking and traffic control authority by the Council to
29 restrict access to SW 3rd Street from SW Ebb Avenue, to establish Bollards at SW Ebb and
30 3rd to restrict access, to place signage indicated "NOT A THRU STREET" and to clearly mark
31 pedestrian and bicycle walkways and lanes. Motorized vehicle parking is also prohibited in
32 the 3rd Street right-of-way.

33
34 Based on the engineering review, the City Council finds and determines that there exists an
35 engineering and public safety basis for an exercise of municipal traffic control and parking
36 authority, specifically to prohibit access to SW 3rd Street from SW Ebb Avenue, to prohibit
37 parking on SW 3rd Street and restrict access by means of bollards and signage to local
38 vehicular traffic ("NOT A THRU STREET").

39
40 **NOW THEREFORE, BE IT RESOLVED BY THE CITY COUNCIL OF THE CITY OF LINCOLN**
41 **CITY, AS FOLLOWS:**

42
43 **SECTION 1. RECITALS.**
44

1 The above recitals are true and correct and are incorporated herein by this reference.

2
3 **SECTION 2. IMPOSING TRAFFIC CONTROL.**

4
5 After completion of the construction, the SW 3rd Street public street right-of-way as
6 depicted on Exhibit A, will re-open with the following traffic and parking control restrictions:

7
8 The street shall be a shared street providing local business access as well as
9 pedestrian and bicycle access as part of a safe route from the 3rd Street City Parking
10 Lot to the D River wayside.

11
12 Parking is prohibited on the 3rd street right-of-way between Highway 101 and SW Ebb
13 Avenue.

14
15 No right turn and no left turn onto SW 3rd is permitted from SW Ebb Avenue.

16
17 **SECTION 4. POSTING OF SIGNAGE & NOTICE TO ENFORCEMENT OFFICERS.**

18
19 The Public Works Department is directed to erect appropriate signs and traffic control
20 bollards in the appropriate locations to both prohibit access from SW Ebb Avenue and to
21 delineate the area as a shared street with "NO THRU STREET" or "NO THRU ACCESS." No
22 Parking signs shall also be placed in appropriate locations. City police and code enforcement
23 officers are to be advised of the new traffic control and parking restrictions by City
24 Administration.

25
26 **SECTION 4. EFFECTIVE DATE.** This Resolution is effective as of the date of its adoption.

27
28 **PASSED AND APPROVED** by the City Council of the City of Lincoln City, Oregon, this 27th
29 day of March, 2023.

30
31 
32 _____
33 SUSAN WAHLKE, MAYOR

34
35 ATTEST:

36
37 
38 _____
39 JAMIE YOUNG, CITY RECORDER

40
41 APPROVED AS TO FORM:

42
43 
44 _____
45 RICHARD APPICELLO, CITY ATTORNEY

16011 SW 3RD & HWY 101 BEACON

CALL BEFORE YOU DIG!
1-800-332-2344



ATTENTION:
OREGON LAW REQUIRES YOU TO FOLLOW RULES ADOPTED BY THE OREGON UTILITY NOTIFICATION CENTER. THOSE RULES ARE SET FORTH IN OUR 800-332-2344 THROUGH OUR 800-861-0500. YOU MAY OBTAIN COPIES OF THE RULES BY CALLING THE CENTER. (NOTE: THE TELEPHONE NUMBER FOR THE OREGON UTILITY NOTIFICATION CENTER IS 503-332-1800.)

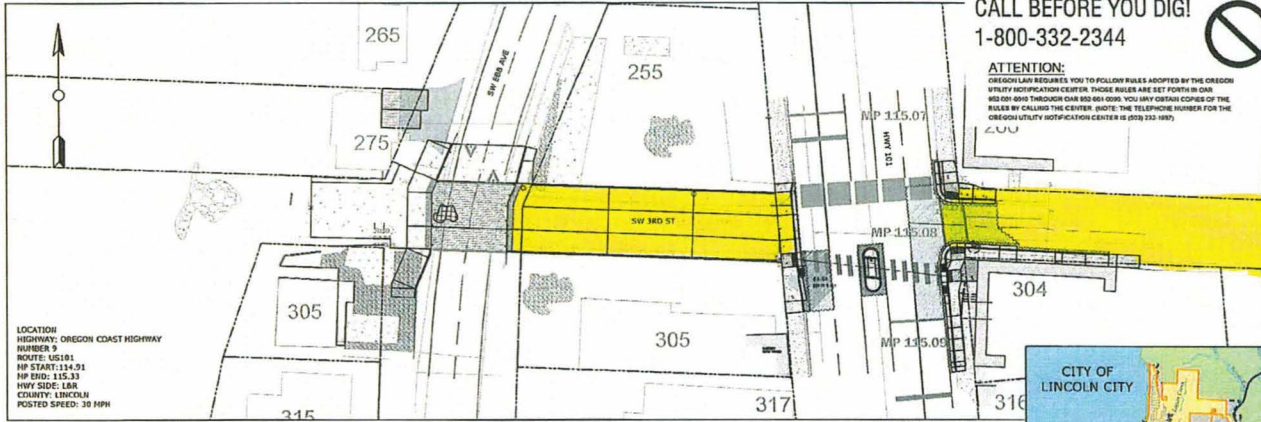

LOCATION:
HIGHWAY: OREGON COAST HIGHWAY
NUMBER: 9
ROUTE: US101
HP START: 114.91
HP END: 115.33
HWY SIDE: LHM
COUNTY: LINCOLN
POSTED SPEED: 35 MPH

GENERAL NOTES:

- CONTRACTOR SHALL PROVIDE ALL APPLICABLE PUBLIC AND PRIVATE CONSTRUCTION NOTIFICATION.
- CONTRACTOR IS RESPONSIBLE FOR MAINTAINING A CURRENT SET OF PLANS, SPECIFICATIONS AND SPECIAL PROVISIONS ON SITE AT ALL TIMES. CONTRACTOR IS REQUIRED TO RECORD ANY CONSTRUCTION DEVIATIONS TO THESE DRAWINGS AND NOTE THE LOCATION AND ELEVATION OF ALL EXISTING UTILITIES ENCOUNTERED.
- LOCATIONS AND DESCRIPTIONS OF ALL EXISTING UTILITIES OR OTHER OBSTRUCTIONS SHOWN IN THE PROJECT PLANS ARE COMPILED FROM AVAILABLE RECORDS AND/OR FIELD SURVEYS. ACCURACY AND COMPLETENESS ARE NOT GUARANTEED. CONTRACTOR SHALL FIELD-VERIFY ALL UTILITY LOCATIONS PRIOR TO CONSTRUCTION.
- CONTRACTOR SHALL BE RESPONSIBLE FOR ANY DAMAGE THAT OCCURS TO ASPHALT PAVEMENT, CONCRETE PAVEMENT, CONCRETE STRUCTURES, BUILDINGS, VALVE AND/OR METER BOXES, SIGNS, ETC. DUE TO CONSTRUCTION ACTIVITIES.
- NO OPEN EXCAVATION TO BE LEFT DURING CONSTRUCTION OFF HOURS. ALL OPEN CUTS OF EXISTING STREETS AND DRIVEWAYS TO BE BACKFILLED TO GRADE, PATCHED WITH A HOT OR COLD AC MIX, OR COVERED WITH A STEEL PLATE.
- PRIOR TO BEGINNING WORK, THE EROSION CONTROL PLAN MUST BE APPROVED BY THE CITY. EFFECTIVE EROSION CONTROL IS REQUIRED. EROSION CONTROL DEVICES MUST BE INSTALLED AND MAINTAINED MEETING CITY AND D.E.G. REQUIREMENTS.
- CONSTRUCTION WILL RUN ADJACENT TO PRIVATE RESIDENCES, COMMERCIAL BUSINESS, AND PUBLIC FACILITIES. RESIDENTS AND BUSINESSSES SHALL BE AFFORDED REASONABLE ACCESS TO THEIR PROPERTIES AT ALL TIMES DURING CONSTRUCTION.
- CONTRACTOR IS RESPONSIBLE FOR PROTECTING ALL EXISTING SURVEY MONUMENTATION. MONUMENTS DISTURBED OR DESTROYED BY CONSTRUCTION ACTIVITIES SHALL BE RESET AT NO COST TO THE CITY BY A PROFESSIONAL LAND SURVEYOR CURRENTLY REGISTERED IN THE STATE OF OREGON.
- PROJECT CONTROL POINTS ESTABLISHED WITH NAVD 88.
- CONTRACTOR SHALL IMPLEMENT TEMPORARY SEDIMENT AND EROSION CONTROL. SEE ODOT STD. DWG. RD1000, RD1010, & RD1015 FOR DETAILS.

TRAFFIC MANAGEMENT NOTES:

- WHEN ACCESS TO SE 3RD STREET IS BLOCKED, CONTRACTOR IS TO PROVIDE SIGNAGE THAT DIRECTS TRAFFIC TO AN ALTERNATE ROUTE VIA SE 9TH STREET AND VICE VERSA. SIGNAGE TO BE PLACED A REASONABLE DISTANCE FOR SOUTHBOUND AND NORTHBOUND TRAFFIC. TEMPORARY LOCAL TRAFFIC ONLY TO BE ALLOWED WESTBOUND TRAVEL ON SE

3RD ST. NOTICE SHALL BE GIVEN FOR EFFECTED RESIDENTS VIA MAILINGS AND DOOR HANGERS 96 HOURS IN ADVANCE OF THE CLOSURE. CITY WILL PROVIDE MAILING LIST. CONSULT WITH CITY FOR SCHEDULING CLOSURES AND MAILINGS.

- WHEN CONSTRUCTION ACTIVITIES BLOCK OR INTERFERE WITH NORMAL PEDESTRIAN ROUTING, PROVIDE SAFE PASSAGE FOR PEDESTRIANS EITHER THROUGH THE CONSTRUCTION, OR ROUTED AROUND THE CONSTRUCTION UTILISING TP&R PLAN (SHEET 17) ODOT STANDARD DRAWING TM844 AND THE REQUIREMENTS OF THE 2021 OREGON STANDARD SPECIFICATIONS FOR CONSTRUCTION (BROWN BOOK), PAGE 141, SUBSECTION 0220.02, 8TH BULLETED ITEM WITH REFERENCE TO THE SUBSEQUENT BULLETED ITEMS.
- WHEN CONSTRUCTION ACTIVITIES BLOCK OR INTERFERE WITH NORMAL OPEN STATE HIGHWAY SHOULDER CONDITIONS, AND THESE IMPACTS LAST LONGER THAN 72 HOURS, FOLLOW THE TEMPORARY SIGNING AND DELINEATION REQUIREMENTS OF ODOT STANDARD DRAWINGS TM800, TM843 (RIGHT LANE CLOSURE - OMIT TAPER "L" FOR SHOULDER CLOSURE) AND TM851 (SHOULDER CLOSURE) CONFIGURATION.
- ANY ABRUPT EDGE GREATER THAN 2 INCHES IN DEPTH, CLOSER THAN 4 FEET FROM AN ACTIVE TRAFFIC LANE, AND HAVING A DURATION LONGER THAN 72 HOURS, SHALL BE REQUIRED TO FOLLOW THE "TYPICAL ABRUPT EDGES SIGNING DETAIL" ON ODOT STANDARD DRAWING TM800.
- WHEN CONSTRUCTION ACTIVITIES BLOCK OR INTERFERE WITH SHOULDERS OR BIKE LANES, INSTALL A 48 INCH "BICYCLES ON ROADWAY" SIGN IN ADVANCE OF EACH SHOULDER OR BIKE LANE CLOSURE AT SIGN SPACING "X" FROM THE "TCD SPACING TABLE" SHOWN ON ODOT STANDARD DRAWING TM800.

ODOT REQUIREMENTS:

- Any utility permits necessary for the development of this project, within the ODOT right of way, will require an Application and Permit to Occupy or Perform Operations upon a State Highway. Contact District 4 Permit Staff with questions at 541-757-4211.
- No advertising in the ODOT right of way.
- Any work affecting a lane of travel will need to be done between 9 hours of 7:00pm and 6:00am. Daytime closures may be considered in multi-lane sections from October 1st to March 1st.
- Any area of cut or damaged asphalt within the ODOT right of way shall be restored by the applicant. Pavement restoration requirements will be included in the permit.
- The applicant needs to abide by all state, local and federal laws with regard to environmental resources. This includes work performed on ODOT right of way associated with the proposed access, plus any additional work that is required to perform as mitigation for the development. The applicant is responsible for obtaining all necessary permits, other than for state Highway access, from the proper regulatory agency.

Restricted per Resolution 2023-05

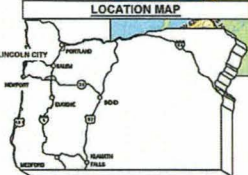

General Notes

OWNER: LINCOLN CITY
CITY OF LINCOLN CITY
843 BRANFLOREN 201
PO BOX 63
LINCOLN CITY, OREGON 97137

CONTACT: TERRY CHAMBERLIN, P.E.
PHONE: 541.986.1283

No.	Revisions	Date

LINCOLN CITY PUBLIC WORKS
 300 3RD ST
 LINCOLN CITY, OREGON 97137
 PHONE: 541.986.1283
 FAX: 541.986.1284

Name and Location:
 SW 3RD & HWY 101 BEACON
 COVER

DESIGNED BY: TC
 PREPARED BY: DP

Project No: 16011
 Date: 3/31/2022
 Scale: 1" = 20'
 Sheet No: 1 of 35

L:\2019-019.06\4-Design\DWG
 3/31/2022
 A. BONHAM