

New Community Park in Lincoln City • *Nuevo Parque Comunitario en Lincoln City*

Inspiration • *Inspiración*



Image courtesy of North Lincoln County Historical Society 1920s

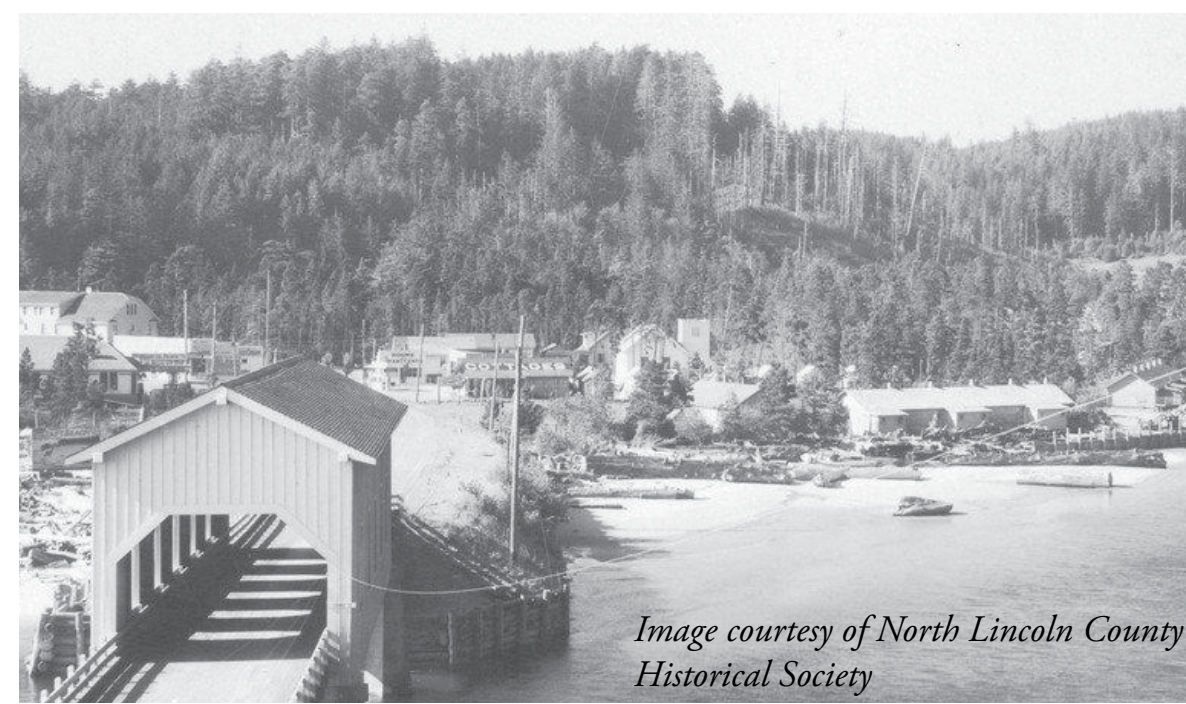

Image courtesy of North Lincoln County Historical Society



Siletz Indians pose on Nye Beach. The ocean, tidelands and forests sustained rich tribal cultures all along the Oregon Coast before white settlement. (Photo and Caption provided by the Lincoln County Historical Society)



Image courtesy of North Lincoln County Historical Society 1930s

The Park Design Concept celebrates the social history of the site as an important gathering space for people throughout time and the historic ecology of the site as a coastal estuary and forested wetland.

El Concepto del Diseño del Parque celebra la historia social de el sitio como un espacio importante de reuniones para la gente a través del tiempo y la historia ecológica del sitio como un estuario costero y humedal boscoso.

Concept • *Concepto*

The concept brings the creative, active qualities of Lincoln City into a park that is composed of large native planting areas inspired by the adjacent forested wetlands and coastal estuaries. This creates a lively, engaging park experience with active amenities nestled in the native landscape. Park pathways are like village sidewalks that move through the native landscape and support gathering and activities within the park. A paved promenade that hosts everyday gathering connects the park to Schooner Creek. A north/south pathway connects to a loop trail around the multi-use field and hosts multiple opportunities for gathering and activities along its edges. The flexible event lawn, surrounded by native landscape, provides space for everyday recreation and large community events.

Este concepto une las cualidades creativas y activas de Lincoln City en un parque compuesto de grandes áreas de plantaciones nativas inspiradas por los humedales boscosos y estuarios adyacentes. Esto crea una experiencia de parque animada y atractiva con servicios activos ubicados en el paisaje nativo. Los caminos del parque son como aceras del pueblo que se mueven a través del paisaje nativo y promueven reuniones y actividades dentro del parque. Un paseo peatonal pavimentado que proporciona reuniones diarias conecta al parque con Schooner Creek. Un camino que corre hacia el nortel sur se conecta con un camino en bucle y una cancha de multiusos que proporciona múltiples oportunidades para reuniones y actividades a lo largo de sus orillas. La cancha de eventos flexible, rodeada de un paisaje nativo, proporciona espacio para recreación diaria y un espacio para eventos comunitarios grandes.

Park Character and Activities • *Caracter y Actividades del Parque*



We want to hear from you! Take the Survey

Inclusive Playground at the New Community Park in Lincoln City



Overall Park Design



Legend • Simbología

- ① Multi-Sport Field • *Campos Deportivos Multi-usos*
- ② Pickle Ball Courts • *Canchas para Pickleball*
- ③ Covered Multi-sport Court • *Canchas Cubiertas Deportivas Multi-usos*
- ④ Inclusive Play Area • *Area de Juegos Inclusiva*
- ⑤ Restroom / Storage Building • *Baños/ Edificio para Almacenamiento*
- ⑥ Picnic Shelter / Performance Stage • *Area de Picnic Cubierta/ Escenario*
- ⑦ Flexible Lawn • *Campo Flexible*
- ⑧ Paved Promenade • *Paseo Pavimentado*
- ⑨ Covered Picnic Area • *Area de Picnic Cubierta*
- ⑩ Paved Trails • *Senderos Pavimentados*
- ⑪ Soft Surface Trail • *Sendero de superficie blanda*
- ⑫ On-Street Parking • *estacionamiento el la calle*
- ⑬ Pedestrian Crossing • *Cruce peatonal*
- ⑭ Entry Plaza • *Plaza de entrada*



We want to hear from you!
Take the Survey

Inclusive Playground at the New Community Park in Lincoln City



Overall Park Design

The Promenade and Picnic Shelters



Loop Trail/Sports Courts



The Community Lawn and Bandstand

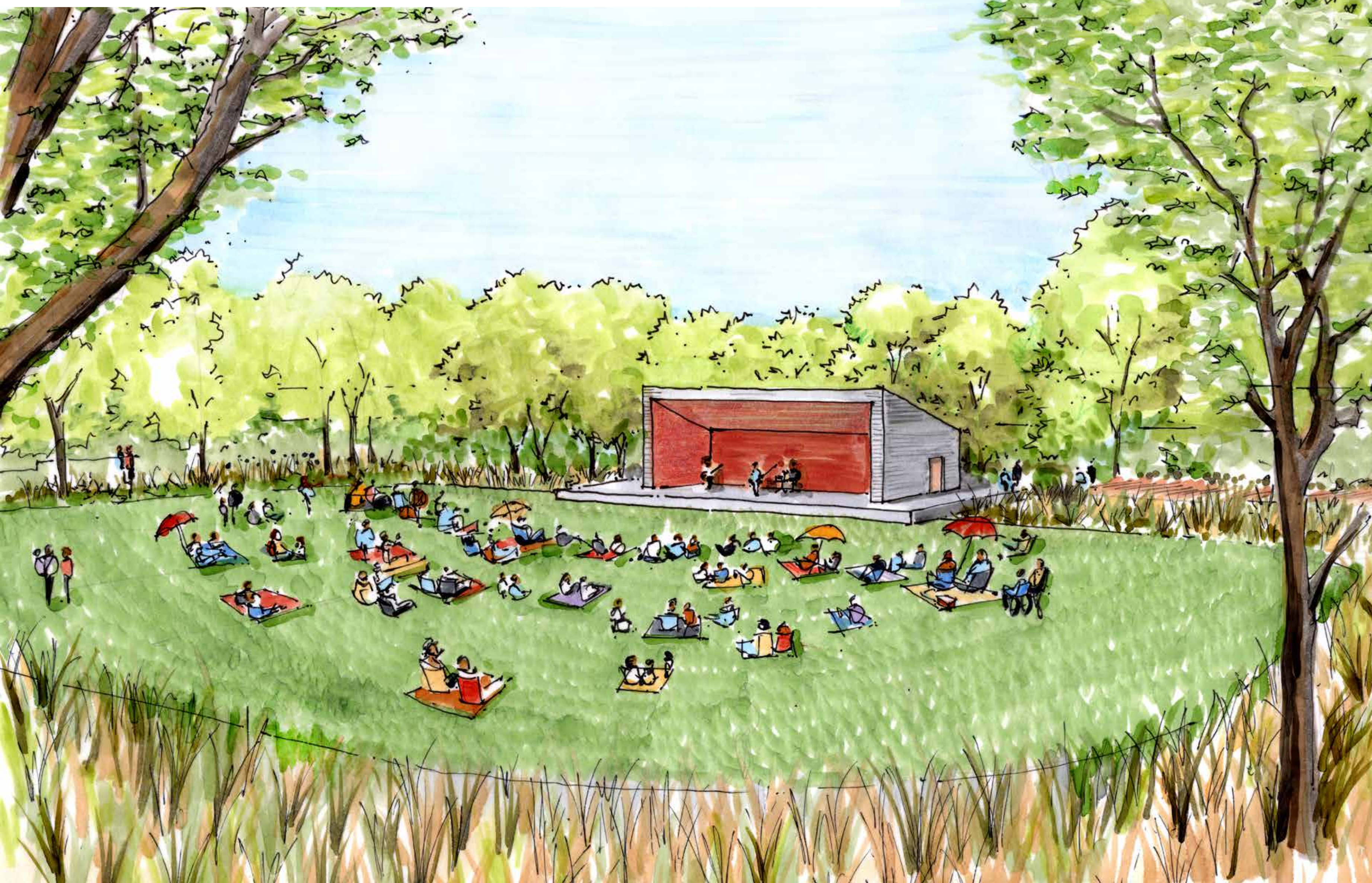

All Illustrations by Nicolai Kruger Studio

 We want to hear from you! Take the Survey

Inclusive Playground at the New Community Park in Lincoln City



What is an Inclusive Playground?

An Inclusive Playground provides opportunities for people of all abilities to play together and find challenges at their own level, including people who have autism, intellectual disabilities, hearing impairments, cerebral palsy, spina bifida and other disabilities. It also addresses the needs of able-bodied children.

While all inclusive playgrounds are also accessible to people with physical disabilities, not all accessible playgrounds can be considered inclusive playgrounds. An accessible playground does not always create the optimal space for disabled and able-bodied children to play and interact with each other. Inclusive playgrounds go above and beyond the minimum standards of accessibility to promote a truly inclusive experience so every child at the playground can feel like they belong.^{1}

- Key Features of Inclusive Playgrounds:** ^{1}
1. Unified accessible surface materials
 2. Clear Maneuverable Routes
 3. Clear Playground Edges and Play Zones
 4. Social Play Spaces and Social Play Equipment
 5. Calm Areas
 6. Sensory Components that engage all the senses
 7. Various Levels of Challenge

^{1} Source: <https://playworld.com/blog/inclusive-playgrounds-vs-accessible-playgrounds/#gref>

Traditional Playgrounds and Accessibility:

Exclusion

Many traditional playgrounds exclude people who use wheelchairs or mobility devices, even when complying with Americans with Disabilities Act (1990) guidelines.

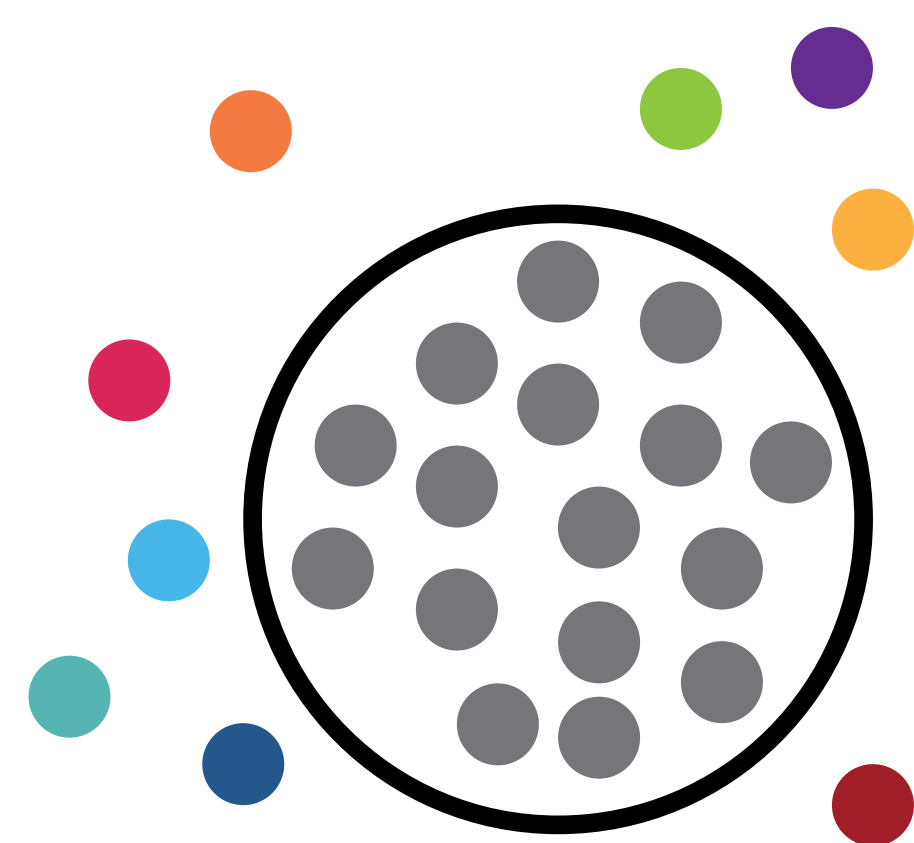

The mulch surface on this playground is considered accessible but excludes people with physical disabilities.

Segregation

Sometimes playgrounds have special equipment for people who use wheelchairs but the equipment is isolated from other play areas.

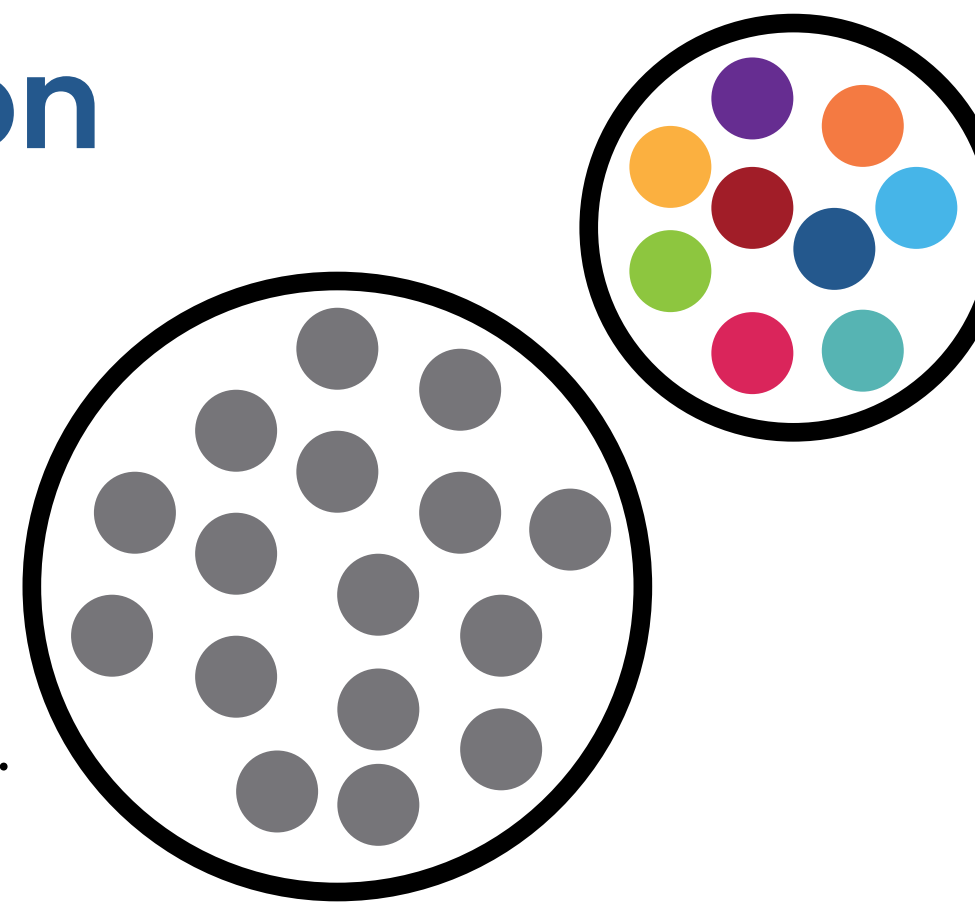

This is an example of a playground that segregates equipment designed for physical disabilities away from other types of equipment.

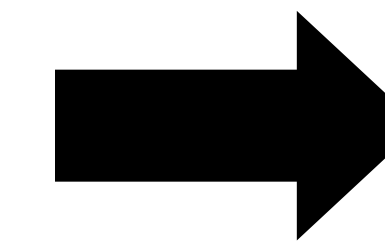

Inclusive Playground

Inclusion

Inclusive playgrounds expand upon accessibility by creating an environment that encourages kids of all abilities to interact with the playground equipment and play together.

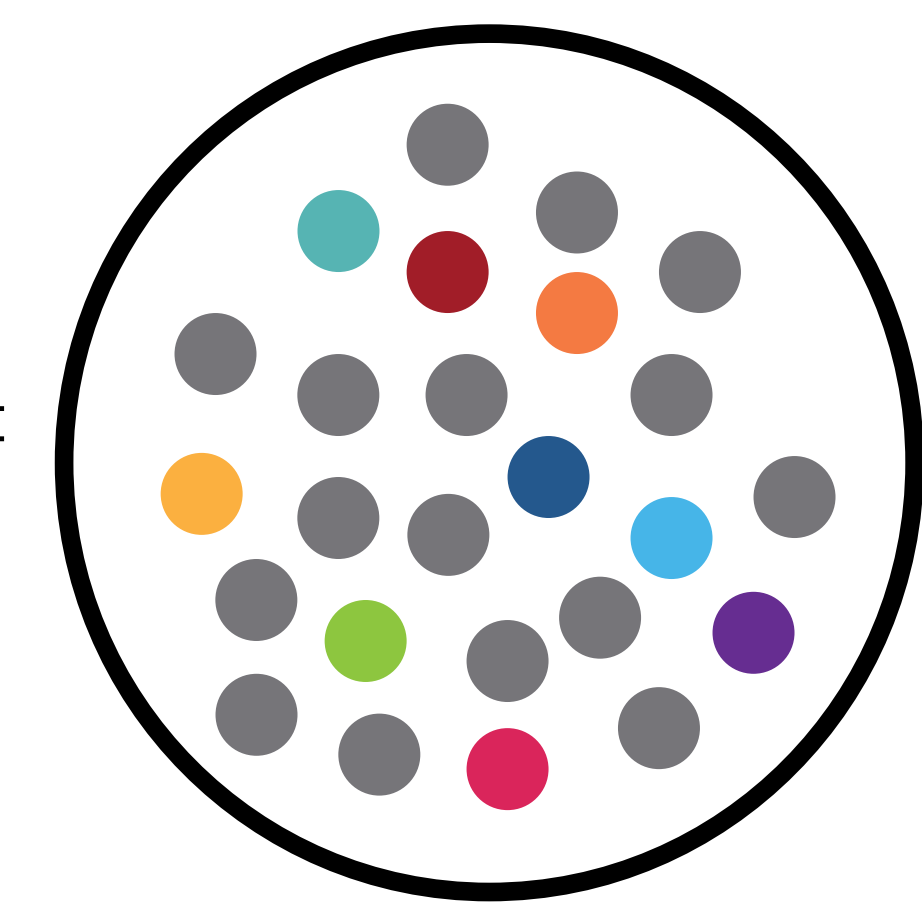

This is an example of a playground that has different levels of challenge right next to each other so kids of different abilities can play together.

Examples of Inclusive Play Features:



Example of an inclusive carousel that is fun for everyone



Example of a play zone with spinners of different challenge



Example of a 'coolest thing' - A play hill that is accessible to everyone



Example of different types of swings next to each other



Example of calm area for kids who want to take a break



Example of sensory zone with music

Inclusive Playground at the New Community Park in Lincoln City



We want to hear from you! Take the Survey

Playground Concept • Siletz Bay



Goals of Playground Design

- Create an Inclusive Playground for everyone
- Celebrate Natural Beauty of Lincoln City

Design Concept:
 Inspired by the Siletz Bay, the playground features a play hill that is inspired by the sand spit along the Bay. Blue and tan colored surfacing in flowing patterns references the sand and water of the Bay. The play equipment uses wood and rock textures inspired by the natural features of the bay and the Oregon Coast. Native plantings and trees surround the edges of the playground to enclose the playground, engage all the senses, and provide shade.

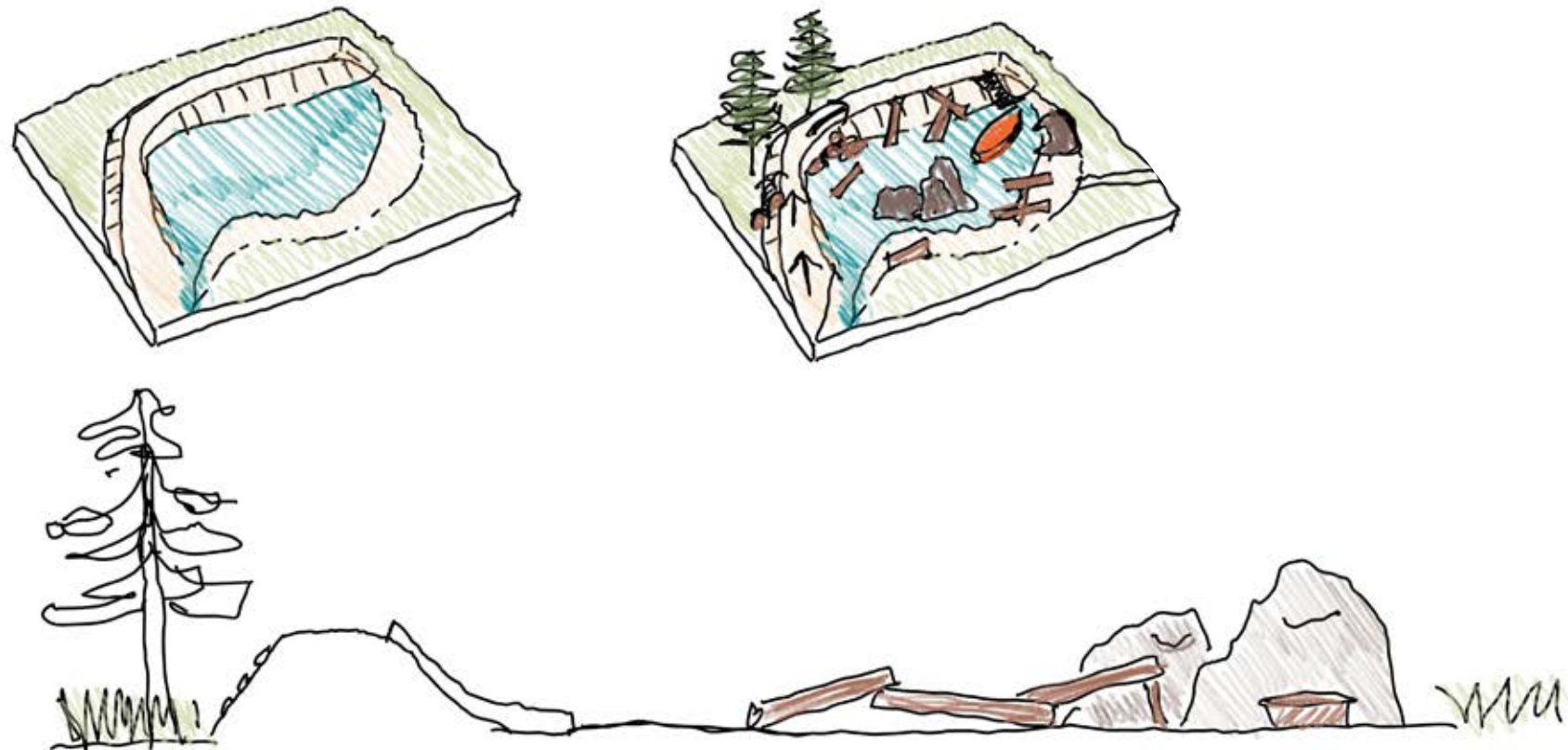

Concept Sketches for the playground with a hill and natural materials inspired by Siletz Bay



Design inspiration images of Siletz Bay

 We want to hear from you!
 Take the Survey

Inclusive Playground at the New Community Park in Lincoln City

Playground Circulation and Seating

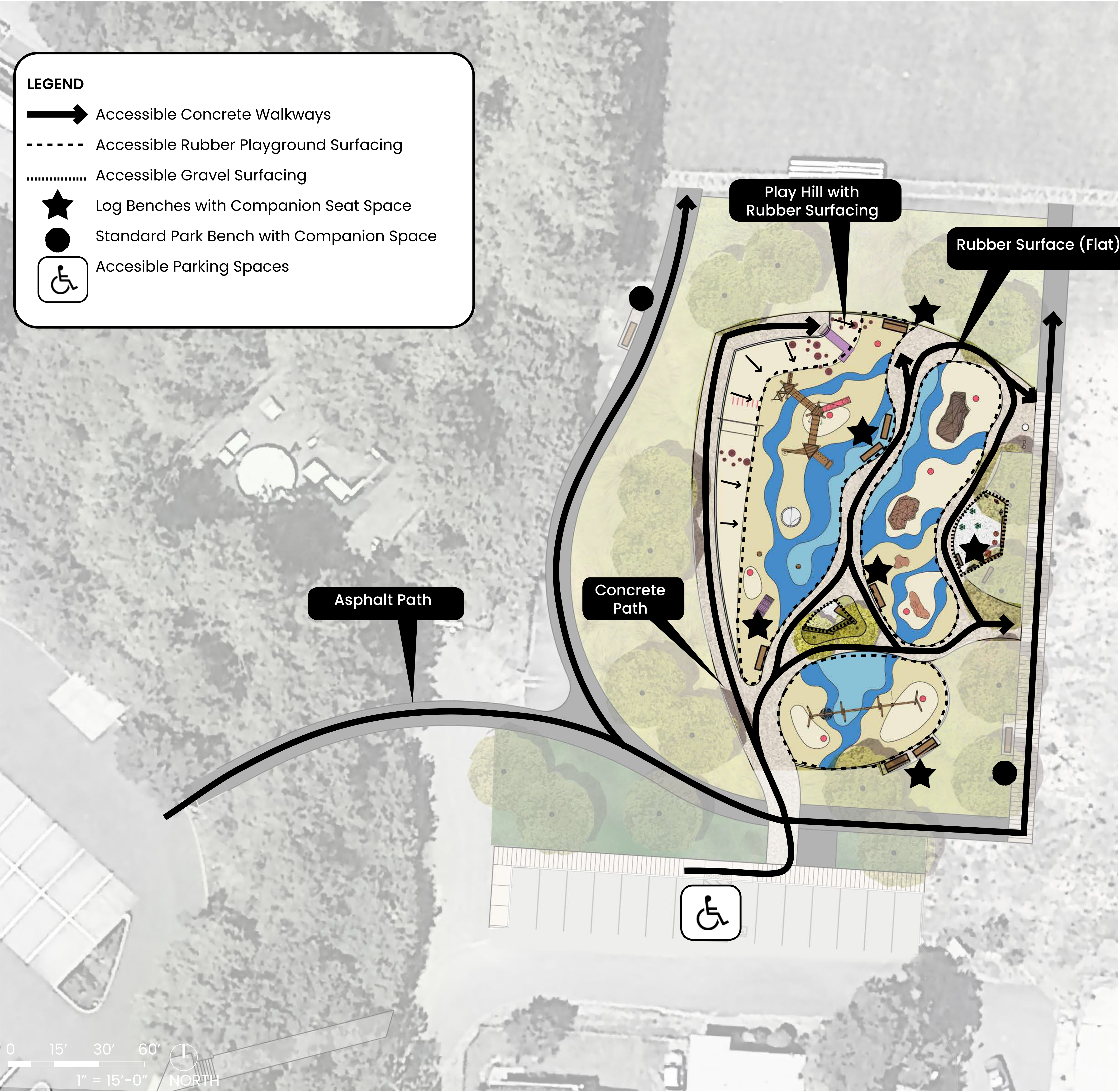

Example of a playground and play hill with rubber surfacing



Example of log benches and accessible compacted gravel surfacing



Example of textured concrete paving inspired by sand for sensory input

Inspired by the glass floats, small 'treasures' of color will occur in the rubber surfacing and walkways.



QR Code: We want to hear from you! Take the Survey

Inclusive Playground at the New Community Park in Lincoln City



View of Overall Playground

Key Plan:

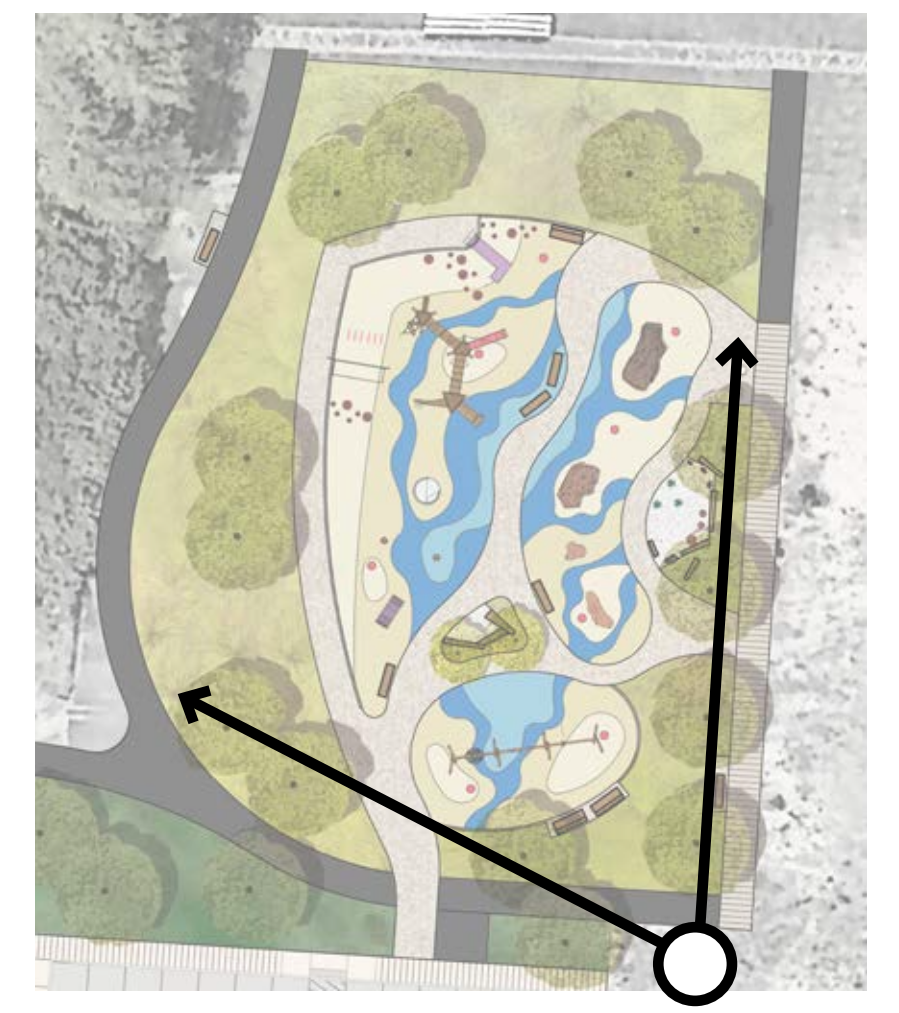

We want to hear from you!
Take the Survey

Inclusive Playground at the New Community Park in Lincoln City



Active Play Zones- Climbing, Sliding, Balancing



LEGEND

- | | |
|---|--|
| ① Play Hill with Rubber Surfacing (All Ages) | ⑦ Tall Climbing Rock (11' height, 5+ years) |
| ② Hill Slide with Dignity Landing (Ages 5-12) | ⑧ Medium Climbing Rock (10' height, 5+ years) |
| ③ Log Tangle Climber (Ages 5-12) | ⑨ Small Climbing Rock (3.25' height, 2+ years) |
| ④ Hill Climbing Domes (Ages 2+) | ⑩ Small Climbing Rock (3' height, 2+ years) |
| ⑤ Hill Climbing Ropes (Ages 2-12) | |
| ⑥ Hill Climbing Rings (Ages 5+) | |

Play Hill



Inclusive Features:

- Has a fully accessible path to the top of it (Hill is 5' high)
- Includes an accessible slide with a dignity landing
- Rubber spheres, half-spheres, climbing rope, and hoops provide opportunity for creative social play and physical challenge on the hillside

Log Tangle Climber



Inclusive Features:

- Transfer station at base with accessible belt climbers to access higher levels
- Wood texture provides sensory input
- Opportunities for social play at different levels

Climbing Rocks



Inclusive Features:

- 4 rocks of different heights to provide challenge to all ages and abilities
- Colorful hand holds provide a comfortable entry into climbing
- Anchor points for accessible climbing equipment



We want to hear from you!
Take the Survey

Inclusive Playground at the New Community Park in Lincoln City



Swinging and Spinning Zones



LEGEND

- 1 One Inclusive In-Ground Carousel Spinner (Ages 2-12)
- 2 Two Wood-Top Spinners (Ages 5-12)
- 3 Swing Set with 5 Swings:



One Inclusive Seat
(Ages 5-12)



One Baby Seat
(Ages 1+)



One Rope Nest
(Ages 2+, 7 users)



Two Swing Seats
(Ages 2+)

Swings



Inclusive Features:

- Rope Nest Swing- An inclusive swing that builds social skills
- Multiple swing types with different levels of challenge next to each other
- Wood frame provides sensory input

Spinners



Inclusive Features:

- Spinners with varying levels of challenge are grouped together
- In-ground carousel is flush with surfacing and fun for all
- Two wood -topped spinners provide additional challenge and are located right next to the in-ground carousel



We want to hear from you!
Take the Survey

Inclusive Playground at the New Community Park in Lincoln City



South Playground- Swinging and Cozy Zone

Key Plan:



We want to hear from you!
Take the Survey

Inclusive Playground at the New Community Park in Lincoln City



Cozy Zone and Music Zone- Quiet Spaces, Imaginative Play, Engaging the Senses



LEGEND

- ① Cozy Spot with Wood Dome (Ages 2-5)
- ② Quiet Log Garden (All Ages)
- ③ Music 'Forest' Garden (All Ages)

**Musical instruments will be generously donated by Christmas Cottage*



Native planting around the playground edge and Quiet Log Garden provides enclosure and adds sensory interest with textures, colors and smells

Cozy Spots

Wood Dome Cozy Spot



Log Garden Cozy Spot



Inclusive Features:

- Two quiet spaces provide places for people who need a break
- The log quiet space is surrounded by planting for sensory input
- The Wood Dome is a cozy covered fort-like space to get away

Music Garden

Flower Chimes



Tree Chimes



Mushroom Gongs



Serenade



Inclusive Features:

- Music develops social skills and engages the senses
- All instruments are accessible

 We want to hear from you! Take the Survey

We want to hear from you!

Scan the QR Code below to
Take the Survey



We want to
hear from you!
Take the Survey

Inclusive Playground at the New Community Park in Lincoln City

