



1815 NW 169th Place, Suite 2090
Beaverton, OR 97006
Telephone: 503-848-2127

Original Tax Lot 2900 Description

July 19, 2024

NWS Project Number 2261

Lot 5 in Block 11 of "Third Addition to City of Taft", located in the southeast one-quarter of Section 27, Township 7 South, Range 11 West, Willamette Meridian, City of Lincoln City, Lincoln County, Oregon.

The above described tract contains 5,003 square feet, more or less.

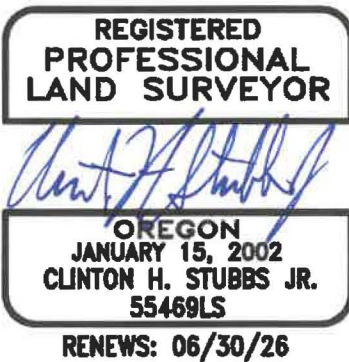



1815 NW 169th Place, Suite 2090
Beaverton, OR 97006
Telephone: 503-848-2127

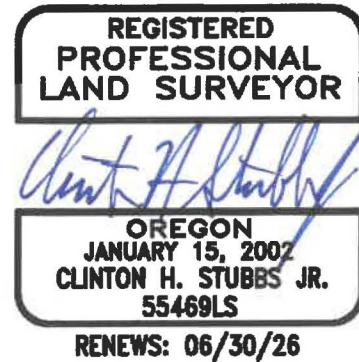

Tract 1 Description

July 18, 2024

NWS Project Number 2261

A tract of land being a portion of Lot 5 and a portion of Lot 6, Block 11 of "Third Addition to City of Taft", located in the southeast one-quarter of Section 27, Township 7 South, Range 11 West, Willamette Meridian, City of Lincoln City, Lincoln County, Oregon, and being more particularly described as follows:

Beginning at a 5/8-inch iron rod with a yellow plastic cap stamped "Northwest Surveying Inc" located at the northwest corner of said Lot 5, said point located on the southerly right-of-way line of SW 48th Street (25.00 feet southerly from the centerline thereof, when measured at right angles); Thence along the southerly right-of-way line of said SW 48th Street, North 86°50'38" East 100.00 feet to a 1-1/8 inch copper disk stamped "STUBBS LS55469", said point being the northeast corner of said Lot 6 and being located on the westerly right-of-way line of SW Ebb Avenue (25.00 feet westerly from the centerline thereof, when measured at right angles); Thence along the westerly right-of-way line of said SW Ebb Avenue, South 03°33'10" East 50.05 feet; Thence departing the westerly right-of-way line of said SW Ebb Avenue, South 86°50'19" West 100.00 feet to a point located on the westerly line of said Lot 5; Thence along the westerly line of said Lot 5, North 03°33'10" West 50.06 feet to the Point of Beginning.

The above described tract contains 5,005 square feet, more or less.

The basis of bearings for this description is per County Survey Number 21658, Lincoln County Survey Records.



1815 NW 169th Place, Suite 2090
Beaverton, OR 97006
Telephone: 503-848-2127

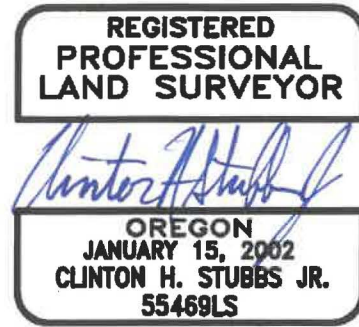

Exchange Area (Lot 6 to Lot 5)

July 18, 2024

NWS Project Number 2261

A tract of land being a portion of Lot 6, Block 11 of “Third Addition to City of Taft”, located in the southeast one-quarter of Section 27, Township 7 South, Range 11 West, Willamette Meridian, City of Lincoln City, Lincoln County, Oregon, and being more particularly described as follows:

Commencing at a 5/8 inch iron rod with a yellow plastic cap stamped “Northwest Surveying Inc” located at the northwest corner of Lot 5 of said Block 11, “Third Addition to City of Taft”, said point located on the southerly right-of-way line of SW 48th Street (25.00 feet southerly from the centerline thereof, when measured at right angles); Thence along the southerly right-of-way line of said SW 48th Street, North 86°50’38” East 50.00 feet to the northwest corner of said Lot 6 being marked by a 5/8 inch iron rod with a yellow plastic cap stamped “Northwest Surveying Inc” and the Point of Beginning.

Thence continuing along the northerly line of said Lot 6 also being the southerly right-of-way line of said SW 48th Street, North 86°50’38” East 50.00 feet to the northeast corner of said Lot 6 located on the westerly right-of-way line of SW Ebb Avenue; Thence along the westerly right-of-way line of said SW Ebb Avenue, South 03°33’10” East 50.05 feet; Thence departing said westerly right-of-way line, South 86°50’19” West 50.00 feet to a point located on the westerly line of said Lot 6; Thence along the westerly line of said Lot 6, North 03°33’10” West 50.05 feet to the Point of Beginning.

The above described tract contains 2,502 square feet, more or less.

The basis of bearings for this description is per County Survey Number 21658, Lincoln County Survey Records.